



jorgensenturner
estate agents



Brondesbury Villas,
Queens Park
£1,898 Per Month



2 1 1 C

Brondesbury Villas, Queens Park

£1,898 Per Month



Summary Description

A superb spacious first floor one/two bedroom flat (586 sq ft / 54 sq m) in a lovely well maintained Victorian conversion on a popular residential tree lined street. The flat comprises one double bedroom with en-suite bathroom, separate guest WC, further second bedroom/study/office room with roof terrace, large reception room with fireplace and a fully equipped integrated kitchen with breakfast bar. Brondesbury Villas is a sought after residential street with Queens Park, Kilburn High Road and Kilburn Park stations moments away. To arrange a viewing please contact Jorgensen Turner estate agents Queens Park NW6 branch.

EPC rating D, council tax band D, one week's holding deposit required, 5 week's damage deposit required.

Area Map

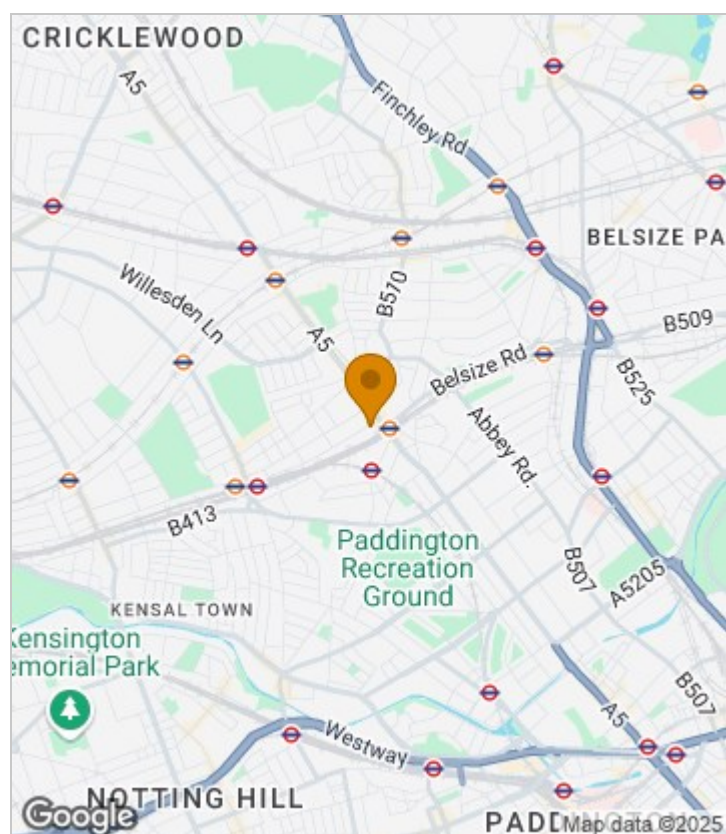

Floor Plan

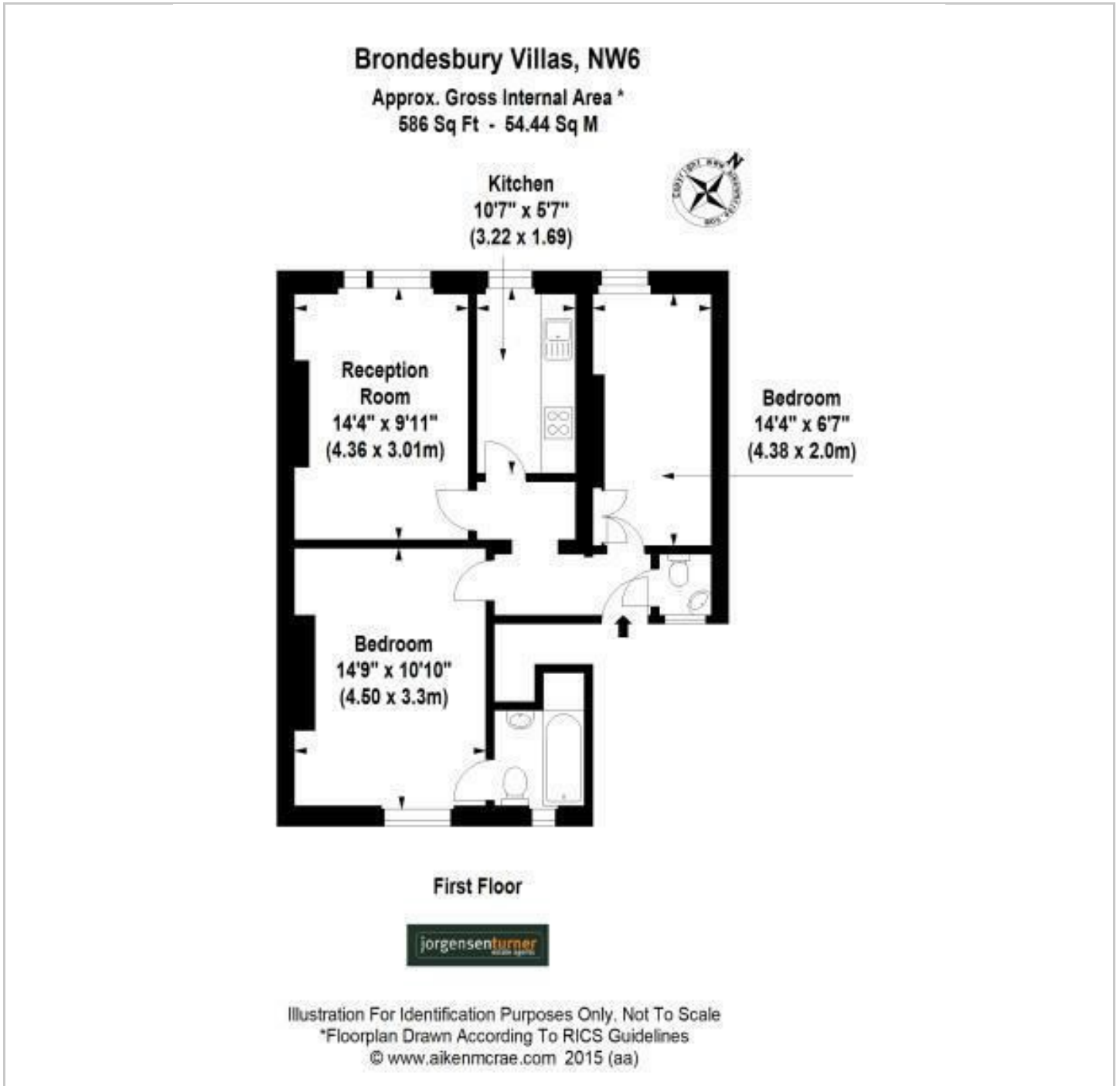

Energy Efficiency Graph

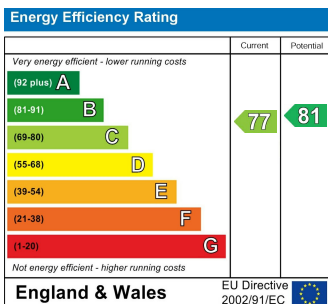

Viewing

Please contact our Lettings QP Office on 0207 604 4040 if you wish to arrange a viewing appointment for this property or require further information.

- Period two bedroom flat
- High ceiling
- Great transport links
- Double glazed windows
- Separate kitchen
- Wooden floor throughout
- Redecorated

For further information contact:

Lettings QP, 2a Brondesbury Road, London, NW6 6AS

Tel: 0207 604 4040 Email: info@jorgensenturner.com <https://www.jorgensenturner.com/>

Disclaimer

These particulars, whilst believed to be accurate are set out as a general outline only for guidance and do not constitute any part of an offer or contract. Intending purchasers should not rely on them as statements of representation of fact, but must satisfy themselves by inspection or otherwise as to their accuracy. No person in this firm's employment has the authority to make or give any representation or warranty in respect of the property.

