



jorgensenturner  
estate agents



Brondesbury Villas,  
Queens Park, London,  
£1,795 Per Month



 1  1  1  D

# Brondesbury Villas, Queens Park, London,

£1,795 Per Month

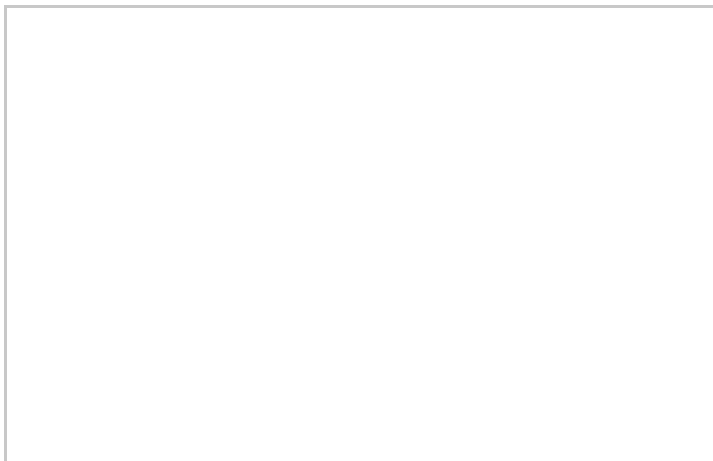

## Summary Description

Jorgensen Turner estate agents Queens Park are pleased to offer this superb huge well balanced one bedroom flat (553 sq ft / 51 sq m) in a lovely Victorian period conversion on a residential tree lined street. The flat comprises one double bedroom with fitted wardrobes, large reception room and a fully equipped integrated kitchen and modern bathroom. Available from 25th of September. Brondesbury Villas is a residential street with Queens Park, Kilburn High Road and Kilburn Park stations moments away. To arrange a viewing please contact Jorgensen Turner estate agents.

One week's holding deposit required, 5 weeks damage deposit required, Council tax band C

## Area Map

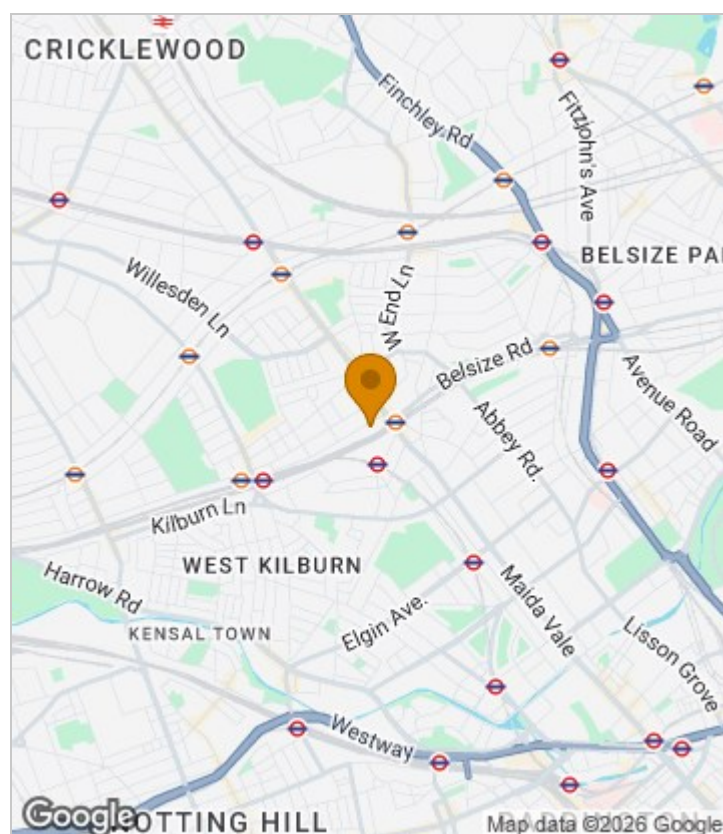



# Floor Plan

## Brondesbury Villas London MW6



Approx. Gross Internal Area = 51.4m square  
= (553ft square)

Plan produced by HP. Source.  
For illustrative purposes only.  
Not to scale.  
Tel-07766340073

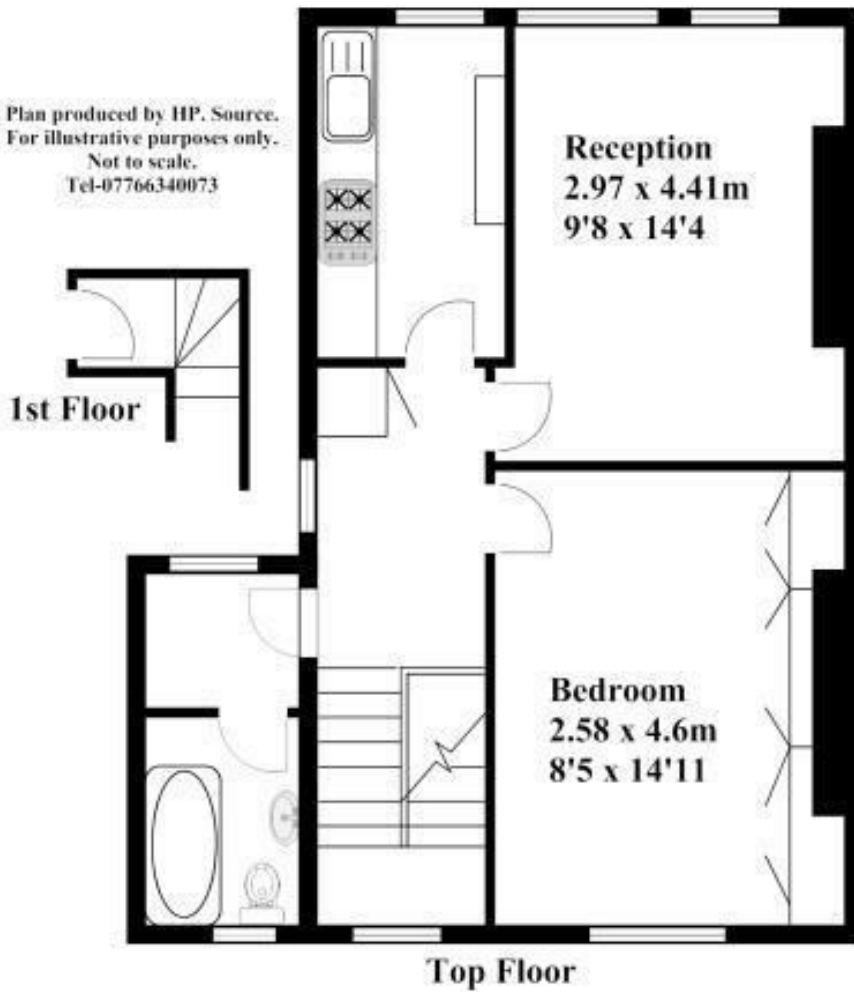

### Energy Efficiency Graph

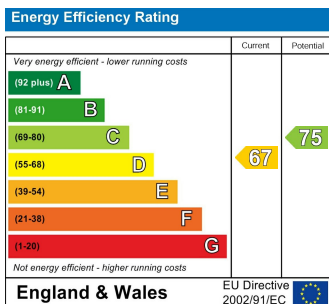

### Viewing

Please contact our Lettings QP Office on 0207 604 4040 if you wish to arrange a viewing appointment for this property or require further information.

For further information contact:

Lettings QP, 2a Brondesbury Road, London, NW6 6AS

Tel: 0207 604 4040 Email: [info@jorgensenturner.com](mailto:info@jorgensenturner.com) <https://www.jorgensenturner.com/>

### Disclaimer

These particulars, whilst believed to be accurate are set out as a general outline only for guidance and do not constitute any part of an offer or contract. Intending purchasers should not rely on them as statements of representation of fact, but must satisfy themselves by inspection or otherwise as to their accuracy. No person in this firm's employment has the authority to make or give any representation or warranty in respect of the property.