



Willesden Lane,
Brondesbury Park

£1,750 Per Month



Willesden Lane, Brondesbury Park

£1,750 Per Month



Summary Description

A very well presented one bedroom flat to rent in a Victorian period conversion in highly sought after location of Brondesbury Park NW6. This apartment has wood flooring throughout and great natural light boasting fully fitted modern finishes. The flat comprises of one bedroom, modern bathroom, separate reception room and modern kitchen. Bedroom comes with fitted wardrobes.

Off street parking via driveway. Available from 19th of November.

EPC rating D, council tax band C, one week's holding deposit required, 5 weeks damage deposit.

To arrange a viewing please call Jorgensen Turner estate agents.

Area Map

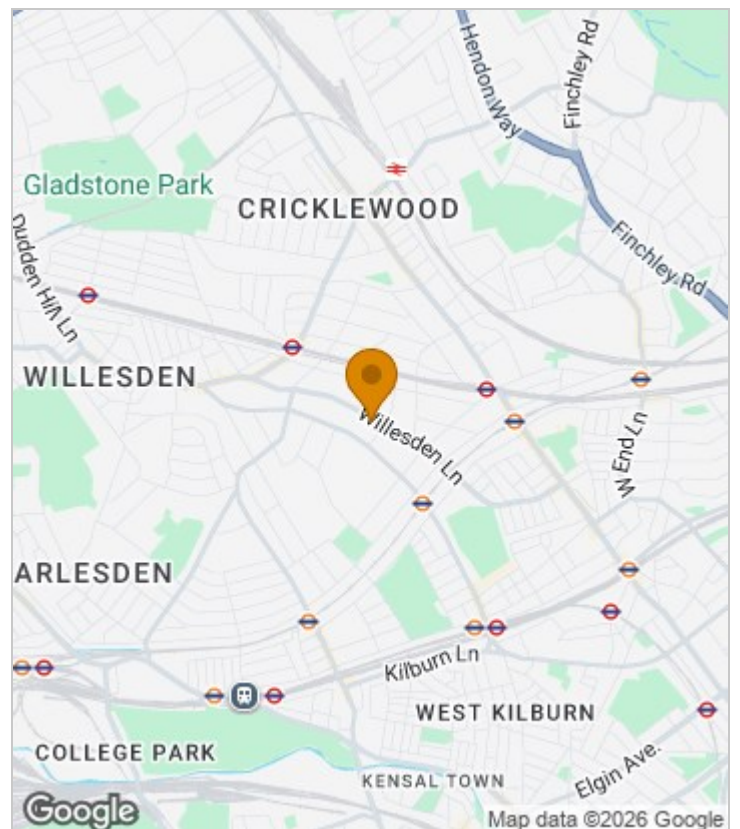

Floor Plan

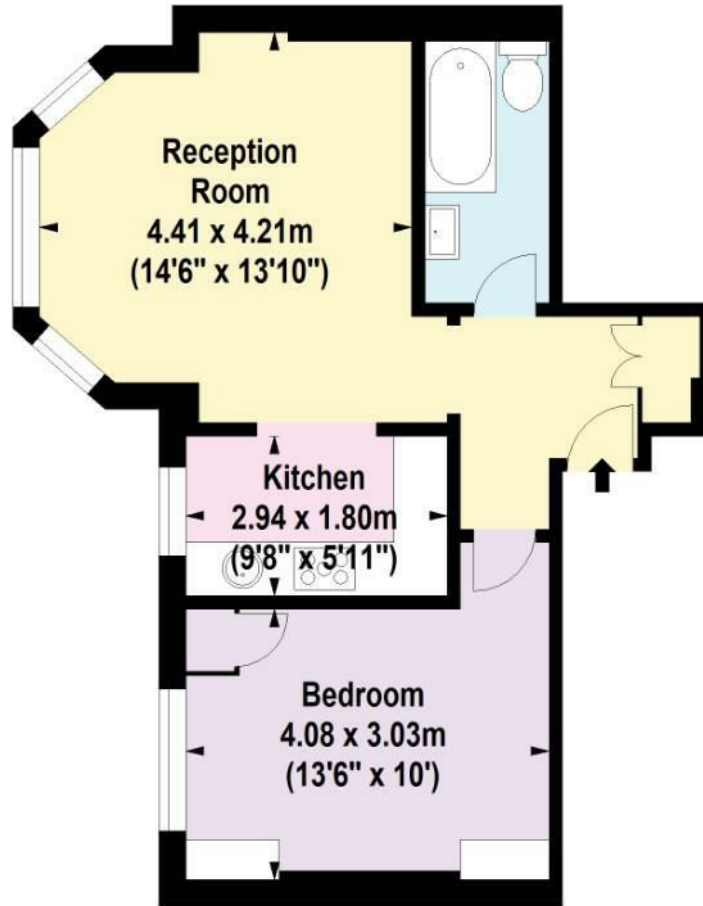

First Floor

For Identification Purposes Only. Not To Scale. © www.totalvista.uk 2024



Willesden Lane, NW6

Approx. Gross Internal Area
46.36 Sq M - 499 Sq Ft



Energy Efficiency Graph

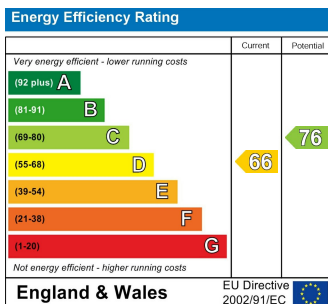

Viewing

Please contact our Lettings QP Office on 0207 604 4040 if you wish to arrange a viewing appointment for this property or require further information.

For further information contact:

Lettings QP, 2a Brondesbury Road, London, NW6 6AS

Tel: 0207 604 4040 Email: info@jorgensenturner.com <https://www.jorgensenturner.com/>

Disclaimer

These particulars, whilst believed to be accurate are set out as a general outline only for guidance and do not constitute any part of an offer or contract. Intending purchasers should not rely on them as statements of representation of fact, but must satisfy themselves by inspection or otherwise as to their accuracy. No person in this firm's employment has the authority to make or give any representation or warranty in respect of the property.