





Douglas Road, Queens  
Park

£2,250 Per Month



 2  1  1  C

# Douglas Road, Queens Park

£2,250 Per Month



## Summary Description

A gorgeous two double bedroom ground floor garden flat in a wonderfully quiet yet convenient location available from 15th of February. The property benefits from a smart kitchen and modern bathroom, double glazed windows. Other features are private looked after garden, wooden floor throughout, high ceiling, neutral décor.

The flat is superbly positioned for everything which the chic Salusbury Road has to offer yet is also well positioned within easy reach of the Kilburn Jubilee Line as well as the Bakerloo line tube and the London Overground. To arrange viewing please call Jorgensen Turner estate agents. Holding deposit required will be 1 week's rent, damage deposit 5 weeks, council tax band D.

## Area Map

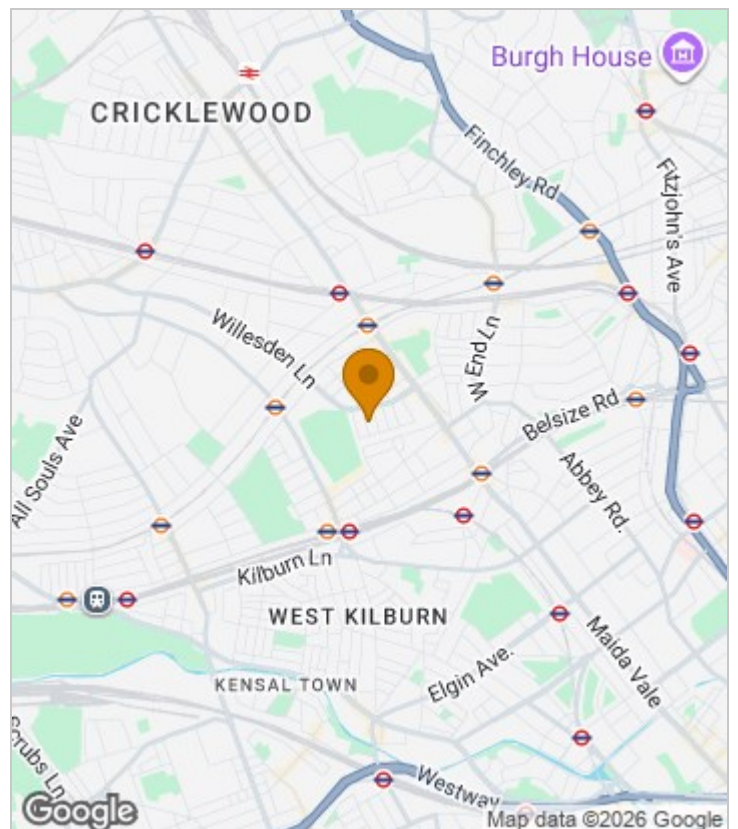



# Floor Plan

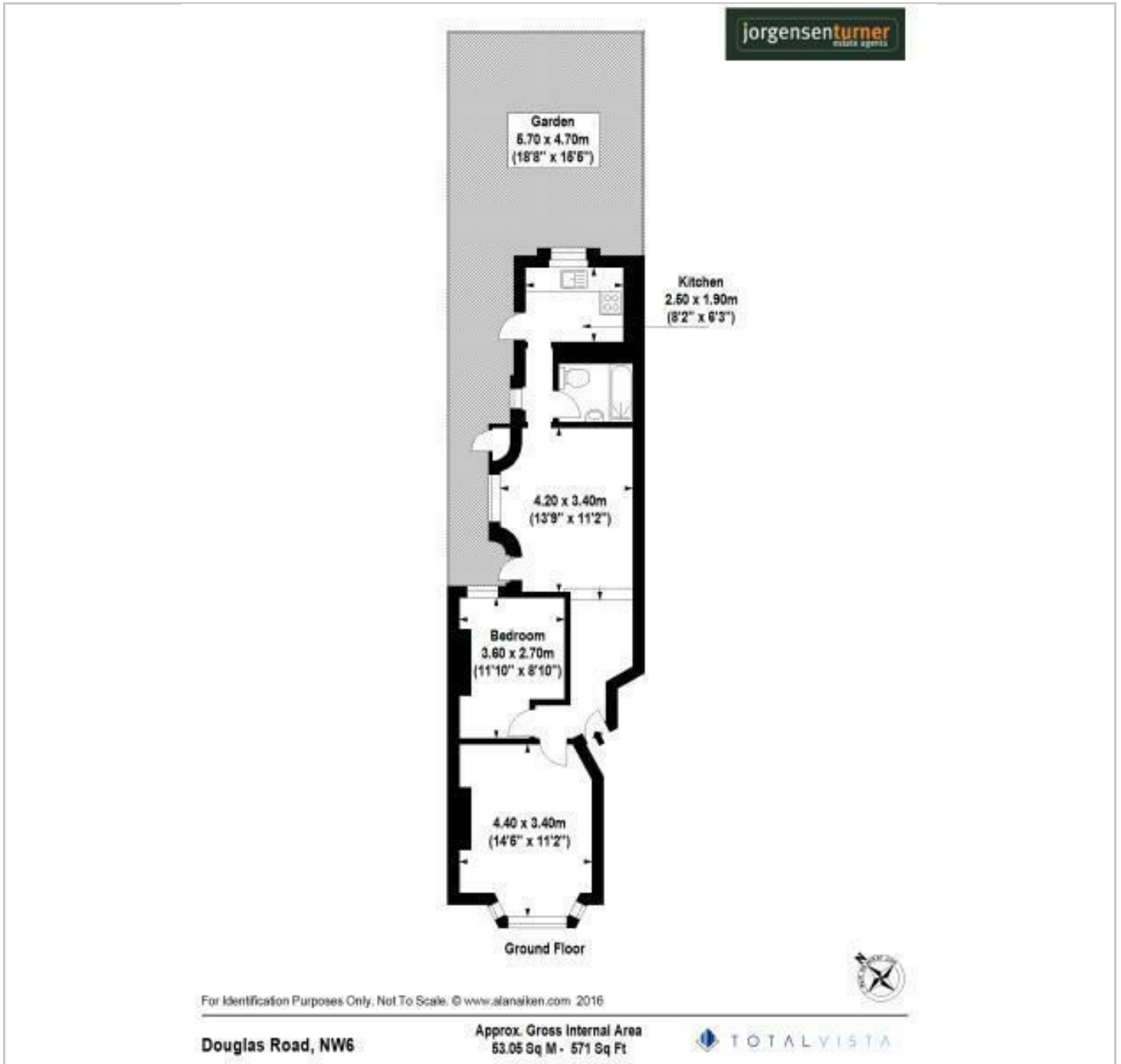

## Energy Efficiency Graph

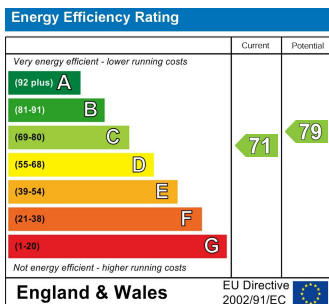

## Viewing

Please contact our Lettings QP Office on 0207 604 4040 if you wish to arrange a viewing appointment for this property or require further information.

- Two Double Bedrooms
- High Ceilings
- Garden
- Close to Bakerloo Line
- Ground Floor Flat
- Wooden Floors
- Double glazed windows

For further information contact:

Lettings QP, 2a Brondesbury Road, London, NW6 6AS

Tel: 0207 604 4040 Email: [info@jorgensenturner.com](mailto:info@jorgensenturner.com) <https://www.jorgensenturner.com/>

## Disclaimer

These particulars, whilst believed to be accurate are set out as a general outline only for guidance and do not constitute any part of an offer or contract. Intending purchasers should not rely on them as statements of representation of fact, but must satisfy themselves by inspection or otherwise as to their accuracy. No person in this firm's employment has the authority to make or give any representation or warranty in respect of the property.