



Portnall Road, Maida Vale,
London

£1,900 Per Month

jo



1



1



1



C

jo

Portnall Road, Maida Vale, London

£1,900 Per Month



Summary Description

A fantastic bright and airy one bedroom first floor maisonette with own entrance (622 sq ft / 57 sq m) set within a period conversion mid terraced house on a lovely quiet residential street located short walking distance from Queens Park is available from 1st of April. This spacious property comprises of a modern fitted separate kitchen, fully fitted modern bathroom, huge reception room, one double bedroom with built-in wardrobe. Located in Westminster borough council band is D, EPC rating C. The property is situated within walking distance of Westbourne Park underground station (Hammersmith and City Line - Zone 2) and Queens Park underground station (Bakerloo Line and overground - Zone 2) both offering reliable links into and out of Central London and various bus routes to various places. One week's holding deposit required, 5 week's damage deposit required.

Area Map

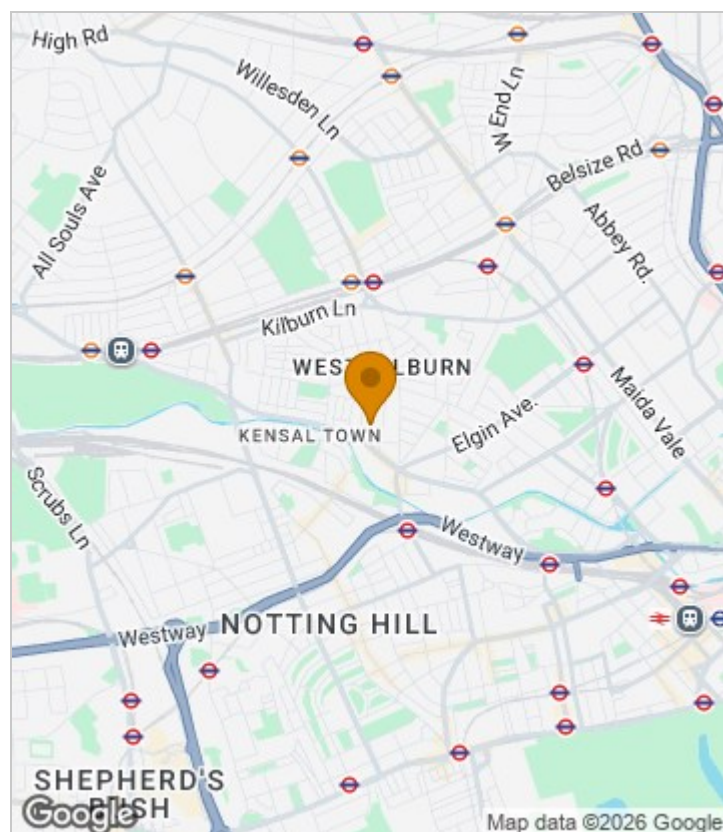



Floor Plan

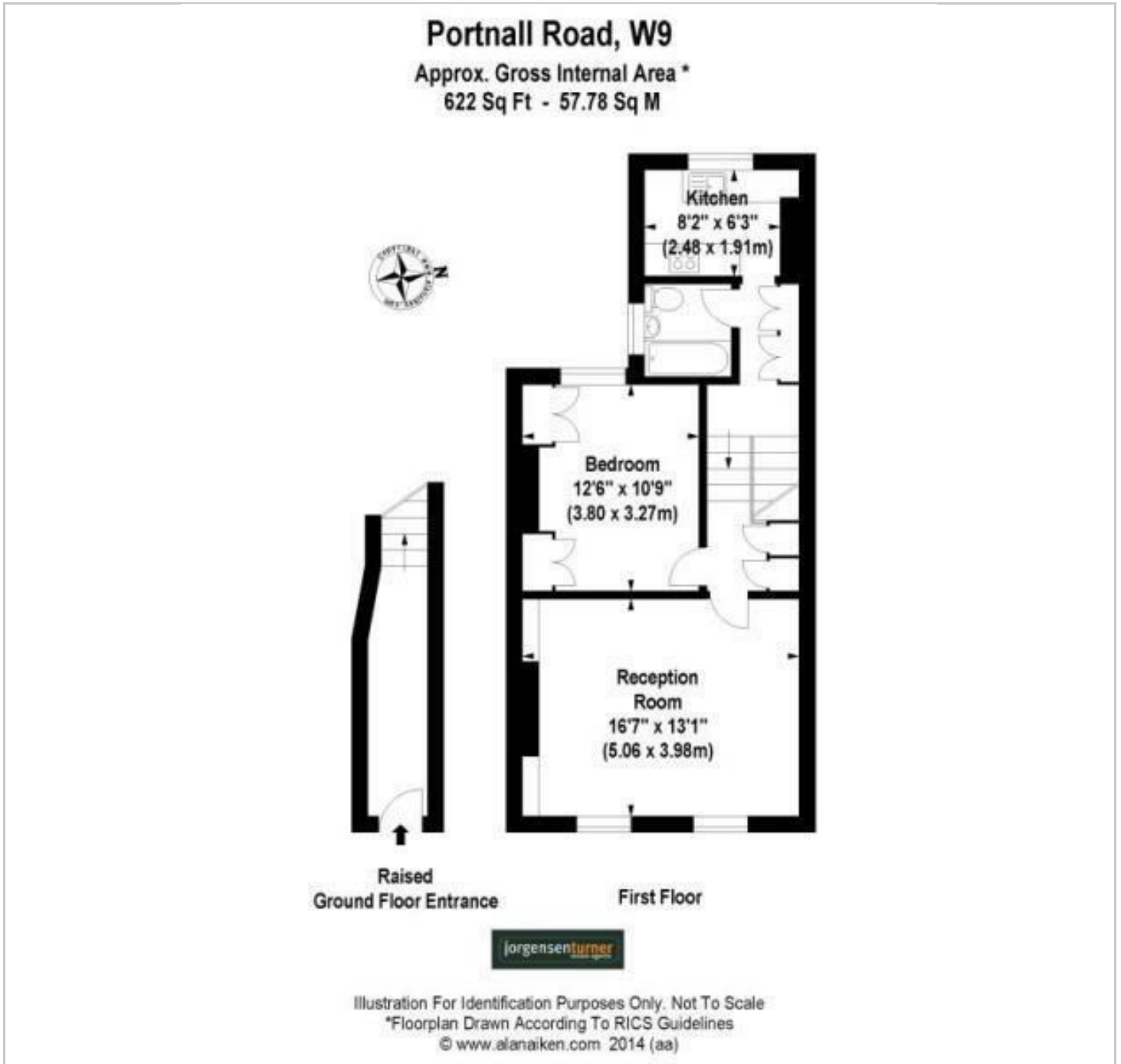

Energy Efficiency Graph

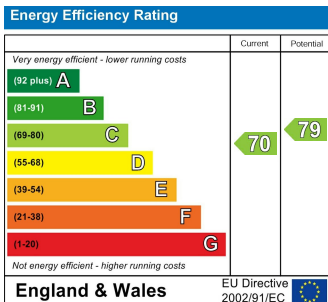

Viewing

Please contact our Lettings QP Office on 0207 604 4040 if you wish to arrange a viewing appointment for this property or require further information.

For further information contact:

Lettings QP, 2a Brondesbury Road, London, NW6 6AS

Tel: 0207 604 4040 Email: info@jorgensenturner.com <https://www.jorgensenturner.com/>

Disclaimer

These particulars, whilst believed to be accurate are set out as a general outline only for guidance and do not constitute any part of an offer or contract. Intending purchasers should not rely on them as statements of representation of fact, but must satisfy themselves by inspection or otherwise as to their accuracy. No person in this firm's employment has the authority to make or give any representation or warranty in respect of the property.