



# Mazenod Avenue, West Hampstead, London

£1,695 Per Month



## Summary Description

A first floor one double bed apartment located in lovely period conversion available from 25th of April. The apartment comprises one double bedroom, bright reception room, separate large kitchen and bathroom. Further benefits wooden floors in bedroom and hallway but carpet in the lounge. This property comes furnished.

Ideally within close proximity to all the local amenities of Kilburn High Road and transport links including Kilburn Park Station (Bakerloo Line) and Kilburn Station (Jubilee Line) and also close to West Hampstead stations. Call Jorgensen Turner Estate Agent to arrange a viewing or to get more information. Council tax band C, one week's holding deposit required, 5 weeks damage deposit required, EPC rating C

## Area Map

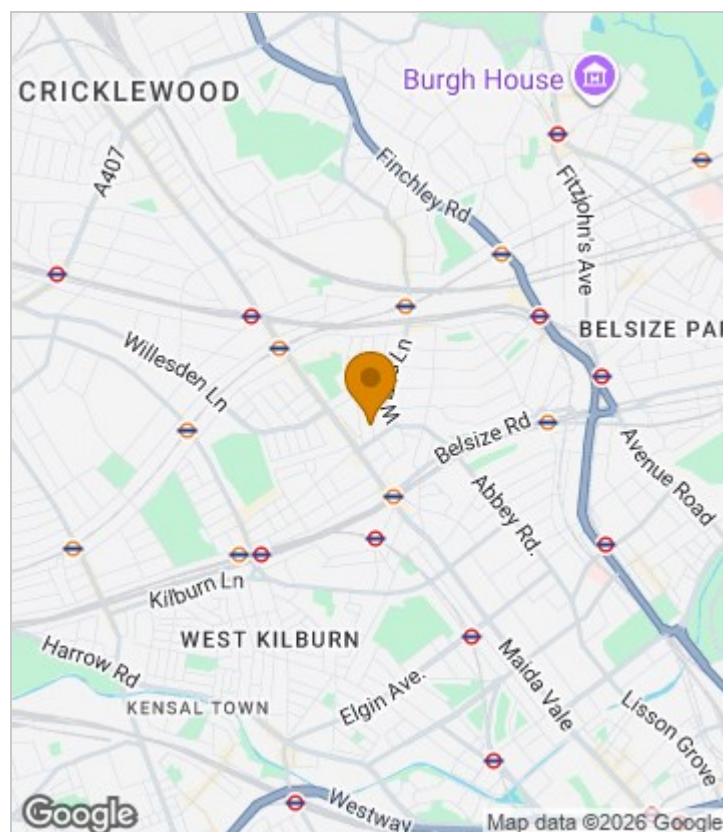



# Floor Plan

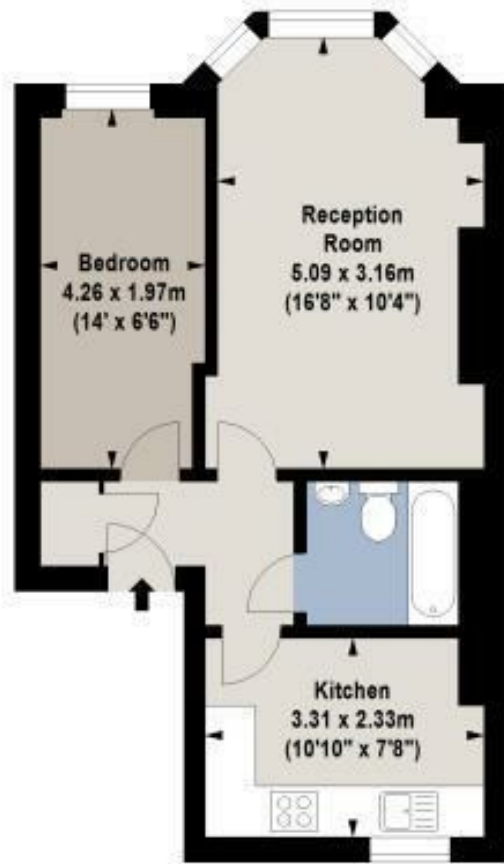

First Floor



For Identification Purposes Only. Not To Scale. © www.totalvista.uk 2017.

Mazenod Avenue, NW6

Approx. Gross Internal Area  
40.50 Sq M - 436 Sq Ft

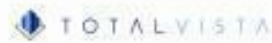

## Energy Efficiency Graph

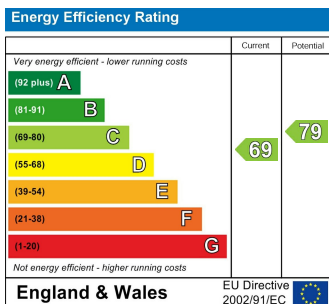

## Viewing

Please contact our Lettings QP Office on 0207 604 4040 if you wish to arrange a viewing appointment for this property or require further information.

- Large one bedroom flat
- West Hampstead
- Storage
- First floor
- Separate kitchen
- Easy access to Central London

For further information contact:

Lettings QP, 2a Brondesbury Road, London, NW6 6AS

Tel: 0207 604 4040 Email: [info@jorgensenturner.com](mailto:info@jorgensenturner.com) <https://www.jorgensenturner.com/>

## Disclaimer

These particulars, whilst believed to be accurate are set out as a general outline only for guidance and do not constitute any part of an offer or contract. Intending purchasers should not rely on them as statements of representation of fact, but must satisfy themselves by inspection or otherwise as to their accuracy. No person in this firm's employment has the authority to make or give any representation or warranty in respect of the property.