



J | JORGENSENTURNER



Brondesbury Villas,  
Kilburn, NW6

£1,898 Per Month



 1  1  1  C

# Brondesbury Villas, Kilburn, NW6

£1,898 Per Month

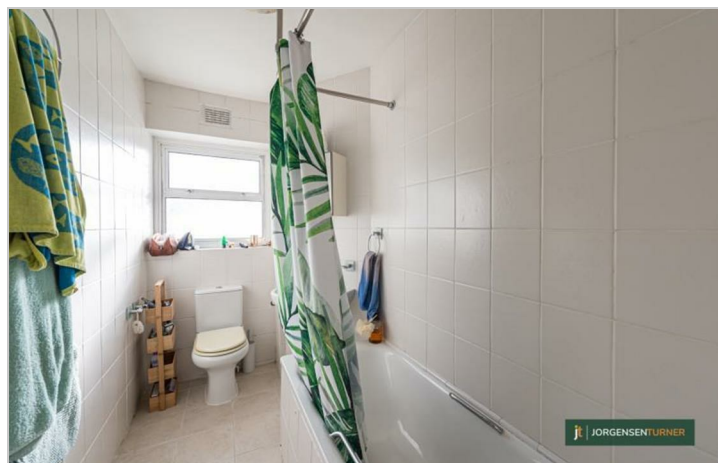

## Summary Description

This beautiful one-bedroom flat full of character is available immediately. The property boasts a stunning lounge with high ceilings an abundance of natural light and charming period features throughout.

It offers a spacious double bedroom with built-in storage a modern kitchen and bathroom, excellent additional storage wooden flooring throughout, and an EPC rating of C.

The flat benefits from easy access to local shops and restaurants, along with excellent transport links into central London. Brondesbury Villas is a sought-after residential street, ideally located moments from Queens Park, Kilburn High Road, and Kilburn Park stations.

Call Jorgensen Turner to arrange a viewing, one weeks holding deposit required, 5 weeks damage deposit required, council tax band C

## Area Map

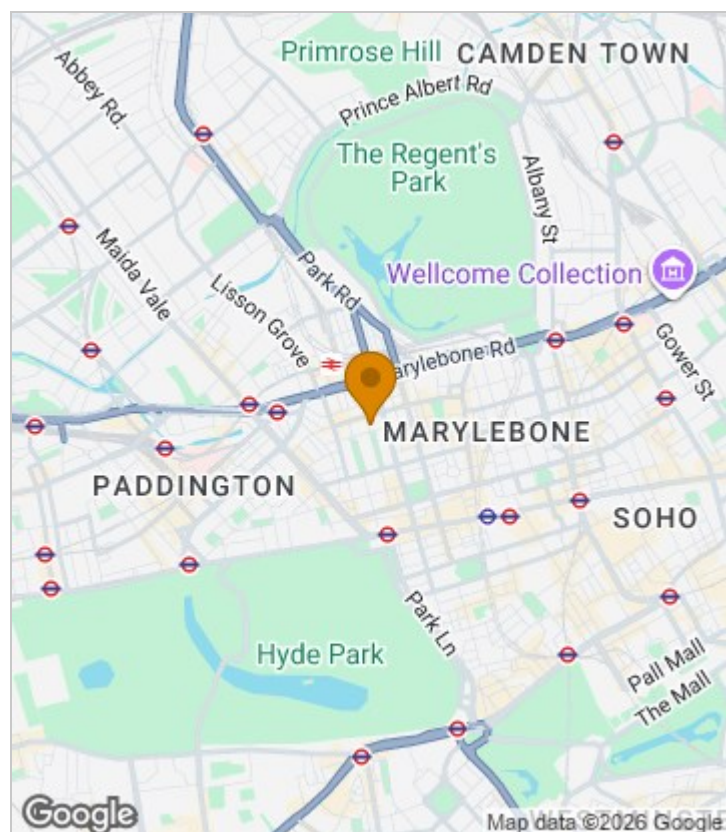



## Floor Plan

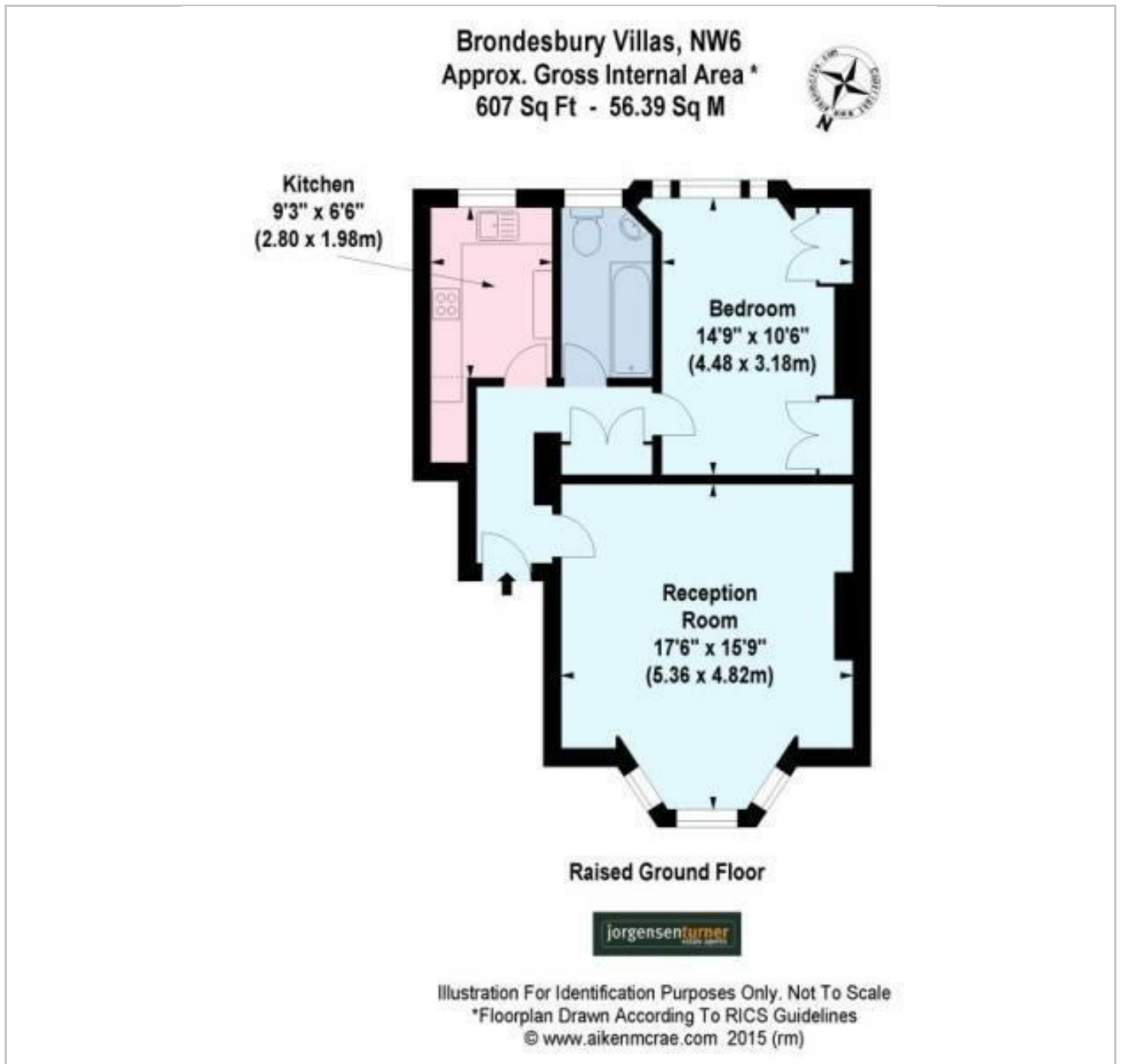

## Energy Efficiency Graph

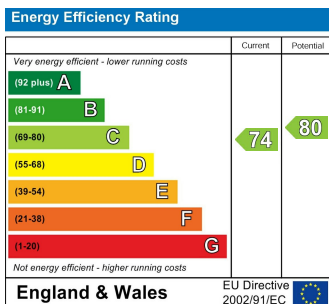

## Viewing

Please contact our Lettings QP Office on 0207 604 4040 if you wish to arrange a viewing appointment for this property or require further information.

For further information contact:

Lettings QP, 2a Brondesbury Road, London, NW6 6AS

Tel: 0207 604 4040 Email: [info@jorgensenturner.com](mailto:info@jorgensenturner.com) <https://www.jorgensenturner.com/>

## Disclaimer

These particulars, whilst believed to be accurate are set out as a general outline only for guidance and do not constitute any part of an offer or contract. Intending purchasers should not rely on them as statements of representation of fact, but must satisfy themselves by inspection or otherwise as to their accuracy. No person in this firm's employment has the authority to make or give any representation or warranty in respect of the property.