

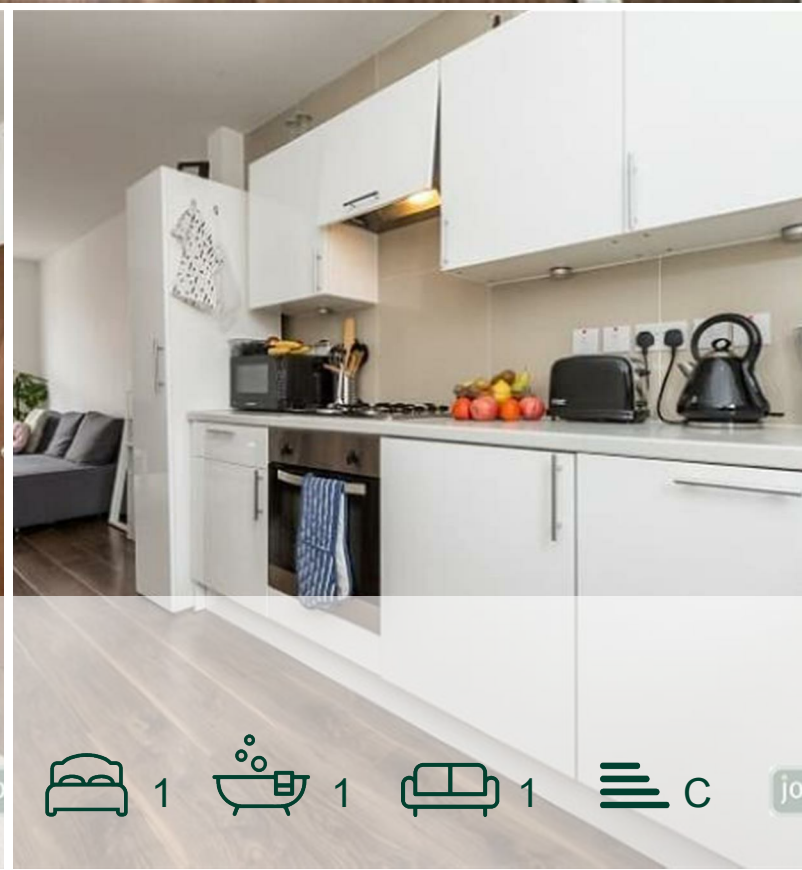

jorgensenturner
estate agents



Kilburn High, Kilburn,
London

£1,650 Per Month



1



1



1



C

Kilburn High, Kilburn, London

£1,650 Per Month



Summary Description

A fantastic ultra convenient modern one bedroom second floor conversion flat. The property features a great open plan living space, contemporary kitchen including washing machine and dishwasher, modern shower room, spacious bedroom and wooden flooring throughout. Other features are high ceiling, double glazed windows, tons of light. Available from 22nd of October with some flexibility.

Additionally the flat benefits from being within very close proximity of Kilburn Park and Kilburn underground stations, the Overground at Kilburn High Road and the various local bus links. To arrange a viewing please contact Jorgensen Turner estate agents. One weeks holding deposit will be required, 5 weeks damage deposit will be required, council tax band C

Area Map

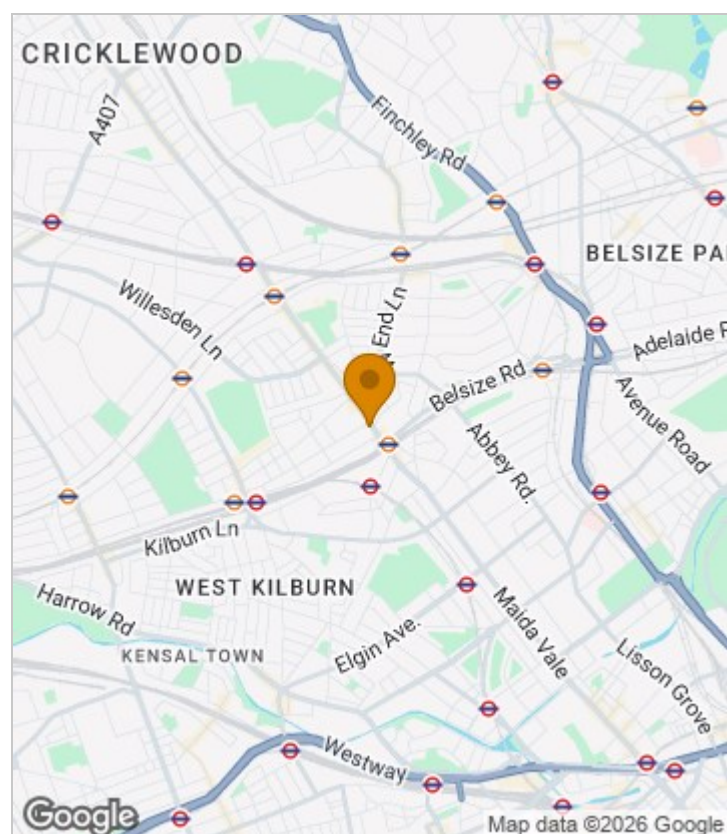



Floor Plan

Kilburn High Road, NW6

Approx. Gross Internal Area *
422 Sq Ft - 39.20 Sq M

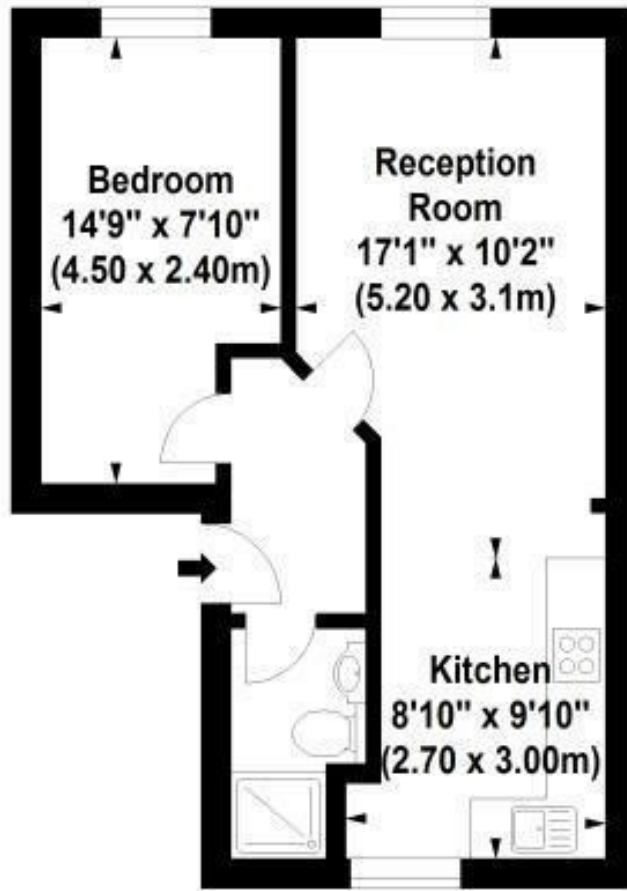

Second Floor

Illustration For Identification Purposes Only. Not To Scale

*Floorplan Drawn According To RICS Guidelines

© www.aikenmcrae.com 2014 (rm)

Energy Efficiency Graph

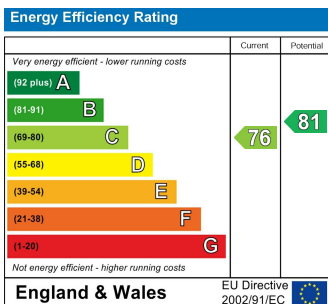

Viewing

Please contact our Lettings QP Office on 0207 604 4040 if you wish to arrange a viewing appointment for this property or require further information.

For further information contact:

Lettings QP, 2a Brondesbury Road, London, NW6 6AS

Tel: 0207 604 4040 Email: info@jorgensenturner.com <https://www.jorgensenturner.com/>

Disclaimer

These particulars, whilst believed to be accurate are set out as a general outline only for guidance and do not constitute any part of an offer or contract. Intending purchasers should not rely on them as statements of representation of fact, but must satisfy themselves by inspection or otherwise as to their accuracy. No person in this firm's employment has the authority to make or give any representation or warranty in respect of the property.