



jt | JORGENSENTURNER



St. Julians Road, London

£1,750



jt



1



1



1



D

jt

# St. Julians Road, London

£1,750



## Summary Description

Absolutely gorgeous one bedroom property is available immediately. Property offers many period features yet is very modern throughout. Modern kitchen provides tons of storage, comes with all appliances including dish washer. Other great features are high ceiling, modern bathroom, huge bedroom with big fitted wardrobe, wooden floor throughout.

Conveniently located close to many bars, restaurants shops. Easy access to Kilburn station, Kilburn Park station, Queens park station, Brondesbury overground, many buses routes available for easy access to Central London.

One week's holding deposit required, 5 weeks damage deposit required, EPC rating D, council tax band C.

## Area Map

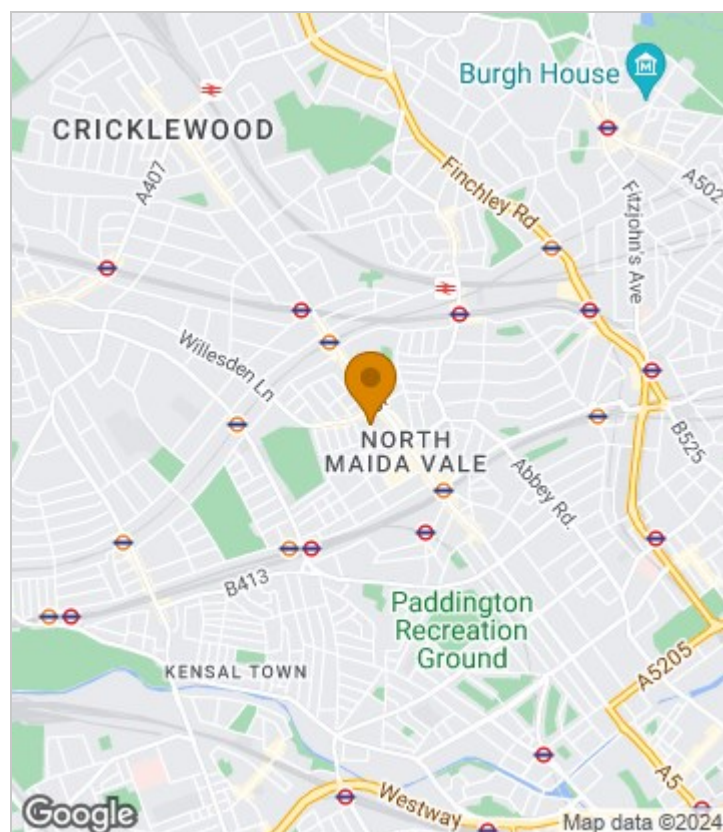



# Floor Plan

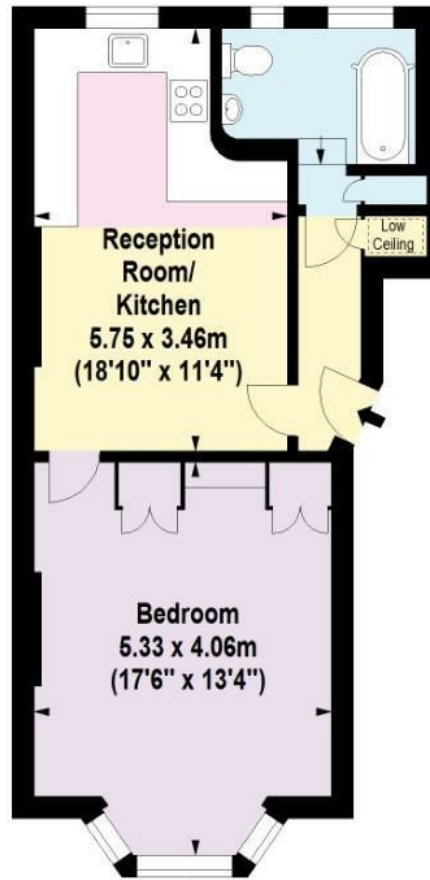

**Raised Ground Floor**

For Identification Purposes Only. Not To Scale. © www.totalvista.uk 2023



**Saint Julian's Road, NW6**

Approx. Gross Internal Area  
48.40 Sq M - 521 Sq Ft



## Energy Efficiency Graph

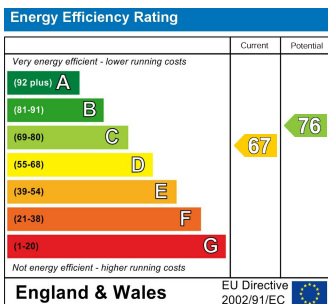

## Viewing

Please contact our Lettings QP Office on 0207 604 4040 if you wish to arrange a viewing appointment for this property or require further information.

For further information contact:

Lettings QP, 2a Brondesbury Road, London, NW6 6AS

Tel: 0207 604 4040 Email: [info@jorgensenturner.com](mailto:info@jorgensenturner.com) <https://www.jorgensenturner.com/>

## Disclaimer

These particulars, whilst believed to be accurate are set out as a general outline only for guidance and do not constitute any part of an offer or contract. Intending purchasers should not rely on them as statements of representation of fact, but must satisfy themselves by inspection or otherwise as to their accuracy. No person in this firm's employment has the authority to make or give any representation or warranty in respect of the property.

