



jt | JORGENSENTURNER



Canterbury Road, North
Maida Vale

£1,995 Per Month



jt | 2 1 1 C

Canterbury Road, North Maida Vale

£1,995 Per Month



Summary Description

This stunning basement flat is available NOW! Property just been renovated from start to finish and is offering modern feeling throughout the flat. Both bedrooms are double, one modern bathroom and new modern kitchen will make any renter feel like home. Other features are hardwood floor, fully double glazed windows, new radiators.

Property is offering EPC rating C. Easy access to Maida Vale and Queens park, is only few minutes away from Kilburn Park station (Bakerloo line). Comes furnished or unfurnished.

One weeks deposit will be required, 5 weeks damage deposit will be required.

Area Map

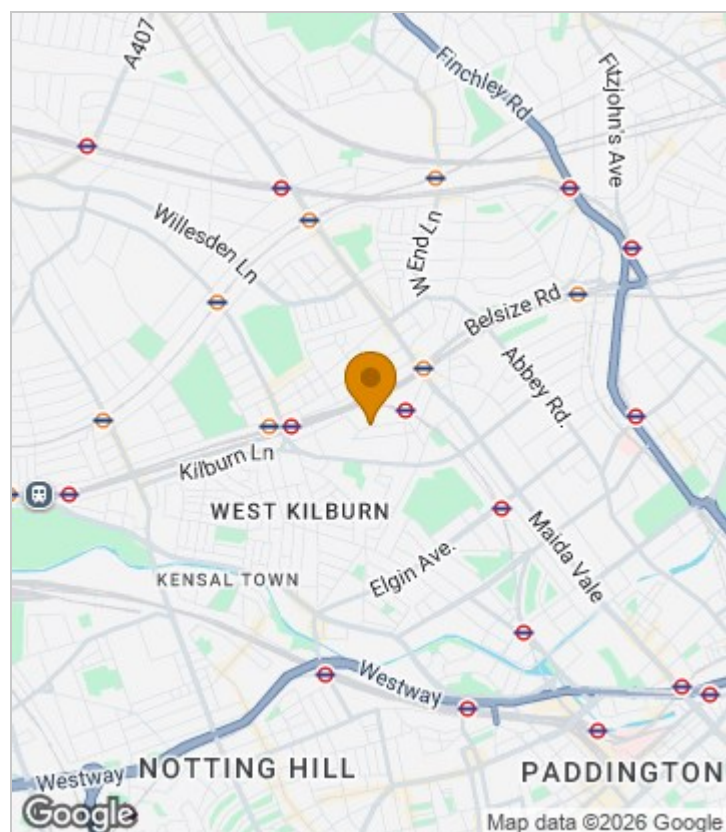



Floor Plan

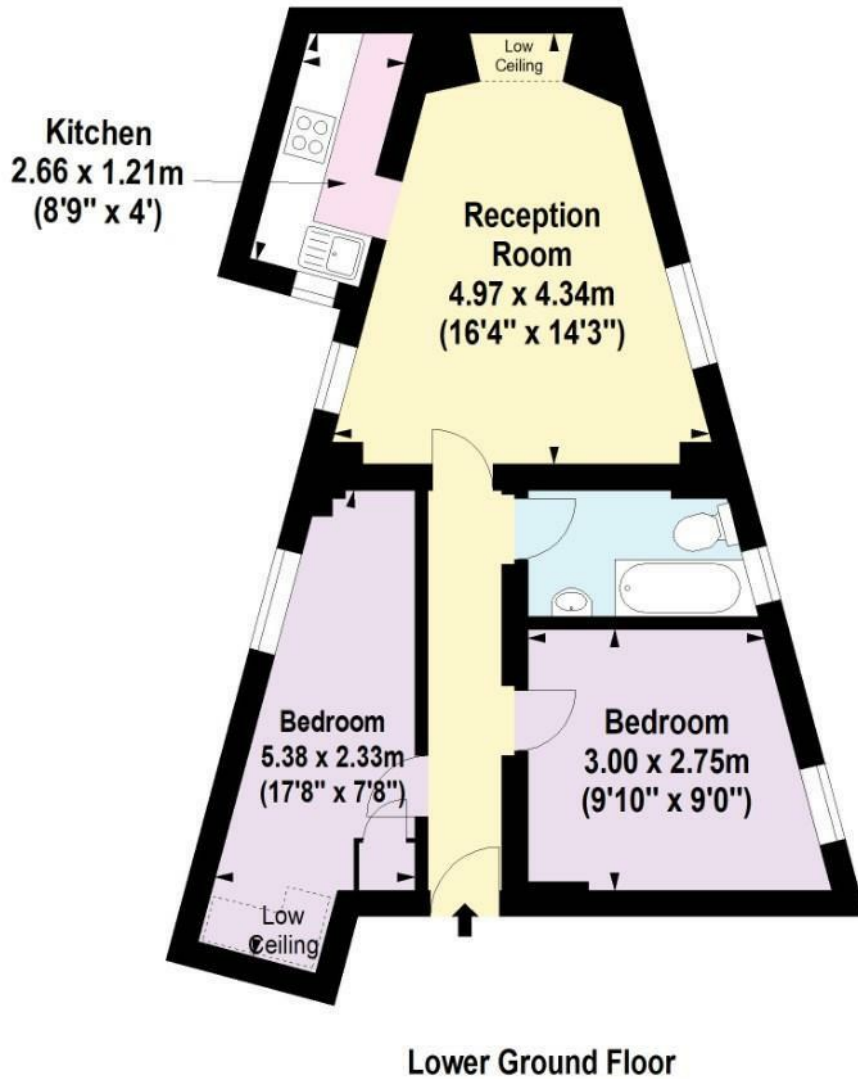

For Identification Purposes Only. Not To Scale. © www.totalvista.uk 2025



Canterbury Road, NW6

Approx. Gross Internal Area
49.24 Sq M - 530 Sq Ft



Energy Efficiency Graph

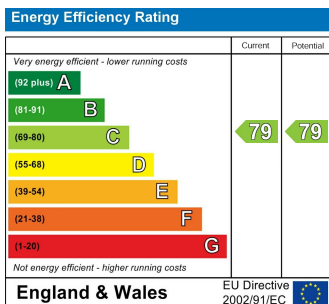

Viewing

Please contact our Lettings QP Office on 0207 604 4040 if you wish to arrange a viewing appointment for this property or require further information.

- Brand new flat
- New kitchen
- Hardwood flooring
- Two double bedrooms
- New bathroom

For further information contact:

Lettings QP, 2a Brondesbury Road, London, NW6 6AS

Tel: 0207 604 4040 Email: info@jorgensenturner.com <https://www.jorgensenturner.com/>

Disclaimer

These particulars, whilst believed to be accurate are set out as a general outline only for guidance and do not constitute any part of an offer or contract. Intending purchasers should not rely on them as statements of representation of fact, but must satisfy themselves by inspection or otherwise as to their accuracy. No person in this firm's employment has the authority to make or give any representation or warranty in respect of the property.