



jorgensenturner
estate agents



Kilburn High Road, Kilburn
Park

£1,650 Per Month



Kilburn High Road, Kilburn Park

£1,650 Per Month



Summary Description

A superb one bedroom top floor conversion flat which is ultra conveniently located for the varied shopping and transport routes of both Kilburn High Road and Queens Park. The property features a great open plan living space, contemporary kitchen including washing machine and dishwasher, modern bathroom, bedroom with built-in wardrobe and wood flooring in the reception area. Additionally the flat benefits from being within very close proximity of Kilburn Park and Kilburn underground stations, the Overground at Kilburn High Road and the various local bus links. To arrange a viewing please contact Jorgensen Turner Estate Agents. EPC rating C, council tax band B, one weeks holding deposit required, 5 week's damage deposit required.

Area Map





Floor Plan

Kilburn High Road London NW6



Approx. Gross Internal Area = 41m square
= (439ft square)

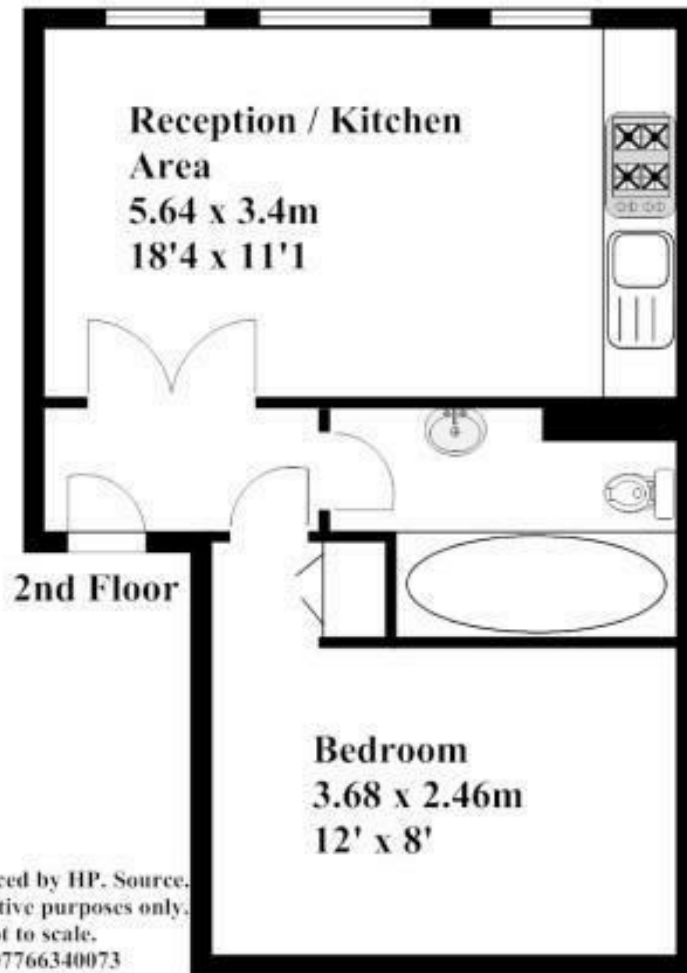

Plan produced by HP. Source.
For illustrative purposes only.
Not to scale.
Tel-07766340073

Energy Efficiency Graph

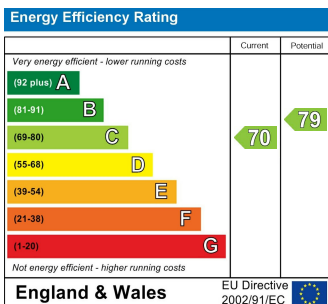

Viewing

Please contact our Lettings QP Office on 0207 604 4040 if you wish to arrange a viewing appointment for this property or require further information.

- Furnished
- Double Glazing
- Kilburn Park Station
- One Bedroom, Top Floor
- Open Plan
- Kilburn High Road
- Fitted Modern Bathroom

For further information contact:

Lettings QP, 2a Brondesbury Road, London, NW6 6AS

Tel: 0207 604 4040 Email: info@jorgensenturner.com <https://www.jorgensenturner.com/>

Disclaimer

These particulars, whilst believed to be accurate are set out as a general outline only for guidance and do not constitute any part of an offer or contract. Intending purchasers should not rely on them as statements of representation of fact, but must satisfy themselves by inspection or otherwise as to their accuracy. No person in this firm's employment has the authority to make or give any representation or warranty in respect of the property.

