



jt | JORGENSENTURNER



Bron Court, Brondesbury
Road, London
£2,095 Per Month



jt 2 1 1 C jt

Bron Court, Brondesbury Road, London

£2,095 Per Month



Summary Description

A super spacious two double bedroom second floor flat available from 22nd of March in this well regarded purpose built development. The property benefits from a really good sized living space, good size modern kitchen, two big double bedrooms that comes with built in storage, lovely modern bathroom and an allocated gated parking space.

Property comes on part furnished basis. Ideally located between Queens Park and Kilburn Park stations, easy access to West Hampstead or Kilburn Jubilee line, easy access to Kilburn High Road over ground station, many buses routes available. One week's holding deposit required, 5 weeks damage deposit required,

Area Map

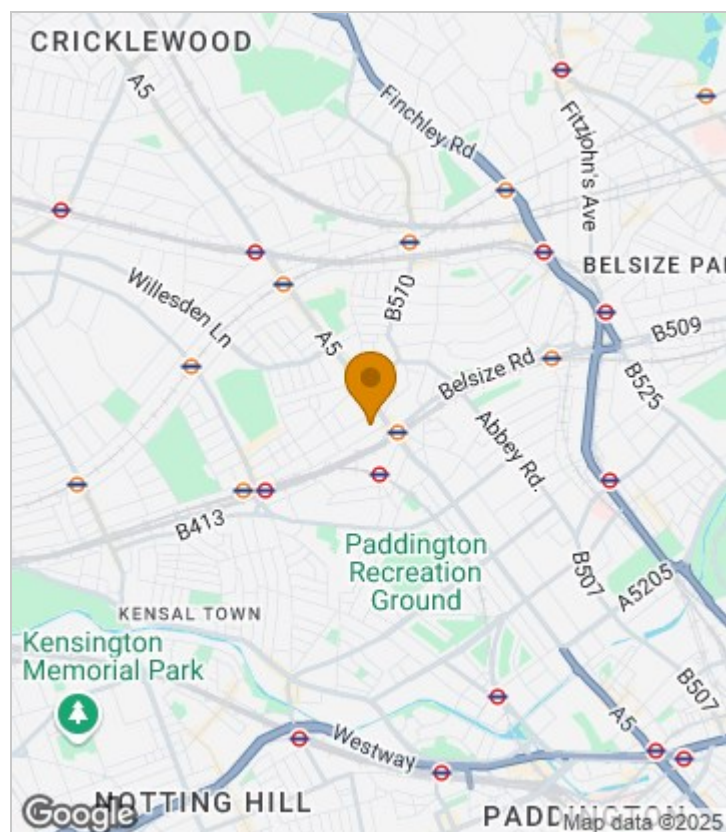



Floor Plan

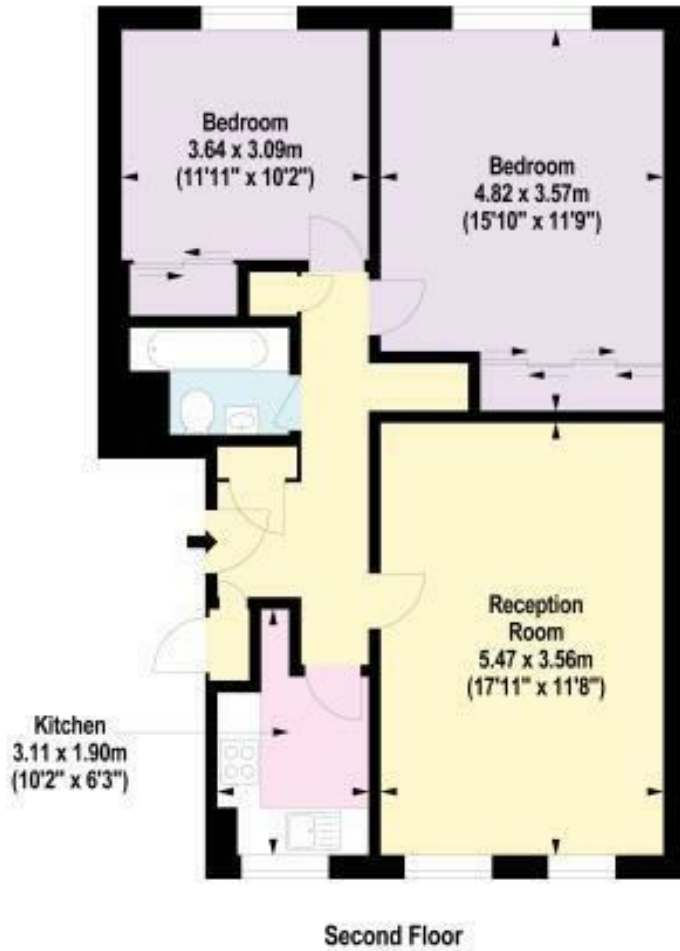

For Identification Purposes Only. Not To Scale. © www.totalvista.uk 2020

**Bron Court,
Brondesbury Road, NW6**

Approx. Gross Internal Area
64.19 Sq M - 691 Sq Ft

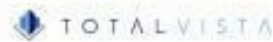

Energy Efficiency Graph

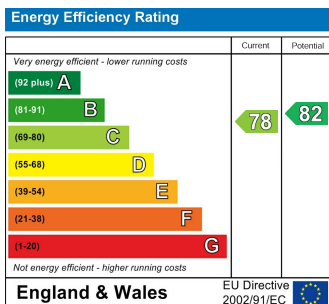

Viewing

Please contact our Lettings QP Office on 0207 604 4040 if you wish to arrange a viewing appointment for this property or require further information.

- Two double bedrooms
- Large lounge
- Modern kitchen
- Modern bathroom
- Hardwood flooring
- Very bright
- Great storage

For further information contact:

Lettings QP, 2a Brondesbury Road, London, NW6 6AS

Tel: 0207 604 4040 Email: info@jorgensenturner.com <https://www.jorgensenturner.com/>

Disclaimer

These particulars, whilst believed to be accurate are set out as a general outline only for guidance and do not constitute any part of an offer or contract. Intending purchasers should not rely on them as statements of representation of fact, but must satisfy themselves by inspection or otherwise as to their accuracy. No person in this firm's employment has the authority to make or give any representation or warranty in respect of the property.

