

Loftus Road, Shepherds
Bush

Asking Price £745,000



2



1



1



D

Loftus Road, Shepherds Bush

Asking Price £745,000



Summary Description

WONDERFUL GARDEN FLAT, LOFTUS ROAD W12 A fabulous two bedroom garden flat in the centre of Shepherds Bush. Benefitting from your own front door at lower ground level, this flat is offered with character and charm throughout. The flat has been creatively extended to provide a wonderful open plan living-dining space, with window seating overlooking a beautiful West facing rear garden of approximately 50ft. The flat offers two bedrooms, a modern bathroom suite and a fully fitted kitchen with integrated appliances. The flat further benefits from a Share of Freehold.

The location is well-served by a number of excellent independent shops, coffee shops, bars and pubs (Princess Victoria) along the Uxbridge Road. Transport wise the property is well served by the Central Line (Shepherds Bush), the Circle Line & Hammersmith & City Line (Shepherds Bush Market and Wood Lane) and London Overground (Shepherds Bush). The Westfield shopping centre is also only a short walk away from the property offering every retail store you could wish for. For the motorist the A4 and A40 are close by for easy access out to the West and North West of London.

Share of freehold, Service charge TBC, GR TBC, Hammersmith and Fulham Band D

Area Map

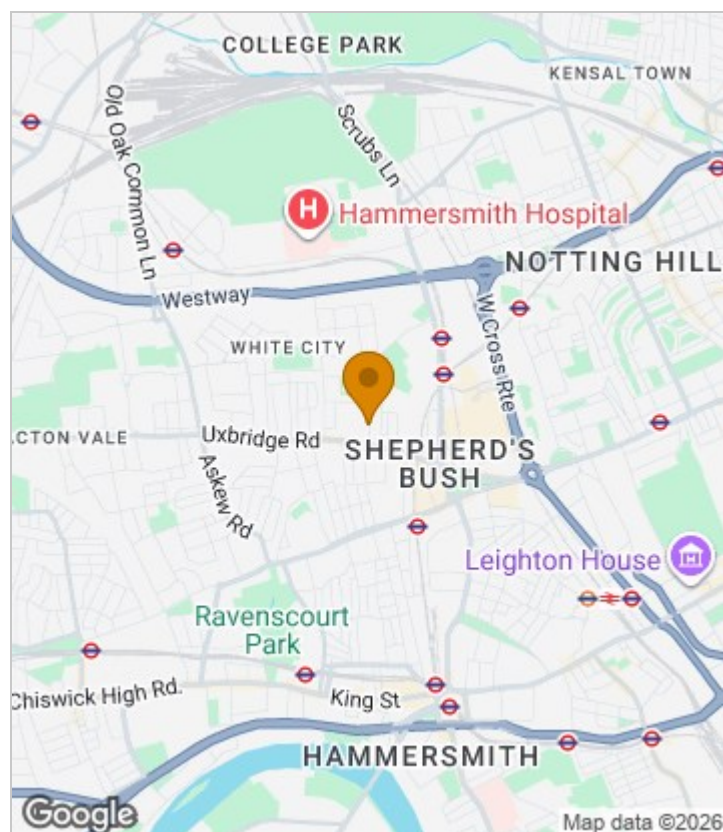

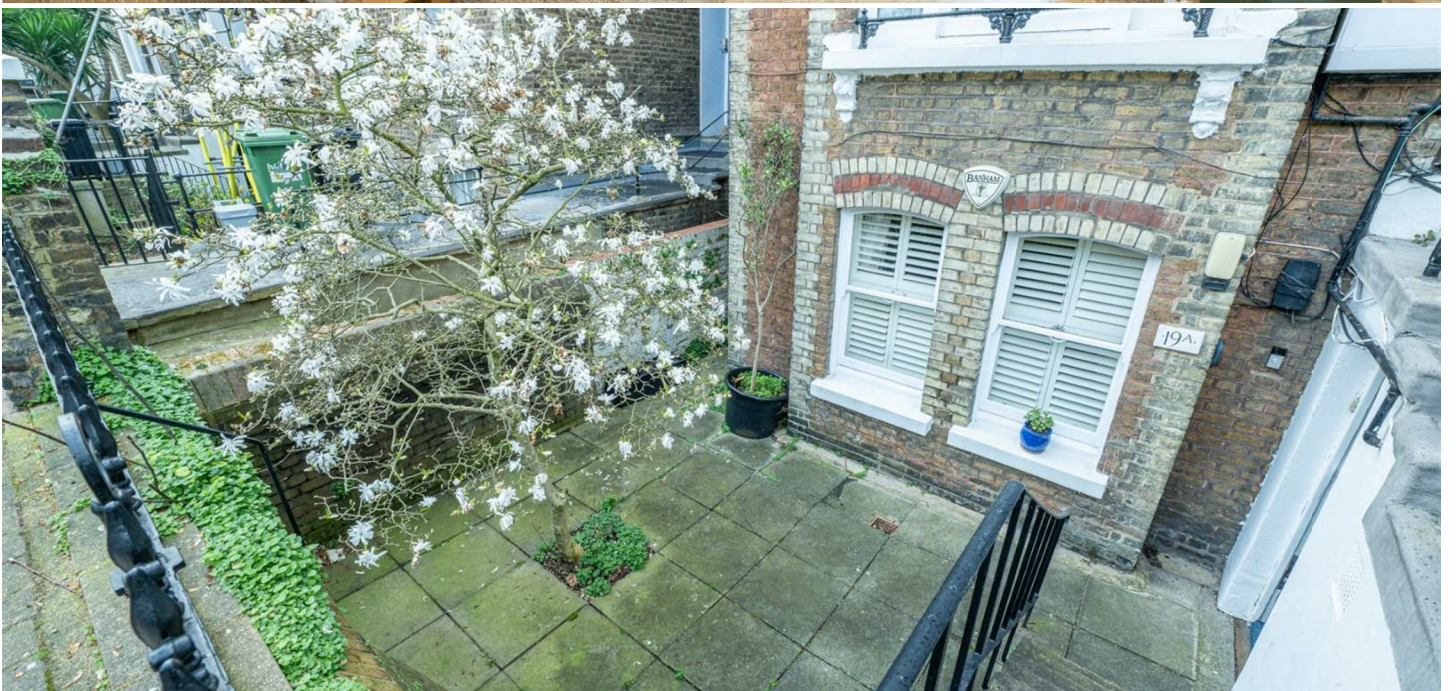

Floor Plan

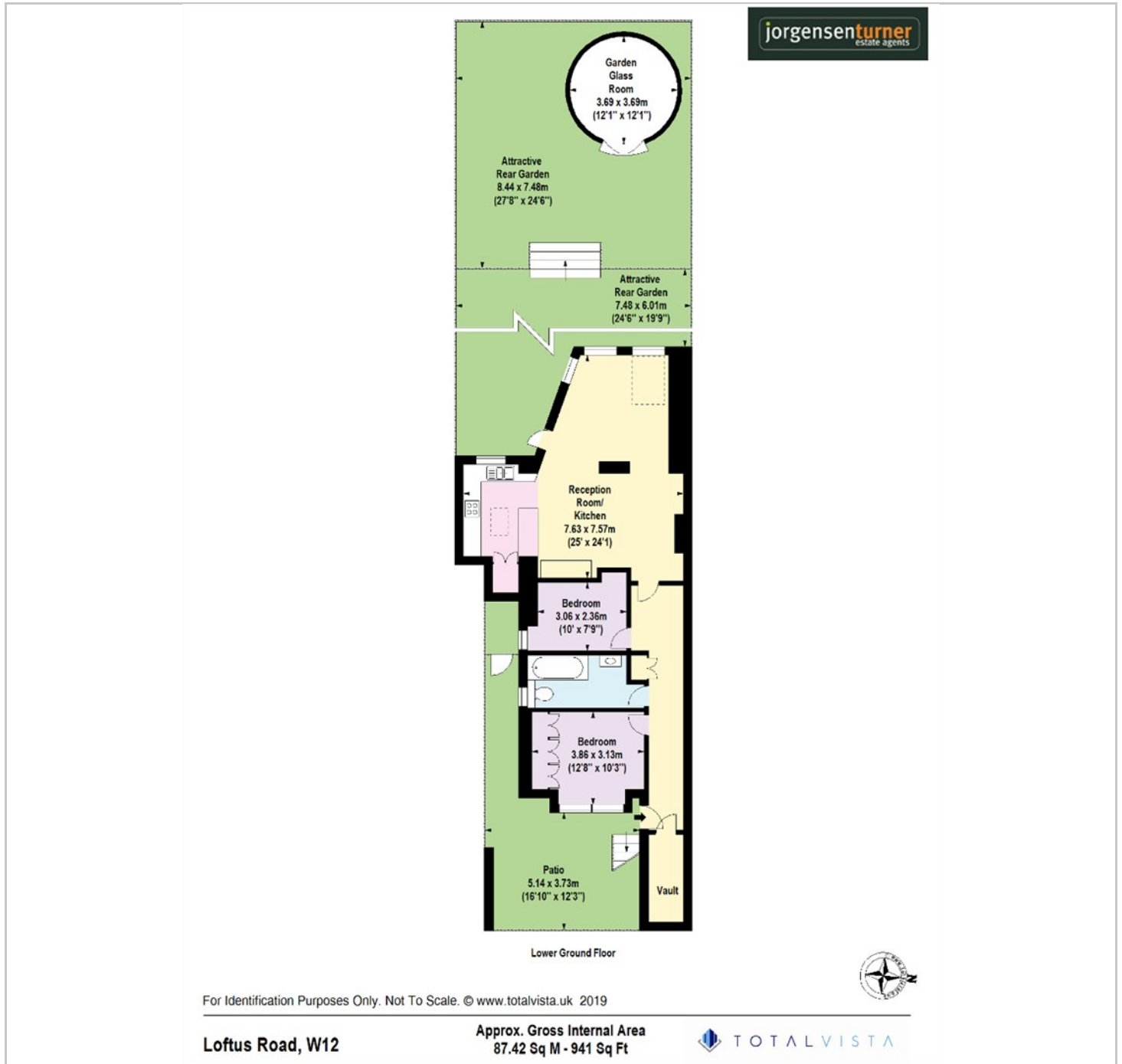

Energy Efficiency Graph

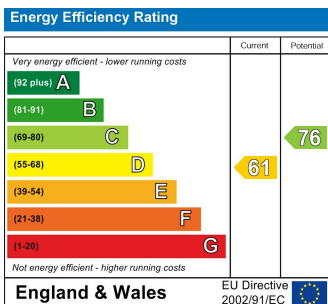

Viewing

Please contact our Sales SB Office on 0208 740 8740 if you wish to arrange a viewing appointment for this property or require further information.

- PRIME LOCATION
- IMPRESSIVE ENTERTAINING SPACE
- TWO BEDROOMS
- CLOSE TO CENTRAL LINE TUBE
- EXTENDED AND RE-MODELLED
- STUNNING REAR GARDEN
- APPROX 940 SQ FT
- GLASS HOUSE TO REAR
- CLOSE TO WESTFIELD CENTRE

For further information contact:

Sales SB, 234 Uxbridge Road, Shepherds Bush, London, W12 7JD

Tel: 0208 740 8740 Email: enquiries@jorgensenturner.com

<https://www.jorgensenturner.com/>

Disclaimer

These particulars, whilst believed to be accurate are set out as a general outline only for guidance and do not constitute any part of an offer or contract. Intending purchasers should not rely on them as statements of representation of fact, but must satisfy themselves by inspection or otherwise as to their accuracy. No person in this firm's employment has the authority to make or give any representation or warranty in respect of the property.