



Woodstock Grove,  
Shepherds Bush, W12  
Offers In Excess Of £360,000



# Woodstock Grove, Shepherds Bush, W12

Offers In Excess Of £360,000



## Summary Description

Woodstock Grove W12. A centrally located garden flat. Set at basement level of this attractive Victorian terrace, the flat offers a generous double bedroom with fitted wardrobes, spacious reception room with French doors leading out on to a private rear garden, fitted kitchen and a three piece bathroom to the rear. The property further benefits from being offered with a Share of freehold and chain free.

Woodstock Grove is ideally situated as it's a short walk away from a number of independent shops, bars and restaurants in Brook Green and an abundance of shopping experiences in Westfield White City. The lovely open spaces of Holland Park are also about a 15 minute walk from the property, Transport wise, the location is really well served by the Central Tube (Shepherds Bush), Overground at Shepherds Bush and Kensington Olympia ( District and Overground).

Share of Freehold. Service Charges TBC, GR N/A Hammersmith and Fulham, Council Tax Band B

## Area Map

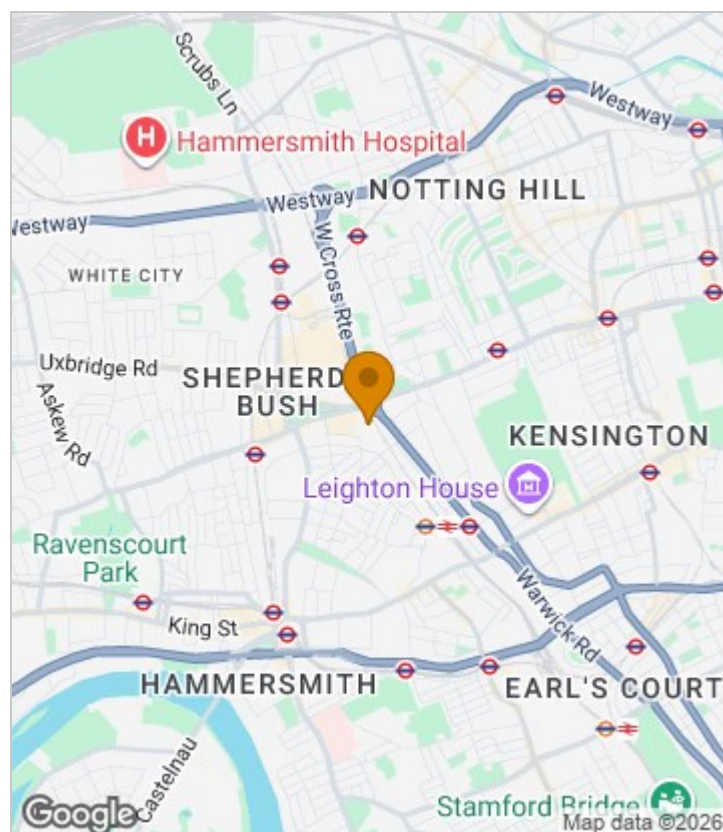



# Floor Plan

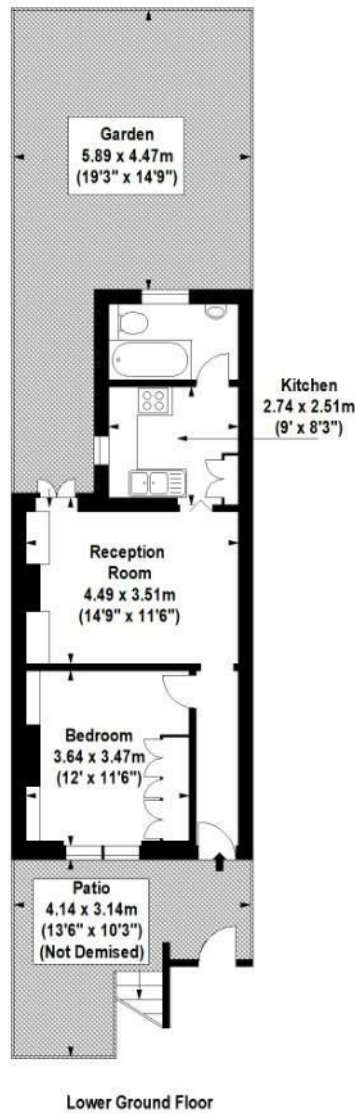

For Identification Purposes Only. Not To Scale. © www.totalvista.uk 2023



**Woodstock Grove, W12**

Approx. Gross Internal Area  
43.94 Sq M - 473 Sq Ft



## Energy Efficiency Graph

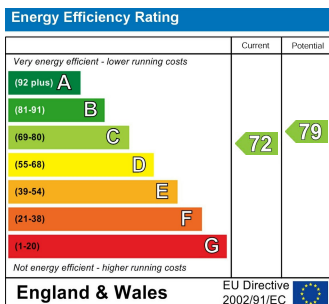

## Viewing

Please contact our Sales SB Office on 0208 740 8740 if you wish to arrange a viewing appointment for this property or require further information.

For further information contact:

Sales SB, 234 Uxbridge Road, Shepherds Bush, London, W12 7JD

Tel: 0208 740 8740 Email: [enquiries@jorgensenturner.com](mailto:enquiries@jorgensenturner.com)

<https://www.jorgensenturner.com/>

### Disclaimer

These particulars, whilst believed to be accurate are set out as a general outline only for guidance and do not constitute any part of an offer or contract. Intending purchasers should not rely on them as statements of representation of fact, but must satisfy themselves by inspection or otherwise as to their accuracy. No person in this firm's employment has the authority to make or give any representation or warranty in respect of the property.