



Hetley Road, Shepherds  
Bush, London, W12 8BA

Offers In Excess Of £525,000



# Hetley Road, Shepherds Bush, London, W12 8BA

Offers In Excess Of £525,000

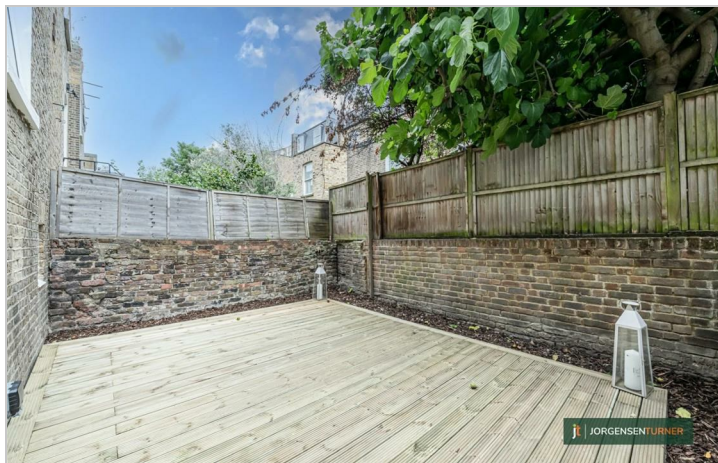

## Summary Description

Hetley Road W12. A beautifully refurbished two double bedroom garden apartment with underfloor heating throughout. The property has been finished to exacting standards throughout and comprises: a spacious open-plan kitchen reception room with feature fireplace and integrated appliances. There are two double bedrooms and a luxury new three piece shower room. The property further benefits from private decked rear garden and a new long lease (share of freehold to be transferred once all four flats in the building are sold). Chain Free

The location offers ultra-convenience for all the shops, bars and restaurants on the Uxbridge Road, the Westfield shopping centre, John Lewis and the infamous Soho House members club. The location is extremely well served transport wise with the Hammersmith and City and Central Line tubes, Shepherds Bush Over ground station and numerous bus routes in to Central London.

Long 999 yr lease (Share of freehold once all four flats are sold). Hammersmith and Fulham.

## Area Map

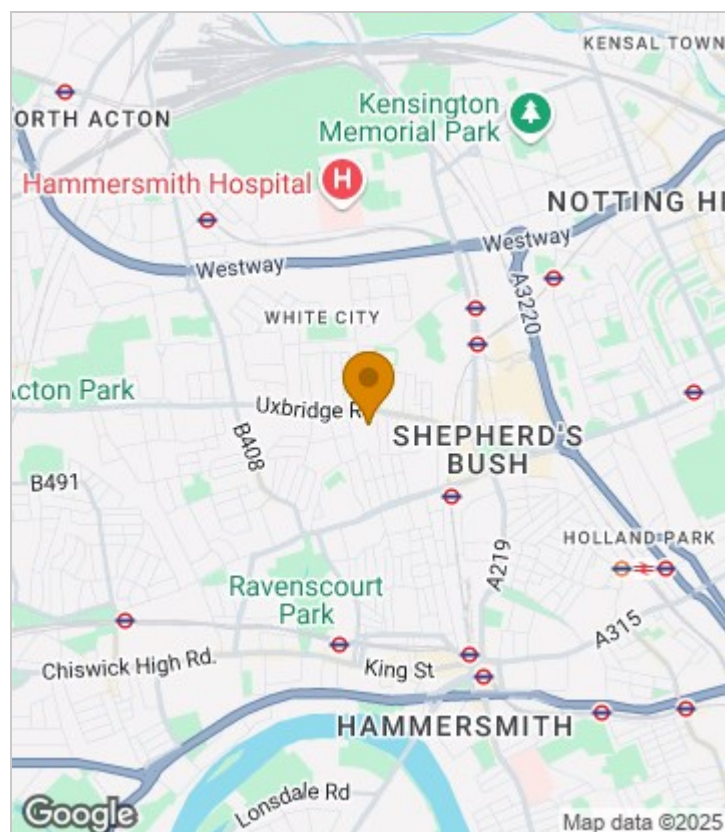





Floor Plan

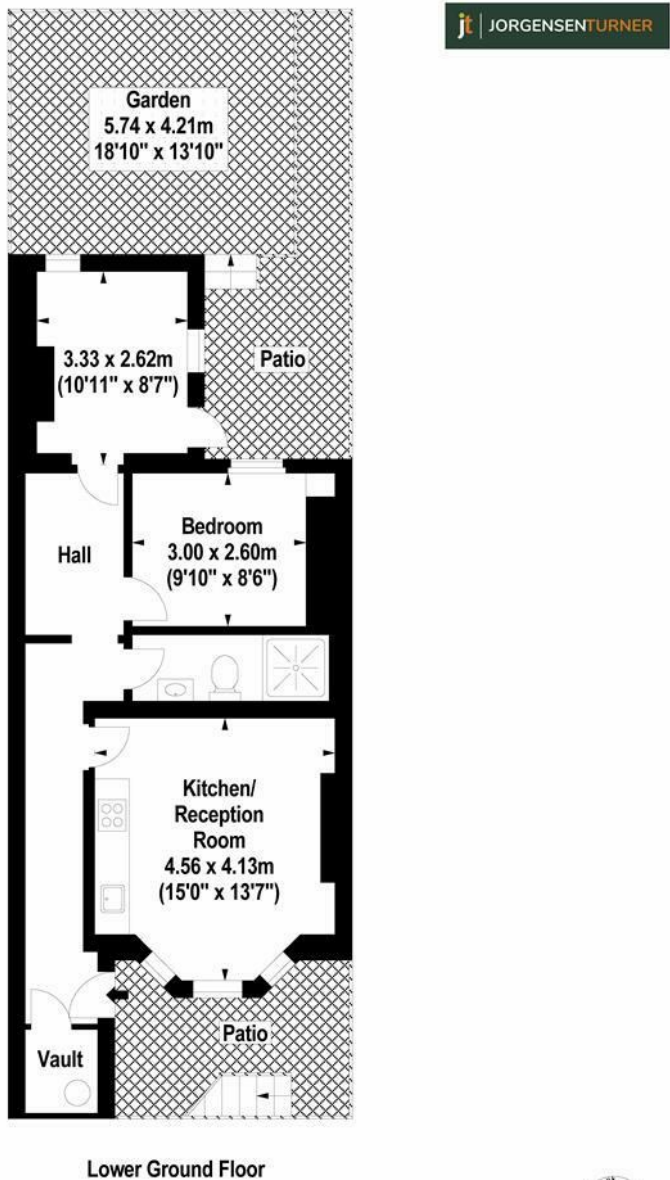

For Identification Purposes Only. Not To Scale. © www.totalvista.uk 2025

Hetley Road, W12

Approx. Gross Internal Area  
57.04 Sq M - 614 Sq Ft



Energy Efficiency Graph

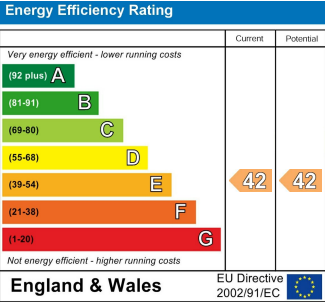

Viewing

Please contact our Sales SB Office on 0208 740 8740 if you wish to arrange a viewing appointment for this property or require further information.

- BEAUTIFULLY REFURBISHED
- TWO DOUBLE BEDROOMS
- PRIVATE DECKED REAR GARDEN
- HIGH END FINISH
- LONG 999 YR LEASE
- UNDERFLOOR HEATING
- CLOSE TO WESTFIELD WHITE CITY
- CENTRAL LINE TUBE CITY
- CLOSE TO SOHO HOUSE
- CLOSE TO MANY AMENITIES

For further information contact:  
Sales SB, 234 Uxbridge Road, Shepherds Bush, London, W12 7JD  
Tel: 0208 740 8740 Email: [enquiries@jorgensenturner.com](mailto:enquiries@jorgensenturner.com)  
<https://www.jorgensenturner.com/>

Disclaimer

These particulars, whilst believed to be accurate are set out as a general outline only for guidance and do not constitute any part of an offer or contract. Intending purchasers should not rely on them as statements of representation of fact, but must satisfy themselves by inspection or otherwise as to their accuracy. No person in this firms employment has the authority to make or give any representation or warranty in respect of the property.

