



jt | JORGENSENTURNER



Stowe Road, London

£1,700 Per Month

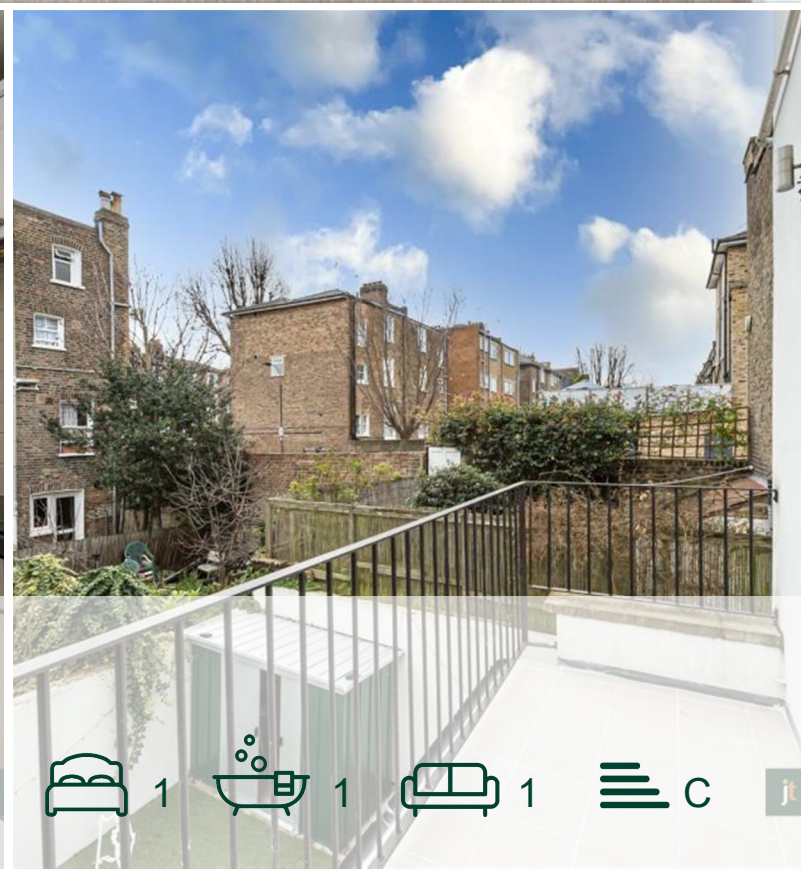

1 1 1 C

# Stowe Road, London

£1,700 Per Month



## Summary Description

Jorgensen Turner Estate Agents are delighted to introduce to the market this exceptional one-bedroom apartment, combining the best of modern living with the timeless attraction of Victorian architecture. Located on Stowe Road, W12, this 518sqft apartment is a testament to elegant design and thoughtful layout of space.

This apartment is a testament of modern minimalism, highlighted by its spacious interiors that bathe in natural light through large windows. The heart of this home is its galley-style kitchen, equipped with sleek, integrated appliances, ready to inspire cooking creativity and entertaining nights in. The living space extends outdoors onto a beautifully tiled balcony, offering a peaceful view over a well-kept neighbouring gardens, perfect for moments of relaxation or enjoying a morning cup of coffee.

Preserving its historical charm, the property features a striking white façade with distinctive bay windows, seamlessly blending into the vibrant surroundings of Shepherd's Bush. This area is renowned for its dynamic energy, offering residents immediate access to Shepherd's Bush Green, the renowned War Memorial, and the lively local market. Its prime location ensures unmatched convenience for shopping, dining, and access to London's comprehensive transport network.

This beautiful apartment offers a unique living experience from start to finish. It caters to those who appreciate the convenience of city life alongside the calmness of a modern, peaceful home space. Offered furnished and available from mid-March.

Council Tax Band D—Hammersmith & Fulham.

Deposit: One weeks' rent to reserve, with a security deposit of either 5 weeks' rent (for properties under £50,000pa) or 6 weeks' rent (for those over £50,000pa).

## Area Map

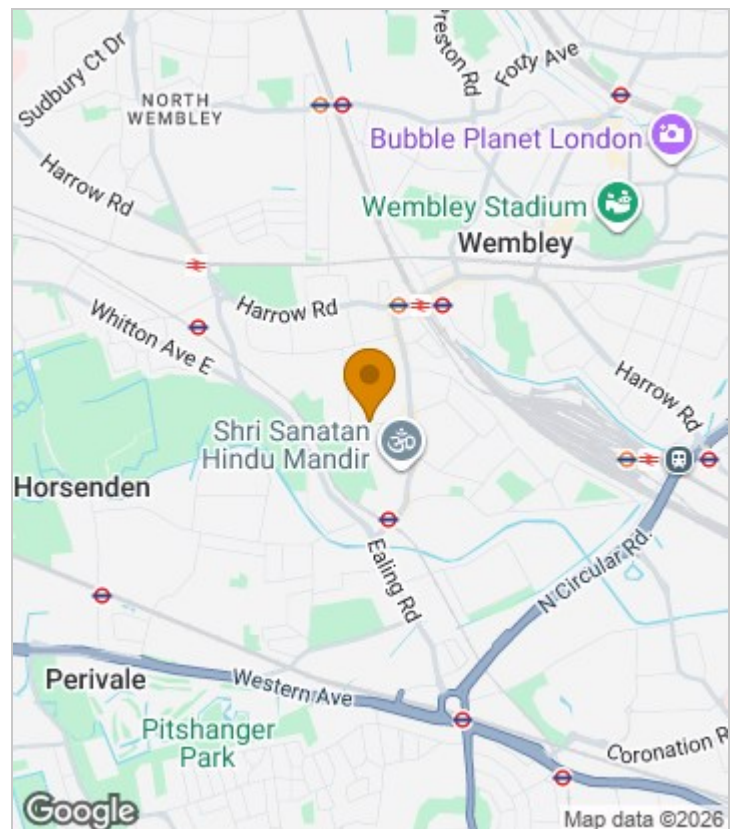



# Floor Plan

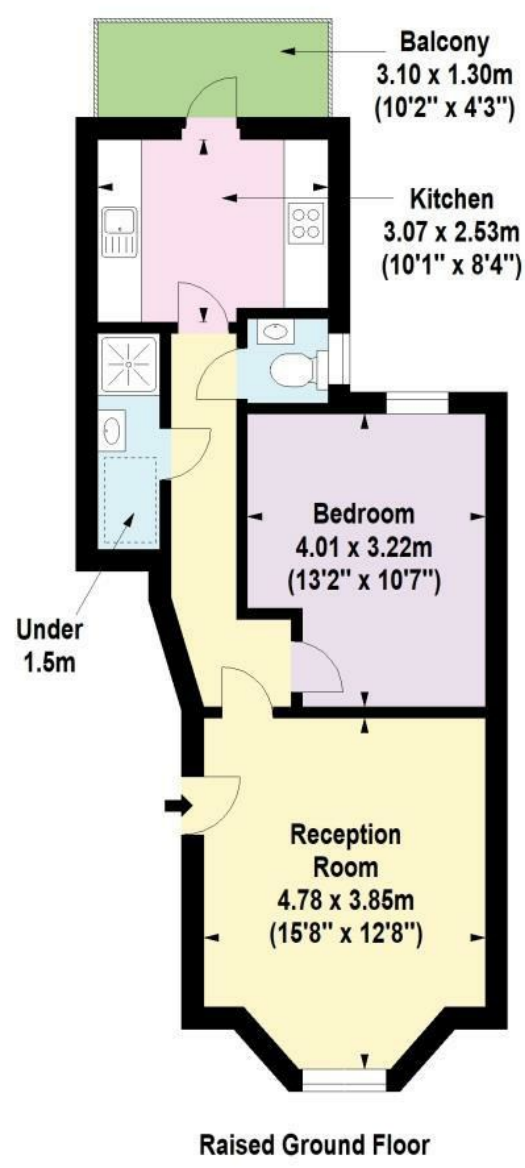

For Identification Purposes Only. Not To Scale. © www.totalvista.uk 2022



**Stowe Road, W12**

Approx. Gross Internal Area  
48.12 Sq M - 518 Sq Ft



## Energy Efficiency Graph

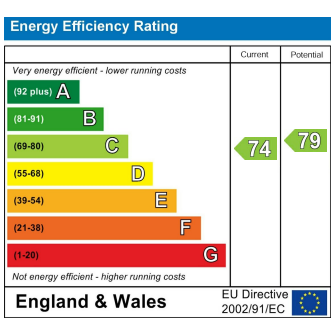

## Viewing

Please contact our Lettings SB Office on 0208 740 8740 if you wish to arrange a viewing appointment for this property or require further information.

- SPACIOUS BEDROOM
- SLEEK, INTEGRATED KITCHEN
- PLUSH CARPETING THROUGHOUT
- FANTASTIC TRANSPORT LINKS
- BEAUTIFUL VICTORIAN EXTERIOR
- LIGHT-FILLED LIVING SPACES
- PRIVATE BALCONY WITH GARDEN VIEWS
- PRIME W12 LOCATION
- LIVELY NEIGHBOURHOOD ATMOSPHERE
- AVAILABLE MID-MARCH

For further information contact:

Lettings SB, 234 Uxbridge Road, Shepherds Bush, London, W12 7JD

Tel: 0208 740 8740 Email: [enquiries@jorgensenturner.com](mailto:enquiries@jorgensenturner.com)

<https://www.jorgensenturner.com/>

### Disclaimer

These particulars, whilst believed to be accurate are set out as a general outline only for guidance and do not constitute any part of an offer or contract. Intending purchasers should not rely on them as statements of representation of fact, but must satisfy themselves by inspection or otherwise as to their accuracy. No person in this firms employment has the authority to make or give any representation or warranty in respect of the property.