



jt | JORGENSENTURNER



Woodstock Grove,  
Shepherds Bush, London

£1,900 Per Month

1 1 1 C

# Woodstock Grove, Shepherds Bush, London

£1,900 Per Month



## Summary Description

Jorgensen Turner Estate Agents proudly present this charming apartment newly available to the market. This one-bedroom Victorian period conversion at Woodstock Grove, W12, blends historic character with modern conveniences, offering a unique and delightful London home.

Spanning 473sqft, this property features a practical layout with light wood laminate flooring in the hallway and living room, a cosy carpeted bedroom, and tiled kitchen and bathroom floors. The galley-style kitchen is equipped with modern appliances and ample storage, designed for both practicality and style. The living area, with its built-in shelves and decorative fireplace, adds a touch of character to the functional design. The sleek bathroom features a pristine white suite, ensuring a high standard of presentation throughout.

Adding to its appeal is the private courtyard garden, paved with stone slabs and surrounded by brick walls and wooden lattice panels, providing a serene private outdoor escape. The apartment is offered furnished while allowing for personalisation to create your perfect home.

Located in the vibrant Shepherd's Bush neighbourhood, this property benefits from easy access to the diverse amenities and excellent transport links of the area. Notable nearby attractions include the Westfield London Shopping Centre and O2 Shepherd's Bush Empire, all within walking distance. The neighbourhood is family-friendly with parks, shops, cafes, and excellent transport links, making it a dynamic and appealing locale for both families and young professionals.

The property's secure entrance and whitewashed exterior walls ensure safety and privacy, completing this delightful London home. Available for viewings now and ready to welcome new residents from mid-August.

Council Tax Band B—Hammersmith and Fulham.

Deposit: One weeks' rent to reserve, with a security deposit of either 5 weeks' rent (for properties under £50,000pa) or 6 weeks' rent (for those over £50,000pa).

## Area Map

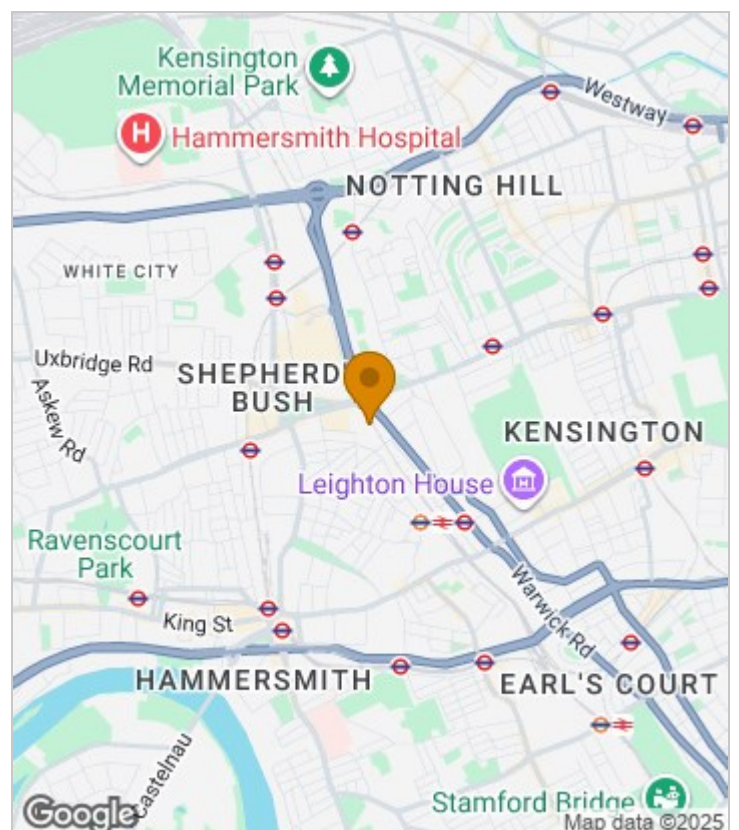



# Floor Plan

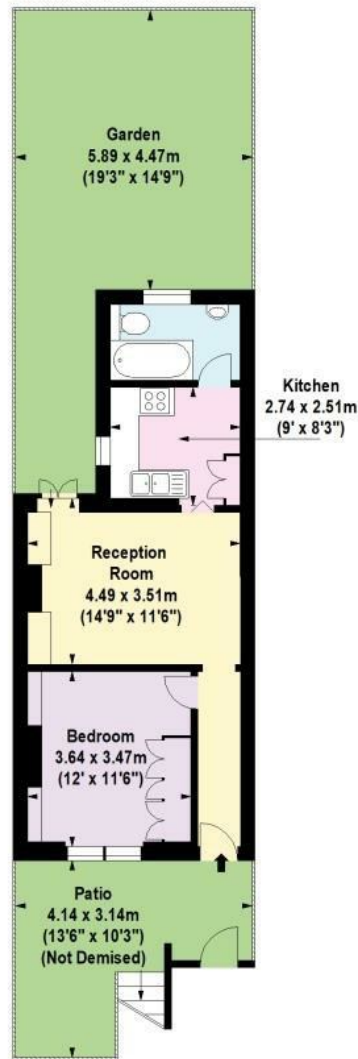

Lower Ground Floor



For Identification Purposes Only. Not To Scale. © www.totalvista.uk 2023

Woodstock Grove, W12

Approx. Gross Internal Area  
43.94 Sq M - 473 Sq Ft



## Energy Efficiency Graph

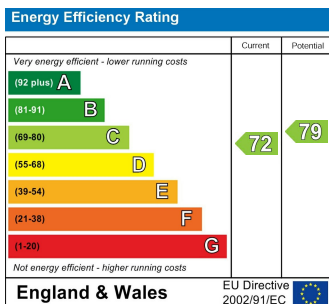

## Viewing

Please contact our Lettings SB Office on 0208 740 8740 if you wish to arrange a viewing appointment for this property or require further information.

- VICTORIAN PERIOD CONVERSION
- MODERN GALLEY-STYLE KITCHEN
- PRIVATE COURTYARD GARDEN
- EXCELLENT TRANSPORT LINKS FOR EASY COMMUTING
- PRISTINE LIGHT WOOD LAMINATE FLOORING
- BUILT-IN SHELVING
- FAMILY-FRIENDLY AREA WITH PARKS AND CAFES
- SECURE ENTRANCE FOR PRIVACY AND SAFETY

For further information contact:

Lettings SB, 234 Uxbridge Road, Shepherds Bush, London, W12 7JD

Tel: 0208 740 8740 Email: [enquiries@jorgensenturner.com](mailto:enquiries@jorgensenturner.com)

<https://www.jorgensenturner.com/>

### Disclaimer

These particulars, whilst believed to be accurate are set out as a general outline only for guidance and do not constitute any part of an offer or contract. Intending purchasers should not rely on them as statements of representation of fact, but must satisfy themselves by inspection or otherwise as to their accuracy. No person in this firm's employment has the authority to make or give any representation or warranty in respect of the property.

