



jorgensenturner
estate agents



Sharp House, Shepherds
Bush, W12

£2,300 Per Month



1 1 1

Sharp House, Shepherds Bush, W12

£2,300 Per Month



Summary Description

****NEW TO THE MARKET**** Jorgensen Turner is excited to present a luxurious one-bedroom apartment in this modern setting. Every inch of this residence has been thoughtfully designed, from its spacious open-plan kitchen and reception area to its meticulous interior details. The comfortable double bedroom comes with handy built-in wardrobes, while a private balcony provides a slice of outdoor serenity, not forgetting that the bathroom comes with installed underfloor heating. Life access, a security entry phone, and a tastefully designed internal courtyard. furnished for comfort and available mid May .A swift walk to Goldhawk Road tube station and close to attractions like the Westfield Shopping Centre and Shepherds Bush Central line station,

Council Tax Band: D - H&F Deposit:

A holding deposit of 1 weeks' rent will be required to secure the property and a security deposit of 5 weeks' rent.

Area Map

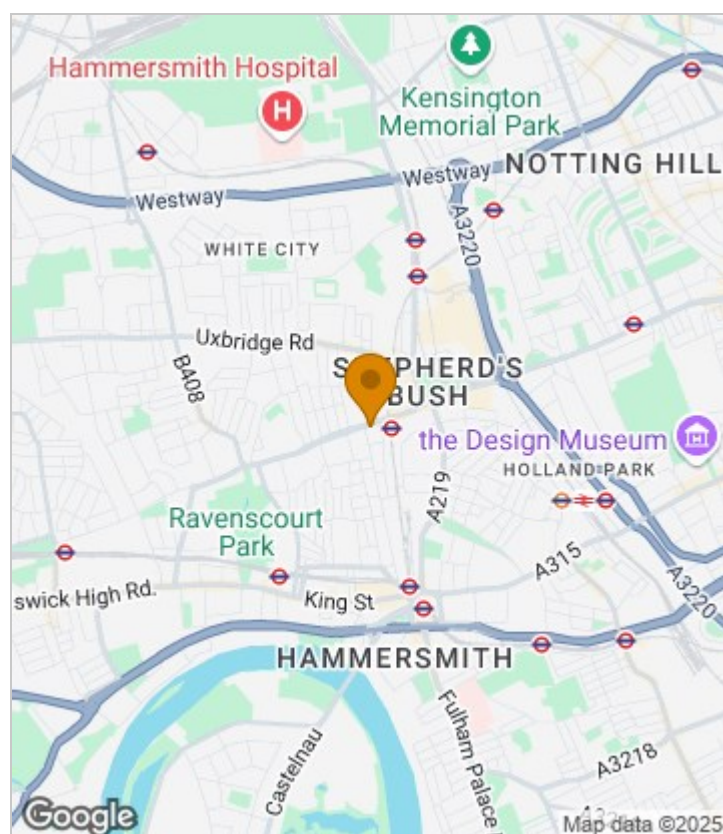

Floor Plan

Sharp House, Goldhawk Road, W12

Approx. Gross Internal Area *
503 Sq Ft - 46.73 Sq M

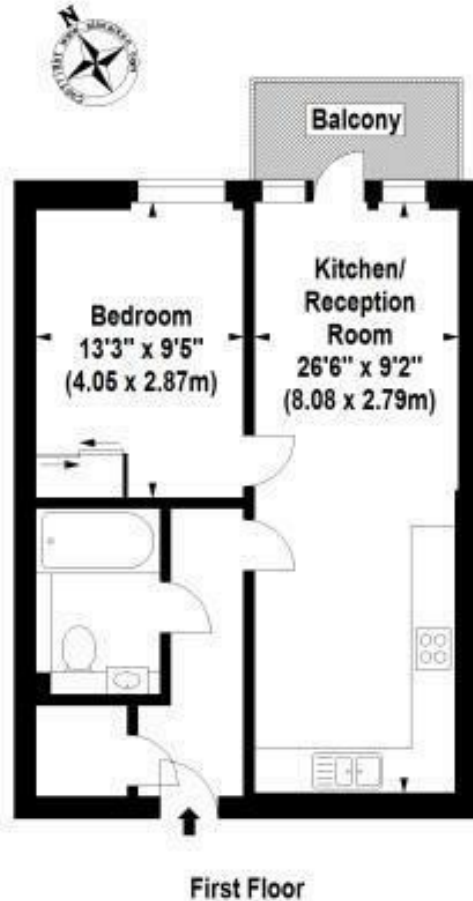
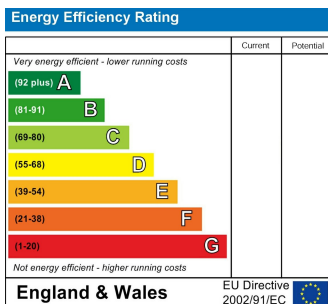

Illustration For Identification Purposes Only, Not To Scale
*Floorplan Drawn According To RICS Guidelines
© www.alanaiken.com 2016

Energy Efficiency Graph



Viewing

Please contact our Lettings SB Office on 0208 740 8740 if you wish to arrange a viewing appointment for this property or require further information.

- MODERN AND STYLISH
- FURNISHED
- BALCONY
- CLOSE TO TUBE STATIONS
- AVAILABLE 12TH MAY 2025

For further information contact:

Lettings SB, 234 Uxbridge Road, Shepherds Bush, London, W12 7JD

Tel: 0208 740 8740 Email: enquiries@jorgensenturner.com

<https://www.jorgensenturner.com/>

Disclaimer

These particulars, whilst believed to be accurate are set out as a general outline only for guidance and do not constitute any part of an offer or contract. Intending purchasers should not rely on them as statements of representation of fact, but must satisfy themselves by inspection or otherwise as to their accuracy. No person in this firm's employment has the authority to make or give any representation or warranty in respect of the property.

