



Abdale Road, Shepherds
Bush, W12

£2,100 Per Month

 2  1  1  D

Abdale Road, Shepherds Bush, W12

£2,100 Per Month



Summary Description

Jorgensen Turner Estate Agents are delighted this TWO double bedroom with extra loft room, which is a perfect work from home space.

The main floor features a warm reception area leading to an open-plan kitchen, perfect for both casual dining and hosting guests. Two well-proportioned double bedrooms add to the feel of this level, each space thoughtfully designed to maximise comfort and style.

An additional highlight of this unique property is the versatile loft room on the upper level, providing ample opportunity for personalisation—be it a home office, a cosy lounge, or even additional storage. This level also includes additional eaves storage.

Council Tax Band C—Hammersmith & Fulham.

Deposit: One weeks' rent to reserve, with a security deposit of either 5 weeks' rent (for properties under £50,000pa) or 6 weeks' rent (for those over £50,000pa).

Area Map

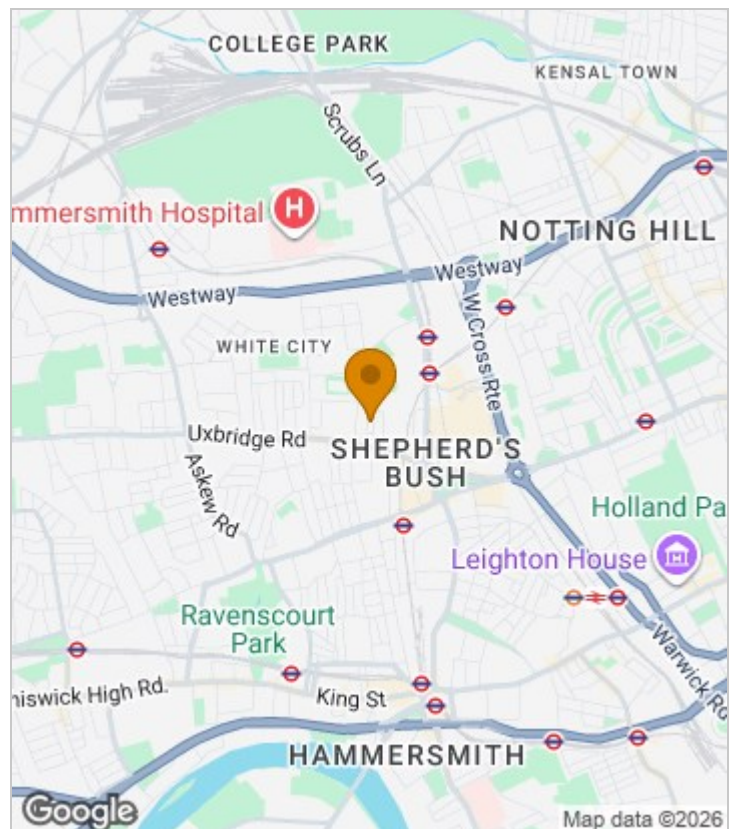



Floor Plan

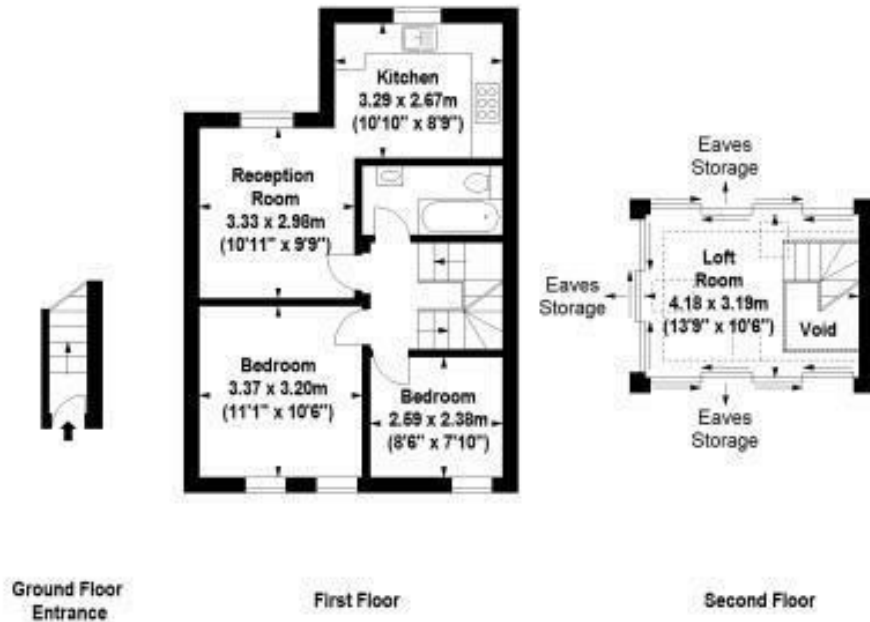

For Identification Purposes Only. Not To Scale. © www.alanaiken.com 2016



Abdale Road, W12

Approx. Gross Internal Area
49.24 Sq M - 530 Sq Ft
Approx. Gross Loft Room Area
13.47 Sq M - 145 Sq Ft

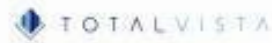

Energy Efficiency Graph

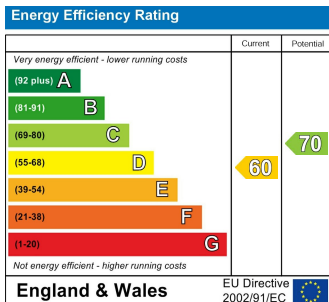

Viewing

Please contact our Lettings SB Office on 0208 740 8740 if you wish to arrange a viewing appointment for this property or require further information.

- FANTASTIC LOCATION
- FURNISHED
- MODERN OPEN-PLAN KITCHEN
- AVAILABLE
- IDEAL FOR SHARERS OR COUPLES
- SPLIT-LEVEL APARTMENT
- 675qft OF SPACE
- TWO BEDROOMS + OPEN LOFT
- CLOSE TO LOCAL TRANSPORT
- CLOSE TO WESTFIELD WHITE CITY

For further information contact:

Lettings SB, 234 Uxbridge Road, Shepherds Bush, London, W12 7JD

Tel: 0208 740 8740 Email: enquiries@jorgensenturner.com

<https://www.jorgensenturner.com/>

Disclaimer

These particulars, whilst believed to be accurate are set out as a general outline only for guidance and do not constitute any part of an offer or contract. Intending purchasers should not rely on them as statements of representation of fact, but must satisfy themselves by inspection or otherwise as to their accuracy. No person in this firm's employment has the authority to make or give any representation or warranty in respect of the property.