

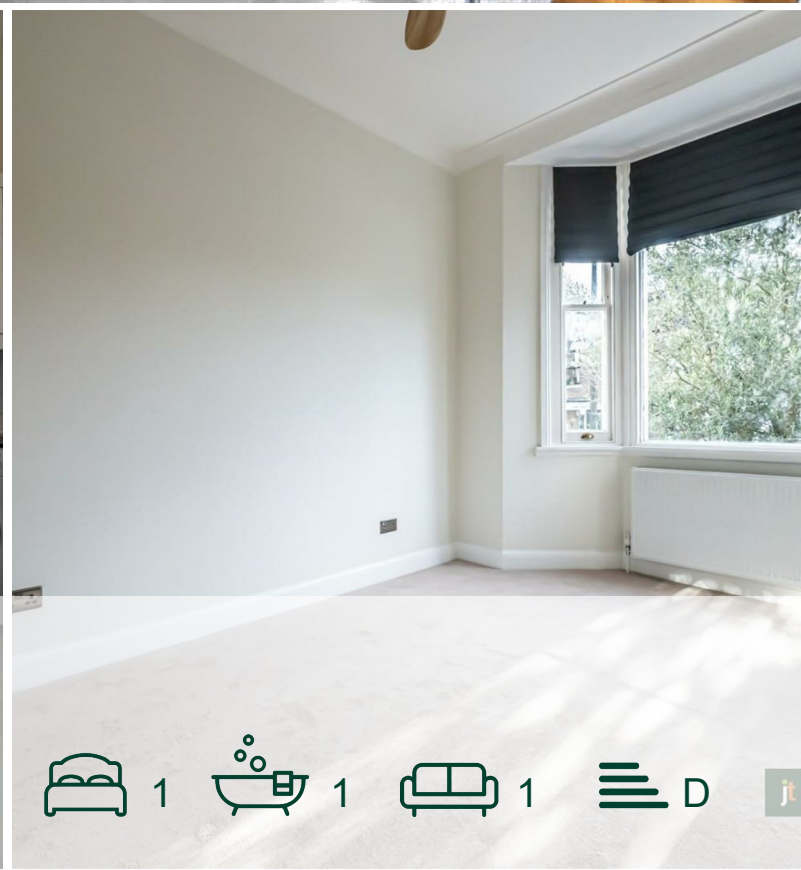

Shakespeare Road,
London

£1,700 Per Month



jt |  1  1  1  D jt

Shakespeare Road, London

£1,700 Per Month



Summary Description

Jorgensen Turner Estate Agents are delighted to introduce this elegantly reimagined ground-floor period conversion in the heart of Acton, West London. Spanning a comfortable 473sqft, this one-bedroom apartment has been meticulously designed by a professional interior designer, offering a seamless blend of style and usability.

At the core of this charming home is a separate, modern kitchen, tailored for both daily convenience and special occasions. The living room, bathed in natural sunlight, provides a welcoming space for relaxation and unwinding after a long day in the office. The apartment also features a well-appointed bathroom, boasting contemporary finishes from top to bottom.

One of the highlights of this beautiful home is its private, landscaped garden. This urban haven invites residents to enjoy peaceful moments amidst the vibrancy of city life. Additionally, the property's prime location in a friendly and diverse community is just moments away from the lush greenery of Acton Park and the bustling Oaks shopping centre.

Perfectly positioned to take advantage of Acton's excellent transport links, this property offers the ideal combination of urban convenience and suburban serenity. Offered on a part furnished basis, it presents a unique opportunity for personalisation, making it not just a house, but a home to be cherished.

Council Tax Band C—Ealing.

Deposit: One weeks' rent to reserve, with a security deposit of either 5 weeks' rent (for properties under £50,000pa) or 6 weeks' rent (for those over £50,000pa).

Area Map

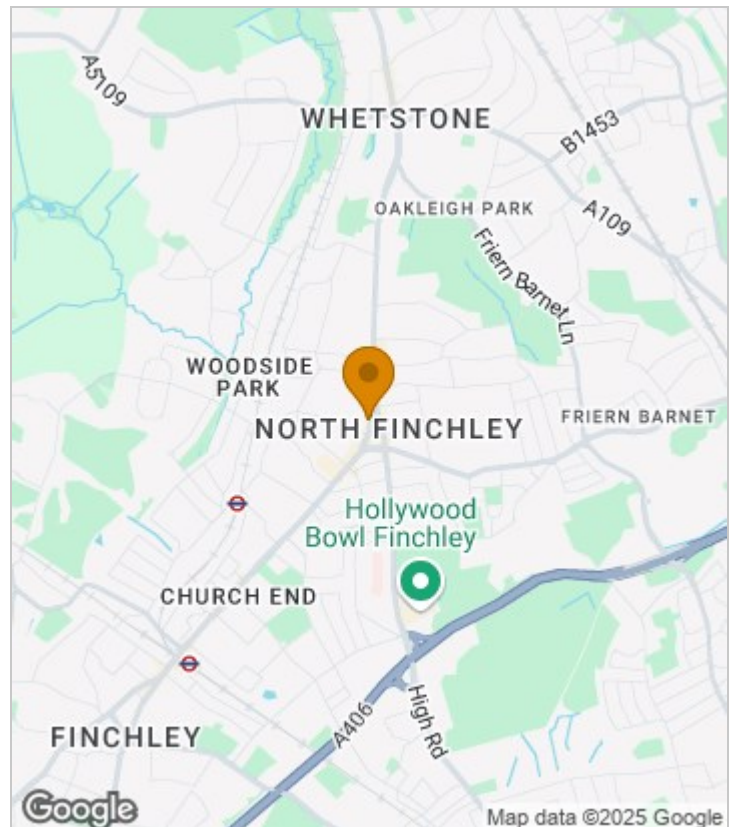



Floor Plan

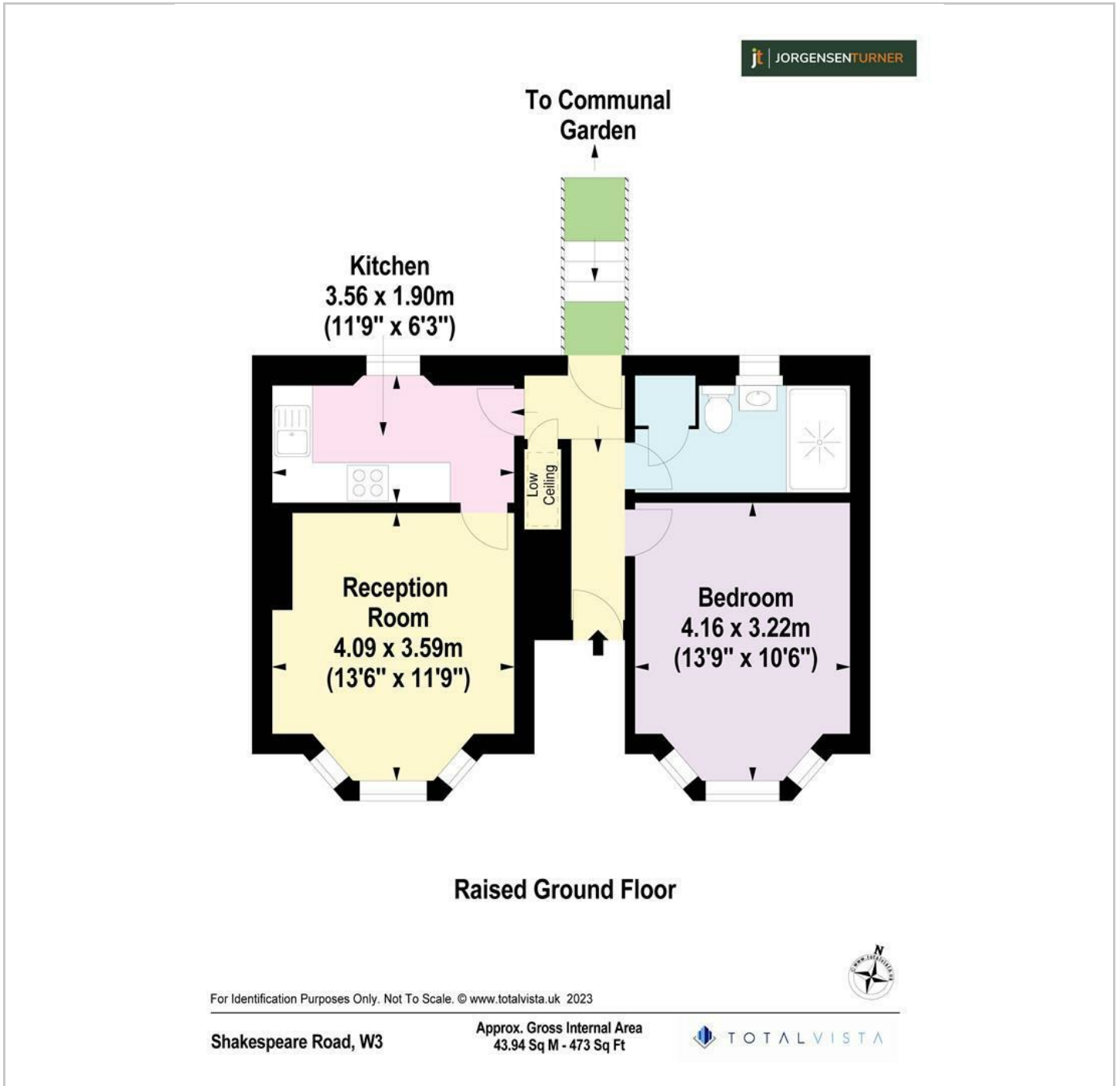

Energy Efficiency Graph

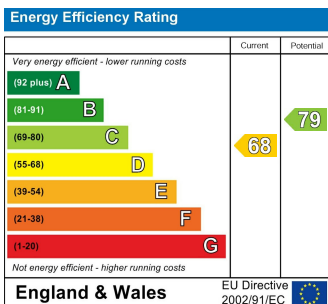

Viewing

Please contact our Lettings SB Office on 0208 740 8740 if you wish to arrange a viewing appointment for this property or require further information.

- FINISHED BY A PROFESSIONAL INTERIOR DESIGNER
- SEPARATE CONTEMPORARY KITCHEN
- BEAUTIFULLY FINISHED BATHROOM
- LOCATED IN A PRIME NEIGHBOURHOOD
- EASY CITY ACCESSIBILITY
- SPACIOUS LIVING THROUGHOUT
- SUNLIT LIVING ROOM
- PRIVATE LANDSCAPED GARDEN
- EXCELLENT CONNECTIVITY
- PEACEFUL AND QUIET FROM THE OUTSIDE WORLD

For further information contact:

Lettings SB, 234 Uxbridge Road, Shepherds Bush, London, W12 7JD

Tel: 0208 740 8740 Email: enquiries@jorgensenturner.com

<https://www.jorgensenturner.com/>

Disclaimer

These particulars, whilst believed to be accurate are set out as a general outline only for guidance and do not constitute any part of an offer or contract. Intending purchasers should not rely on them as statements of representation of fact, but must satisfy themselves by inspection or otherwise as to their accuracy. No person in this firm's employment has the authority to make or give any representation or warranty in respect of the property.

