



jt | JORGENSENTURNER



Birkbeck Avenue, Acton,  
London

£2,850 Per Month



jt 4 2 1 C jt

# Birkbeck Avenue, Acton, London

£2,850 Per Month



## Summary Description

**\*\*FURNISHED\*\*** Jorgensen Turner Estate Agents proudly present this stunning 4-bedroom Victorian conversion, newly available to the market. This beautiful property stands out with its elegant brick façade and stucco detailing, adding a touch of timeless charm to urban living.

The home showcases a high standard of presentation throughout, with a focus on spacious and bright interiors. At the heart of this residence is its modern kitchen, featuring sleek wooden cabinetry and integrated appliances—perfect for entertaining guests or enjoying stylish family dinners. The property benefits from large bay windows that flood the interior with natural light, high ceilings, and hardwood floors throughout, creating a warm and inviting atmosphere. Accompanying this are two fully-tiled bathrooms with contemporary fixtures, complemented by a versatile loft room lit by skylights—ideal as an additional bedroom or office space.

Settled on the peaceful Birkbeck Avenue in the heart of Acton, this property offers a beautiful retreat from the hustle and bustle of city life. It's ideally situated within walking distance of Acton Park and Springfield Gardens, providing green spaces for relaxation. Excellent schools such as Ark Priory Primary Academy and Twyford C of E High School are nearby, making it a convenient and desirable location for families. With easy access to the diverse amenities and excellent transport links of Acton Central and Acton Main Line, it ensures a well-connected living environment close to local attractions like The Oaks Shopping Centre and Westfield London.

The property is offered FURNISHED and is available from beginning of December.

Council Tax Band C—Ealing

Deposit: One weeks' rent to reserve, with a security deposit of either 5 weeks' rent (for properties under £50,000pa) or 6 weeks' rent (for those over £50,000pa).

## Area Map

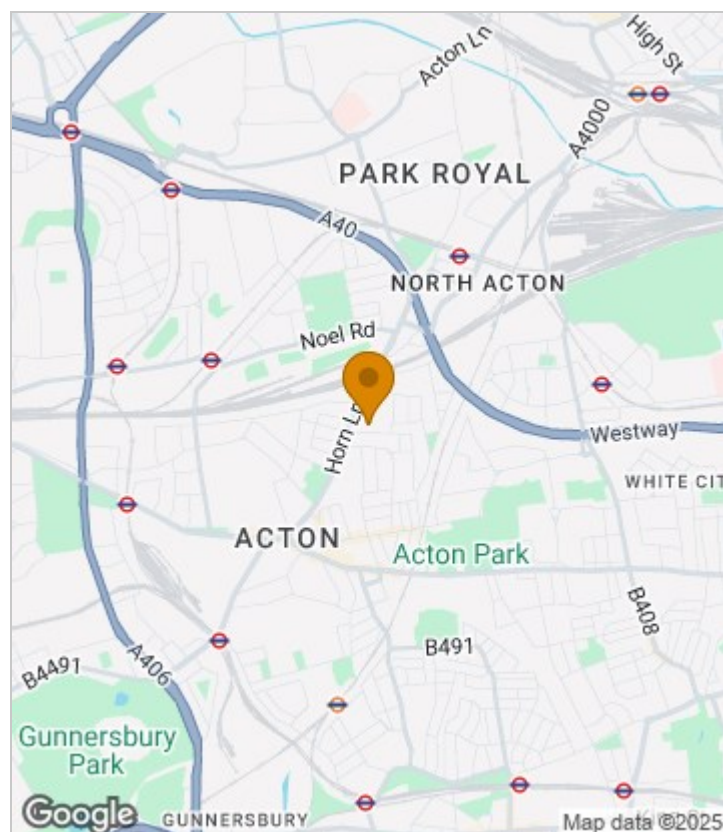



# Floor Plan

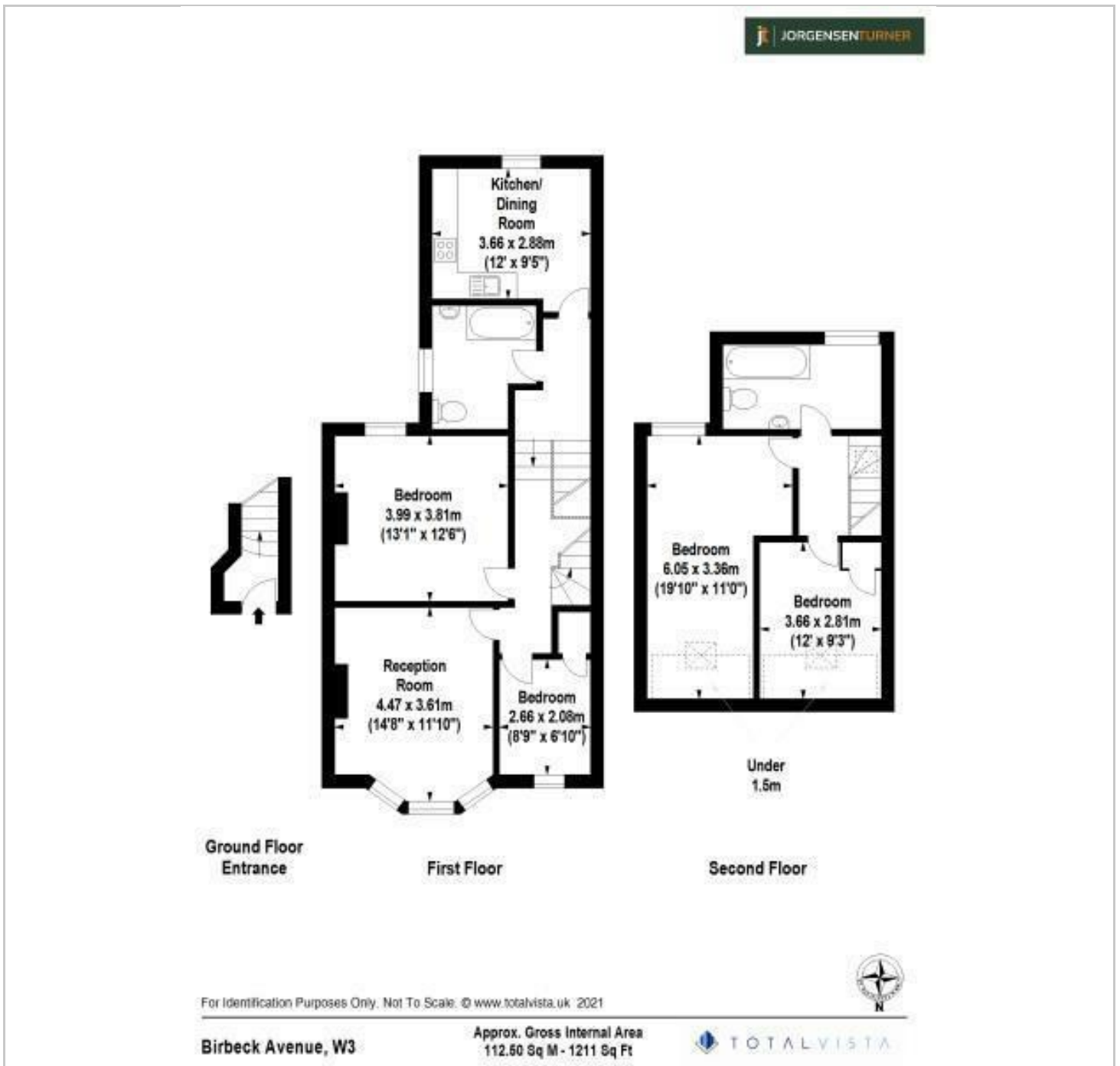

## Energy Efficiency Graph

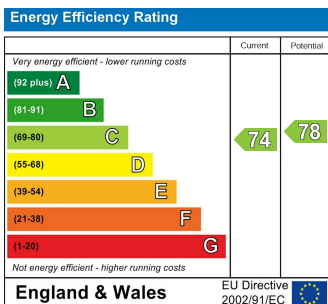

## Viewing

Please contact our Lettings SB Office on 0208 740 8740 if you wish to arrange a viewing appointment for this property or require further information.

- 4-BEDROOM VICTORIAN CONVERSION
- EASY ACCESS TO TRANSPORT LINKS
- SPACIOUS AND BRIGHT THROUGHOUT
- MODERN KITCHEN WITH INTEGRATED APPLIANCES
- LARGE BAY WINDOWS
- HIGH CEILINGS AND HARDWOOD FLOORS
- TWO FULLY-TILED BATHROOMS
- EXCELLENT SCHOOLS NEARBY
- PEACEFUL LOCATION
- WALKING DISTANCE TO ACTON PARK

For further information contact:

Lettings SB, 234 Uxbridge Road, Shepherds Bush, London, W12 7JD

Tel: 0208 740 8740 Email: [enquiries@jorgensenturner.com](mailto:enquiries@jorgensenturner.com)

<https://www.jorgensenturner.com/>

### Disclaimer

These particulars, whilst believed to be accurate are set out as a general outline only for guidance and do not constitute any part of an offer or contract. Intending purchasers should not rely on them as statements of representation of fact, but must satisfy themselves by inspection or otherwise as to their accuracy. No person in this firm's employment has the authority to make or give any representation or warranty in respect of the property.

