



Stowe Road, Shepherds  
Bush, W12

£1,850 Per Week



# Stowe Road, Shepherds Bush, W12

£1,850 Per Week



## Summary Description

**\*\* NEW TO THE MARKET\*\*** Jorgensen Turner estate agents Shepherds Bush are pleased to offer a spacious one double bedroom maisonette flat. This glorious property comprises a spacious and bright living room with ample natural light, a contemporary galley kitchen with integrated appliances including a dishwasher, a modern bathroom with bath and shower and a great sized double bedroom with built in wardrobes. Additional benefits include a top floor study/attic room and abundance of storage space. It is available from 24th March on a furnished basis.

Council Tax Band D—Hammersmith & Fulham.

Deposit: One weeks' rent to reserve, with a security deposit of either 5 weeks' rent (for properties under £50,000pa) or 6 weeks' rent (for those over £50,000pa).

## Area Map

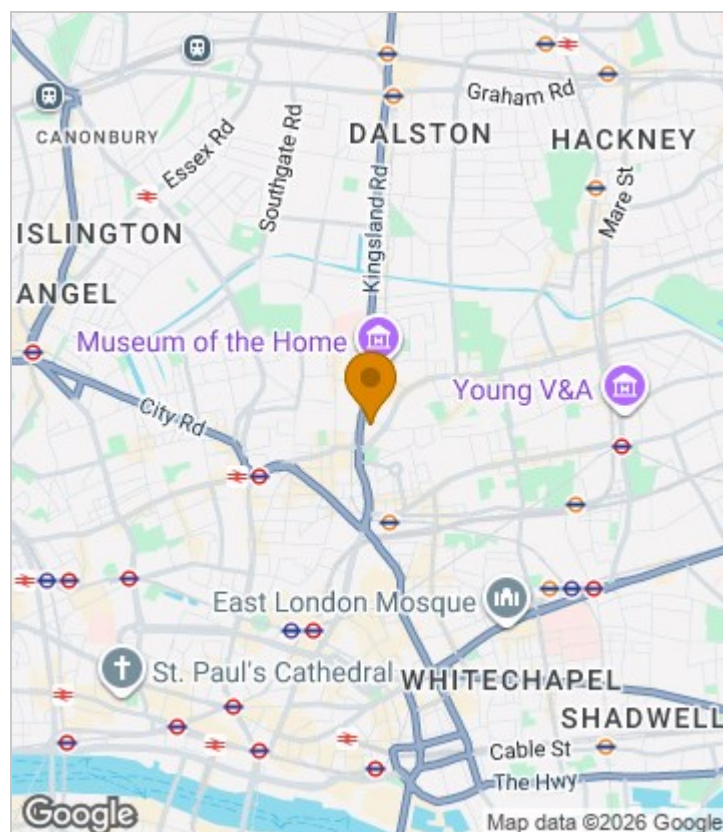



# Floor Plan

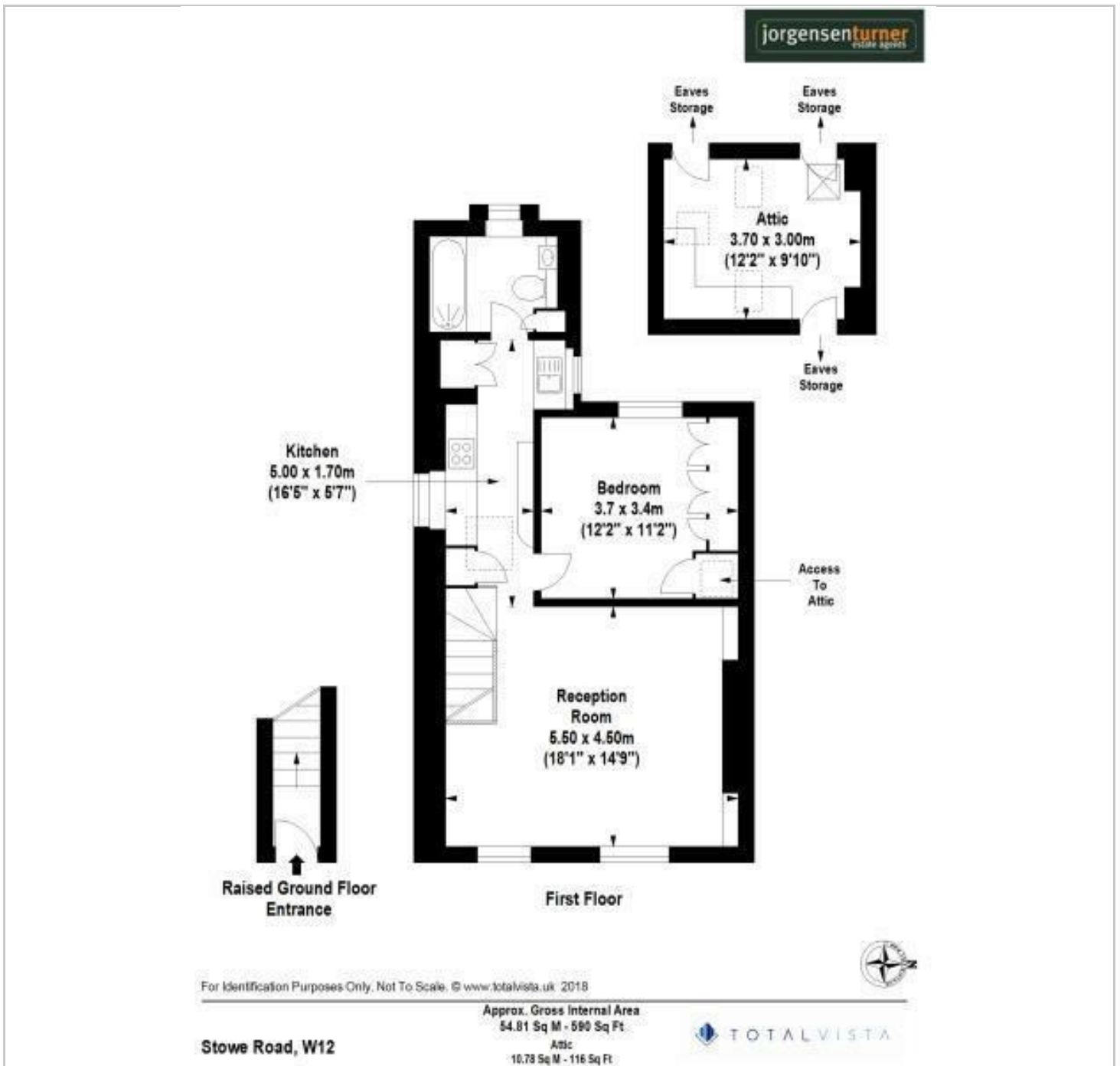

## Energy Efficiency Graph

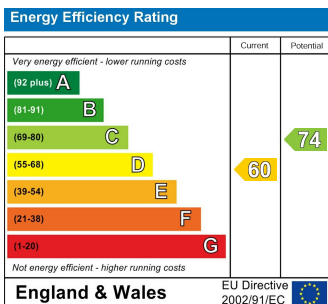

## Viewing

Please contact our Lettings SB Office on 0208 740 8740 if you wish to arrange a viewing appointment for this property or require further information.

- SPACIOUS ONE DOUBLE ROOM APARTMENT
- EXTRA LOFT ROOM
- FURNISHED
- OWN FRONT DOOR
- AVAILABLE 24TH MARCH 2025
- LOTS OF STORAGE
- MODERN KITCHEN
- QUIET TREE LINED STREET

For further information contact:

Lettings SB, 234 Uxbridge Road, Shepherds Bush, London, W12 7JD

Tel: 0208 740 8740 Email: [enquiries@jorgensenturner.com](mailto:enquiries@jorgensenturner.com)

<https://www.jorgensenturner.com/>

### Disclaimer

These particulars, whilst believed to be accurate are set out as a general outline only for guidance and do not constitute any part of an offer or contract. Intending purchasers should not rely on them as statements of representation of fact, but must satisfy themselves by inspection or otherwise as to their accuracy. No person in this firm's employment has the authority to make or give any representation or warranty in respect of the property.