



jt | JORGENSENTURNER



Blythe Road, Brook Green,
W14

£2,500 Per Month



jt | 2 1 1 D jt

Blythe Road, Brook Green, W14

£2,500 Per Month



Summary Description

****NEW TO THE MARKET**.** A wonderful split level apartment offering two double bedroom flat in the heart of Brook Green. The property offers a really spacious reception, modern fitted kitchen with fitted appliances, two double bedrooms and a modern bathroom. The property is offered part furnished and is available

Council tax band D.

A holding deposit of 1 weeks rent will be required to secure the property and a Security deposit of 5 weeks rent (for rents under £50,000 pa) or 6 weeks (for rents over £50,000 pa)

Area Map

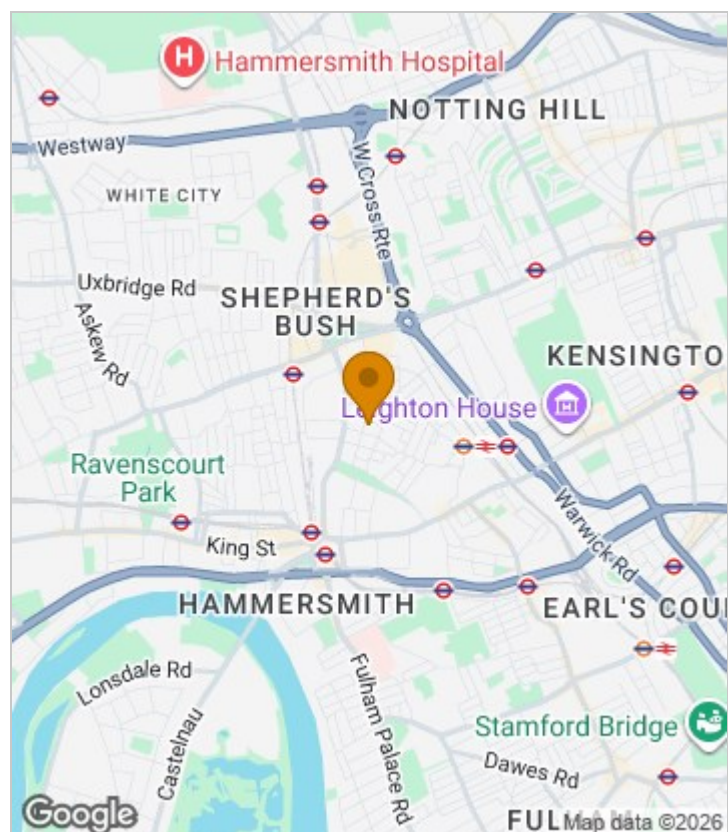



Floor Plan

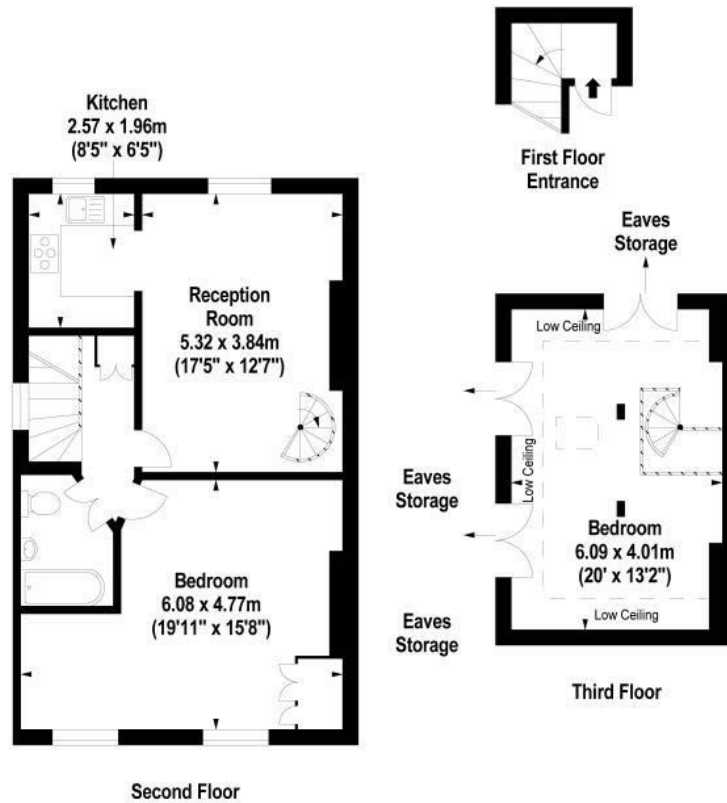

For Identification Purposes Only. Not To Scale. © www.totalvista.uk 2023

Blythe Road, W14

Approx. Gross Internal Area
88.63 Sq M - 954 Sq Ft



Energy Efficiency Graph

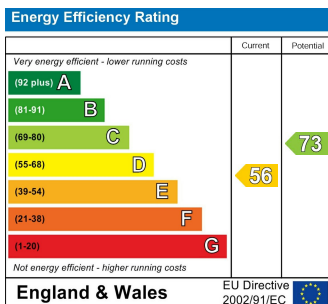

Viewing

Please contact our Lettings SB Office on 0208 740 8740 if you wish to arrange a viewing appointment for this property or require further information.

- SPLIT LEVEL APARTMENT
- PART FURNISHED
- MODERN KITCHEN
- TWO DOUBLE BEDROOM
- HEART OF BROOK GREEN
- MODERN BATHROOM

For further information contact:

Lettings SB, 234 Uxbridge Road, Shepherds Bush, London, W12 7JD

Tel: 0208 740 8740 Email: enquiries@jorgensenturner.com

<https://www.jorgensenturner.com/>

Disclaimer

These particulars, whilst believed to be accurate are set out as a general outline only for guidance and do not constitute any part of an offer or contract. Intending purchasers should not rely on them as statements of representation of fact, but must satisfy themselves by inspection or otherwise as to their accuracy. No person in this firm's employment has the authority to make or give any representation or warranty in respect of the property.