





Adam Hayes - Finchley Central Office - Sales 348 Regents Park Road, Finchley Central, London, N3 2LJ
Tel: 0208 189 6333 Email: info@adam-hayes.co.uk Web: www.adam-hayes.co.uk

Redbourne Avenue, Finchley Central, N3

OIEO £275,000

 1 Bedrooms  1 Bathrooms  1 Receptions

Key Features

- One Bedroom Apartment
- Second Floor
- Modern Seperate Kitchen
- Walking Distance To Local Shops & Transport Links
- Chain Free
- Gas Central Heating

Other Information

Tenure: Leasehold
Length of Lease: 110 Years
Ground Rent: Nil
Service Charge: £1,720.00
Council Tax Band: C

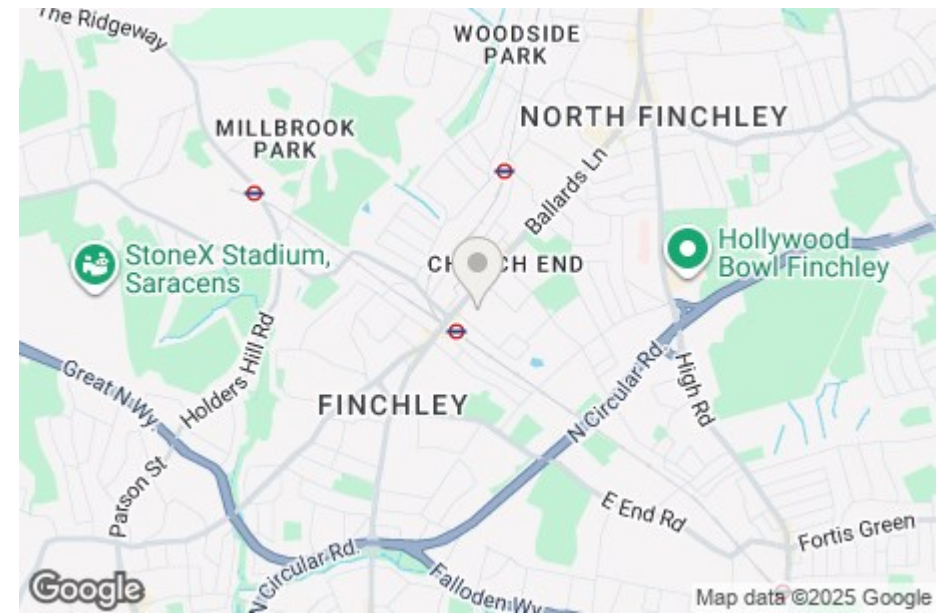

Nearest Stations

Finchley Central Station 0.1 miles
West Finchley Station 0.5 miles
Mill Hill East Station 0.9 miles

Property Description

Situated in the heart of Finchley Central, this second-floor apartment offers convenient access to Finchley Central Tube Station (Northern Line) and local amenities. The well-maintained one-bedroom property features a spacious living room of approximately 15 feet, a fully tiled bathroom, ample storage, and gas central heating. This residence presents an attractive opportunity for first-time buyers or buy-to-let investors as its sold chain free. To really appreciate the size, potential and location an internal viewing is highly recommended via vendors sole agents Adam Hayes Estate Agents.

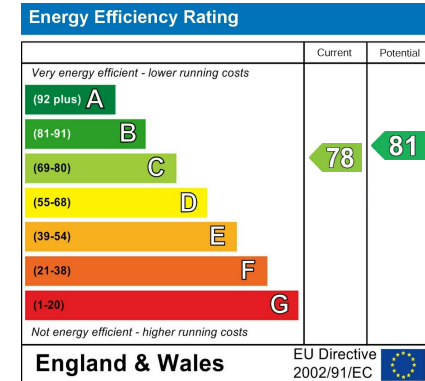

Adam Hayes - Finchley Central Office - Sales 348 Regents Park Road, Finchley Central, London, N3 2LJ

Tel: 0208 189 6333 Email: info@adam-hayes.co.uk Web: www.adam-hayes.co.uk

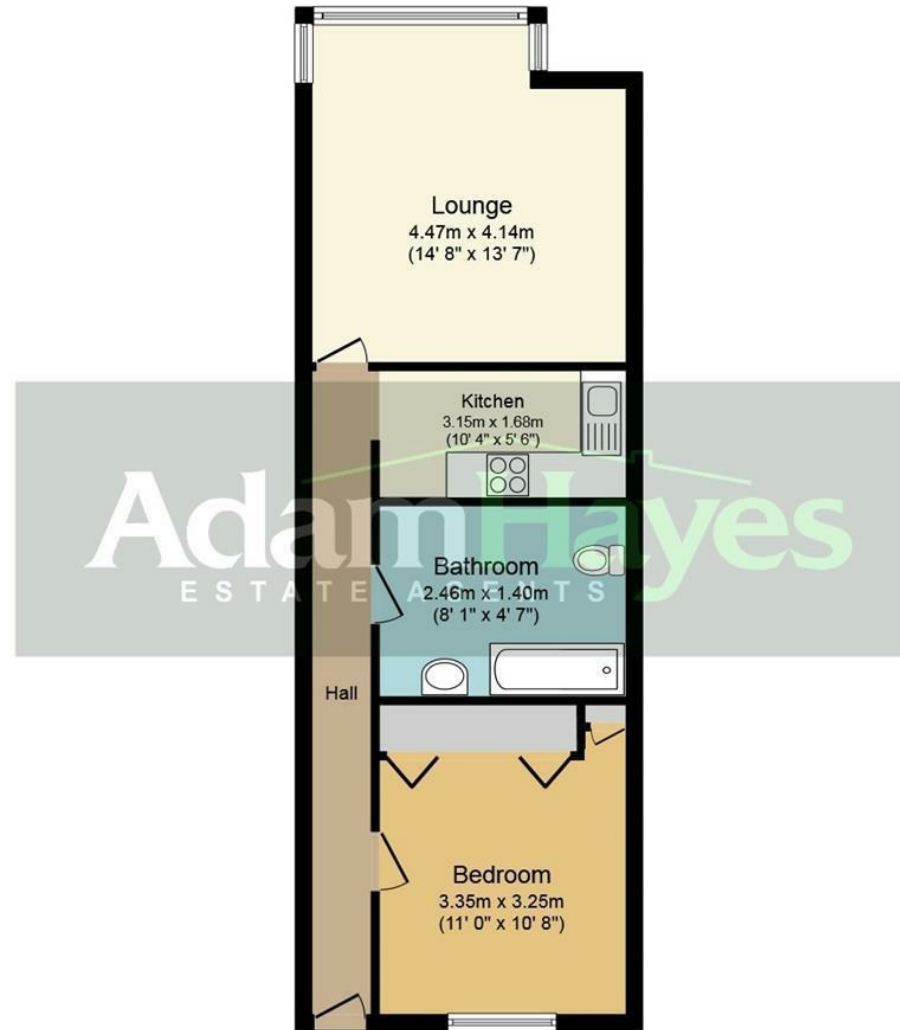

Total floor area 52.9 sq.m. (569 sq.ft.) approx

This plan is for illustration purposes only and may not be representative of the property. Plan not to scale.

These particulars, whilst believed to be accurate, are set out as a general outline only for guidance and do not constitute any part of an offer or contract. Intending purchasers or prospective tenants should not rely on them as statements or representation of fact, but must satisfy themselves by inspection or otherwise as to their accuracy. We have not carried out a detailed survey, not tested the services, appliances and specific fittings. Room sizes should not be relied upon for carpets and furnishings. The measurements given are approximate. No person in this firm's employment has the authority to make or give any representation or warranty in respect of the property.