



Lankaster Gardens, East Finchley, N2

 2 Bedrooms  2 Bathrooms  1 Reception

£150,000



Adam Hayes - East Finchley Office - Sales 158 High Road, East Finchley, London, N2 9AS  
Tel: 0208 883 2621 Email: [info@adam-hayes.co.uk](mailto:info@adam-hayes.co.uk) Web: [www.adam-hayes.co.uk](http://www.adam-hayes.co.uk)

# Lankaster Gardens, East Finchley, N2

£150,000

 2 Bedrooms  2 Bathrooms  1 Receptions

## Key Features

- Two Double Bedrooms
- Two Bathrooms (One En-Suite)
- Modern Kitchen
- Parking
- Communal Gardens
- Chain Free

## Other Information

Ownership Share: 40%  
Tenure: Leasehold  
Length of Lease: 114 Years  
Ground Rent: £250.00 P/A  
Service Charge: £2,430.00 P/A  
Rent: £570.12 PCM  
Council Tax Band: D

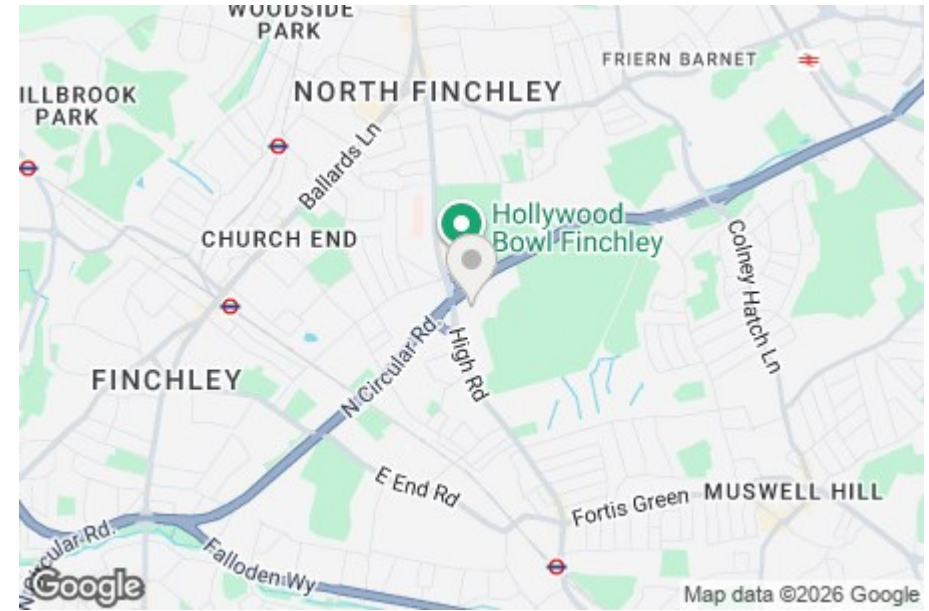

## Nearest Stations

Finchley Central Station 0.9 miles  
West Finchley Station 0.9 miles  
East Finchley Station 1.0 miles

## Property Description

40% Shared Ownership!! Located in a contemporary gated development with convenient access to local amenities and transport links, this first-floor apartment features two bedrooms and two bathrooms (one en-suite). The property boasts a modern separate kitchen, an approximately 21ft reception room, a balcony, gated underground parking, gas central heating, and double glazing throughout.

First-time buyers will need to be eligible and must have a household income is less than £80,000 a year, or less than £90,000 a year in London, not currently own a home or have a legal interest in a property not form a new household - for example, after a relationship breakdown, cant secure a mortgage or have funds to buy a share of the property and must be able to afford to buy a share of the property - based on your individual circumstances and affordability assessment. An internal viewing is highly recommended to fully appreciate the property's size, location, and condition via the vendors sole agents, Adam Hayes Estate Agents.

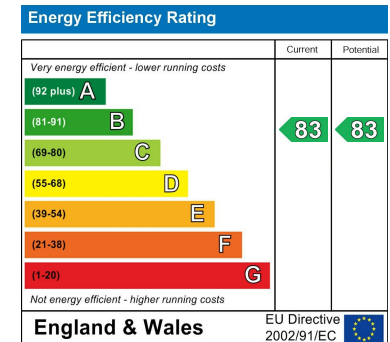

Adam Hayes - East Finchley Office - Sales 158 High Road, East Finchley, London, N2 9AS

Tel: 0208 883 2621 Email: info@adam-hayes.co.uk Web: www.adam-hayes.co.uk

**Approximate Gross Internal Area  
783 sq ft - 73 sq m**

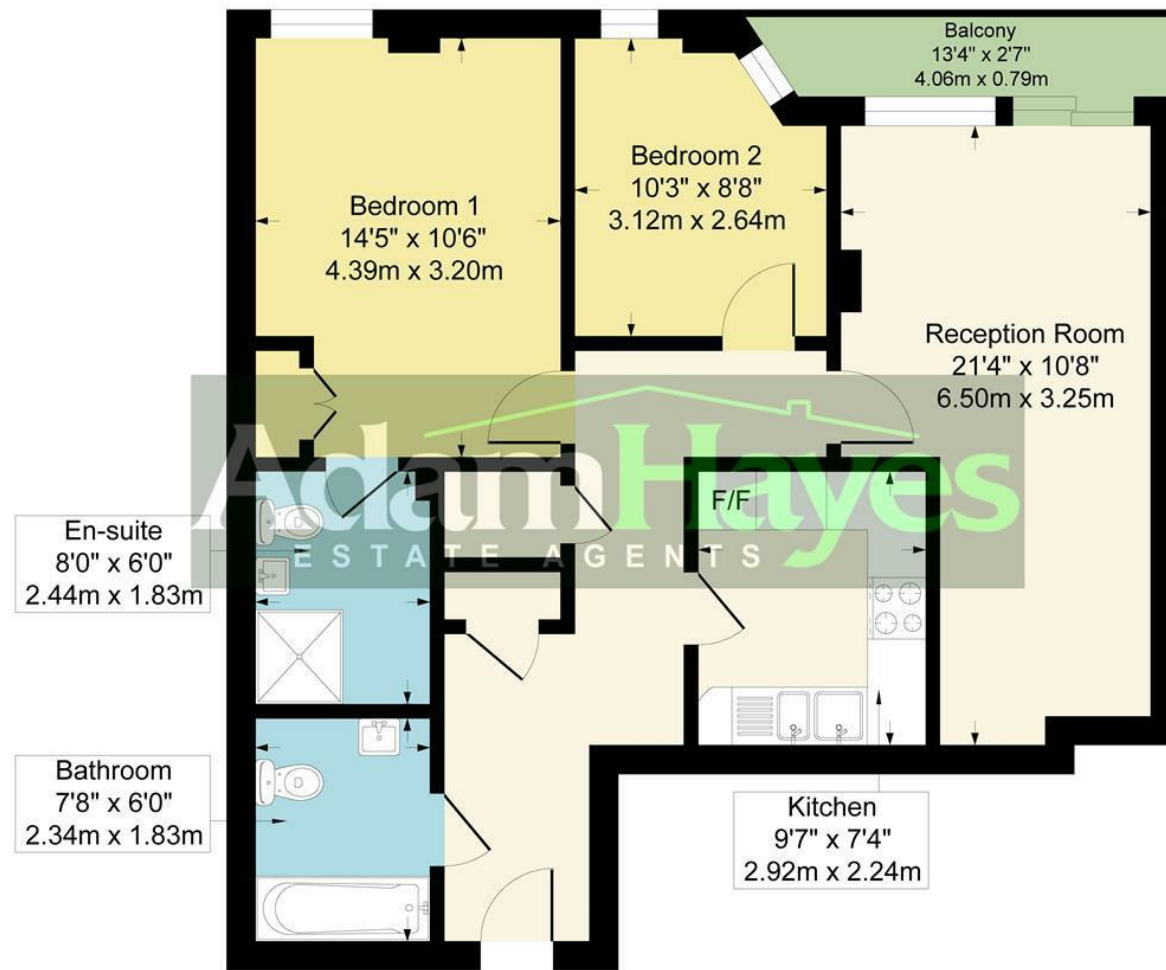

Although every attempt has been made to ensure accuracy, all measurements are approximate.  
This floorplan is for illustrative purposes only and not to scale.  
Measured in accordance with RICS Standards.

These particulars, whilst believed to be accurate, are set out as a general outline only for guidance and do not constitute any part of an offer or contract. Intending purchasers or prospective tenants should not rely on them as statements or representation of fact, but must satisfy themselves by inspection or otherwise as to their accuracy. We have not carried out a detailed survey, not tested the services, appliances and specific fittings. Room sizes should not be relied upon for carpets and furnishings. The measurements given are approximate. No person in this firm's employment has the authority to make or give any representation or warranty in respect of the property.