

Adam Hayes - East Finchley Office - Sales 158 High Road, East Finchley, London, N2 9AS  
Tel: 0208 883 2621 Email: [info@adam-hayes.co.uk](mailto:info@adam-hayes.co.uk) Web: [www.adam-hayes.co.uk](http://www.adam-hayes.co.uk)

# Lankaster Gardens, East Finchley, N2

£340,000

 1 Bedrooms  1 Bathrooms  1 Receptions

## Key Features

- One Double Bedroom
- Top Floor Apartment
- Open Plan Kitchen
- Modern Bathroom
- Stunning Private Terrace
- Allocated Underground Parking

## Other Information

Tenure: Leasehold  
Length of Lease: 111 Years  
Ground Rent: £250.00 P/A  
Service Charge: £1,922.22 P/A  
Council Tax Band: C

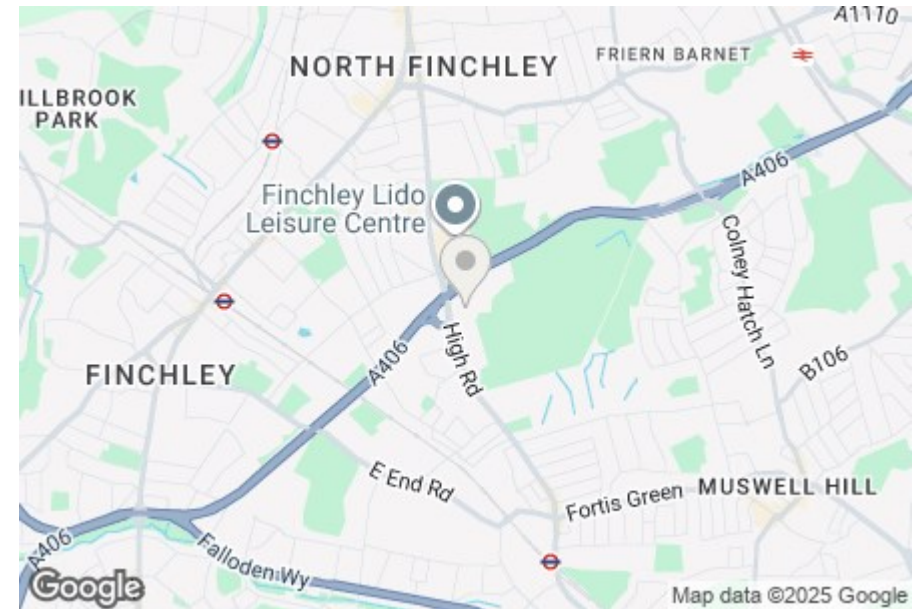

## Nearest Stations

Finchley Central Station	0.9 miles
West Finchley Station	1.0 miles
East Finchley Station	1.0 miles

## Property Description

Situated in this sought after gated development is this stunning one double bedroom top floor apartment. The property benefits from an approx. 15'9 ft reception room with an open plan kitchen and direct access onto a stunning south-east facing terrace which also accesses the bedroom. Other notable features include ample storage, fitted wardrobes in the bedroom, double glazed windows, and a modern three piece bathroom. This home is best suited to First Time Buyers or Buy to Let investors and further benefits from a use of communal gardens and allocated off street parking. To really appreciate the size, location and condition of the property, an internal viewing is highly recommended through the vendors sole agents, Adam Hayes Estate Agents.

Adam Hayes - East Finchley Office - Sales 158 High Road, East Finchley, London, N2 9AS

Tel: 0208 883 2621 Email: [info@adam-hayes.co.uk](mailto:info@adam-hayes.co.uk) Web: [www.adam-hayes.co.uk](http://www.adam-hayes.co.uk)



**Approximate Gross Internal Area = 516 sq ft - 48 sq m**

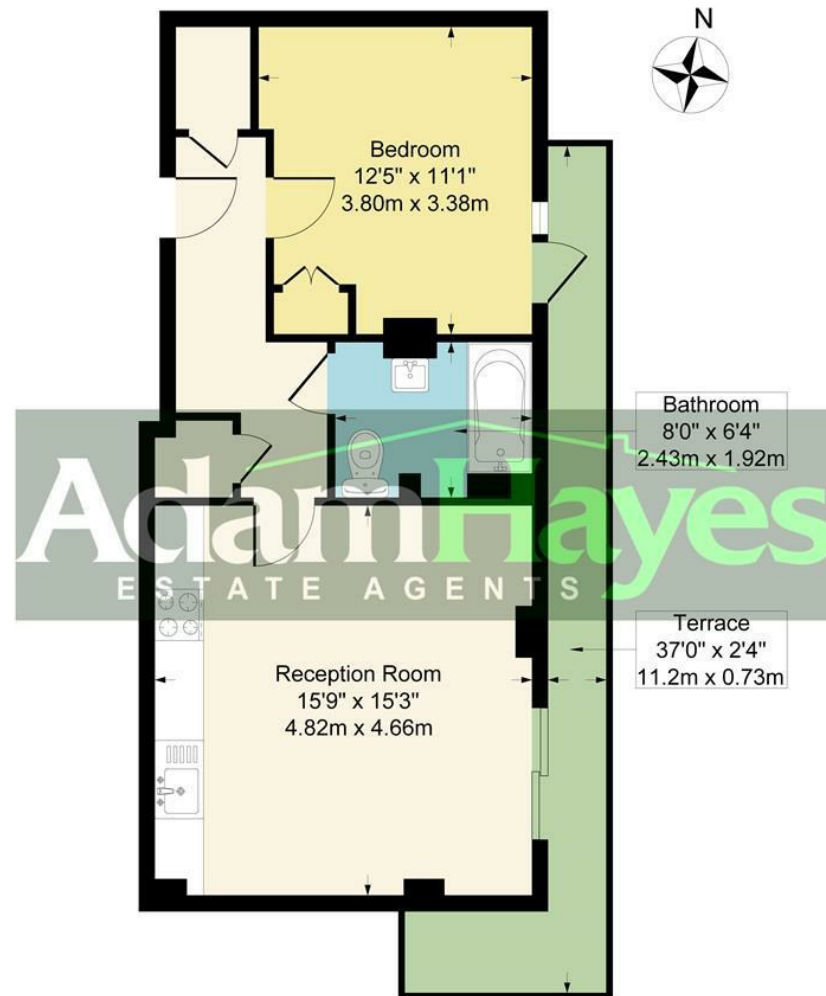

Although every attempt has been made to ensure accuracy, all measurements are approximate.  
This floorplan is for illustrative purposes only and not to scale.  
Measured in accordance with RICS Standards.

These particulars, whilst believed to be accurate, are set out as a general outline only for guidance and do not constitute any part of an offer or contract. Intending purchasers or prospective tenants should not rely on them as statements or representation of fact, but must satisfy themselves by inspection or otherwise as to their accuracy. We have not carried out a detailed survey, not tested the services, appliances and specific fittings. Room sizes should not be relied upon for carpets and furnishings. The measurements given are approximate. No person in this firm's employment has the authority to make or give any representation or warranty in respect of the property.