

Adam Hayes - East Finchley Office - Sales 158 High Road, East Finchley, London, N2 9AS

Tel: 0208 883 2621 Email: info@adam-hayes.co.uk Web: www.adam-hayes.co.uk

Creighton Court, East Finchley, N2 9BS

£550,000

 2 Bedrooms  1 Bathrooms  1 Receptions

Key Features

- First Floor Maisonette
- Two Double Bedrooms
- Approximately 15ft Reception
- Modern Kitchen
- Own section of Garden

Other Information

Tenure: Leasehold
Length of Lease: n/a
Ground Rent: n/a
Service Charge: n/a
Service Review Period: n/a
Council Tax Band:

Nearest Stations

-
-
-

Property Description

Available to the market is this TWO DOUBLE BEDROOM first floor MAISONETTE with own section of the GARDEN situated in this sought after location off East Finchley. Just off the East Finchley High Road and within walking distance to the local shops and EAST FINCHLEY TUBE STATION (ZONE 3) the property is located in a fantastic position with easy access to all local amenities. The property benefits from a MODERN KITCHEN with integrated appliances, MODERN BATHROOM, an approximately 15ft RECEPTION ROOM, gas central heating and double glazing. Available on a chain free basis to really appreciate the size, location and condition an internal viewing is highly recommended via Adam Hayes Estate Agents.

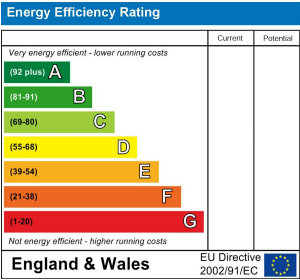

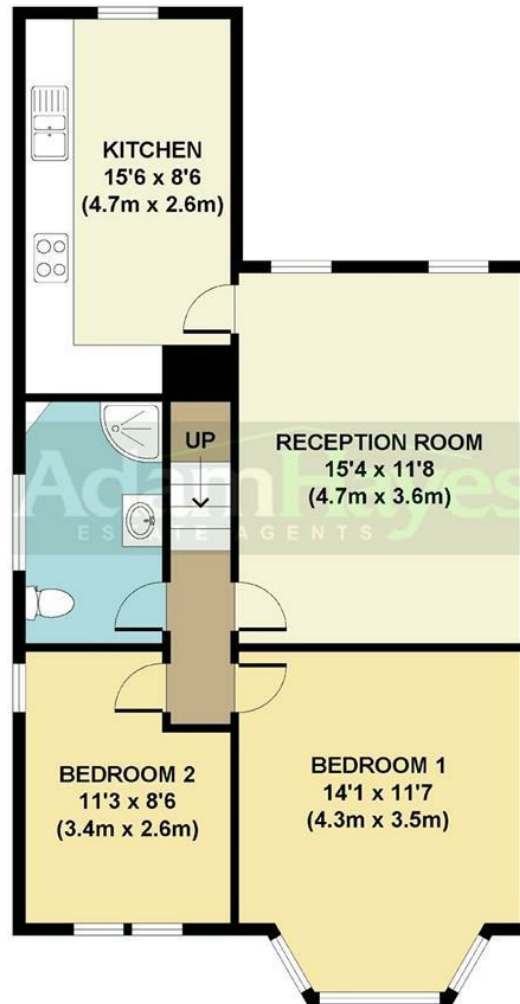

GROSS INTERNAL
FLOOR AREA 661 SQ FT

APPROX. GROSS INTERNAL FLOOR AREA 661 SQ FT / 61 SQ M
Floorplans are for identification and guideline purposes only, not to scale.
Compliant with RICS code of measuring practice.
Floorplans supplied by www.draftingfloorplan.com

These particulars, whilst believed to be accurate, are set out as a general outline only for guidance and do not constitute any part of an offer or contract. Intending purchasers or prospective tenants should not rely on them as statements or representation of fact, but must satisfy themselves by inspection or otherwise as to their accuracy. We have not carried out a detailed survey, not tested the services, appliances and specific fittings. Room sizes should not be relied upon for carpets and furnishings. The measurements given are approximate. No person in this firm's employment has the authority to make or give any representation or warranty in respect of the property.