





Adam Hayes - East Finchley Office - Sales 158 High Road, East Finchley, London, N2 9AS

Tel: 0208 883 2621 Email: info@adam-hayes.co.uk Web: www.adam-hayes.co.uk

Taunton Drive, East Finchley, N2

£220,000

0 Bedrooms 1 Bathrooms 1 Receptions

Key Features

- Ground Floor Studio Apartment
- Chain Free
- Separate Kitchen
- Extended Lease
- Off Street Parking
- Ideal Opportunity for First Time Buyers or Buy To Let Investors

Nearest Stations

East Finchley Station	0.8 miles
Finchley Central Station	0.8 miles
West Finchley Station	1.1 miles

Property Description

Situated in this popular purpose-built development off Oak Lane and within easy reach of East Finchley Tube Station is this ground floor studio flat. The property is offered chain-free and benefits from a bright lounge leading into a separate modern fitted kitchen, followed by a three-piece bathroom, access to communal gardens, off-street parking and an extended long lease. The apartment is situated with excellent transport links and a range of local amenities close by and an ideal choice for first-time buyers, investors, or professionals looking for a well-connected yet relaxing home. To fully appreciate the size, location, and condition, an internal viewing is highly recommended through the vendor’s sole agents, Adam Hayes Estate Agents.

Other Information

Tenure: Leasehold
Length of Lease: 150 Years
Ground Rent: £80.00 P/A
Service Charge: £1,875.00 P/A
Service Review Period: n/a
Council Tax Band: B

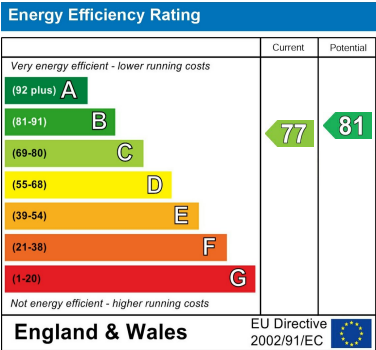
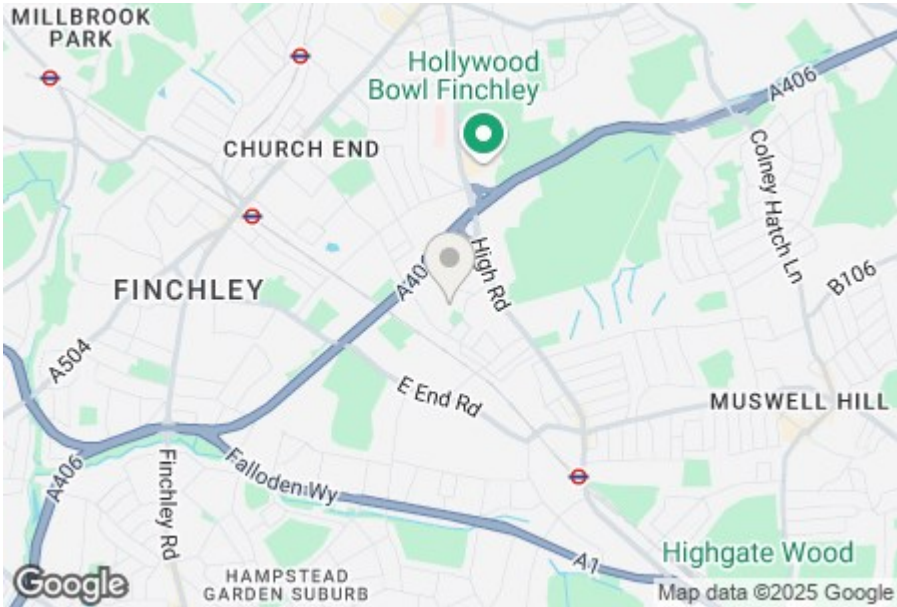

Approximate Gross Internal Area
327 sq ft - 30 sq m

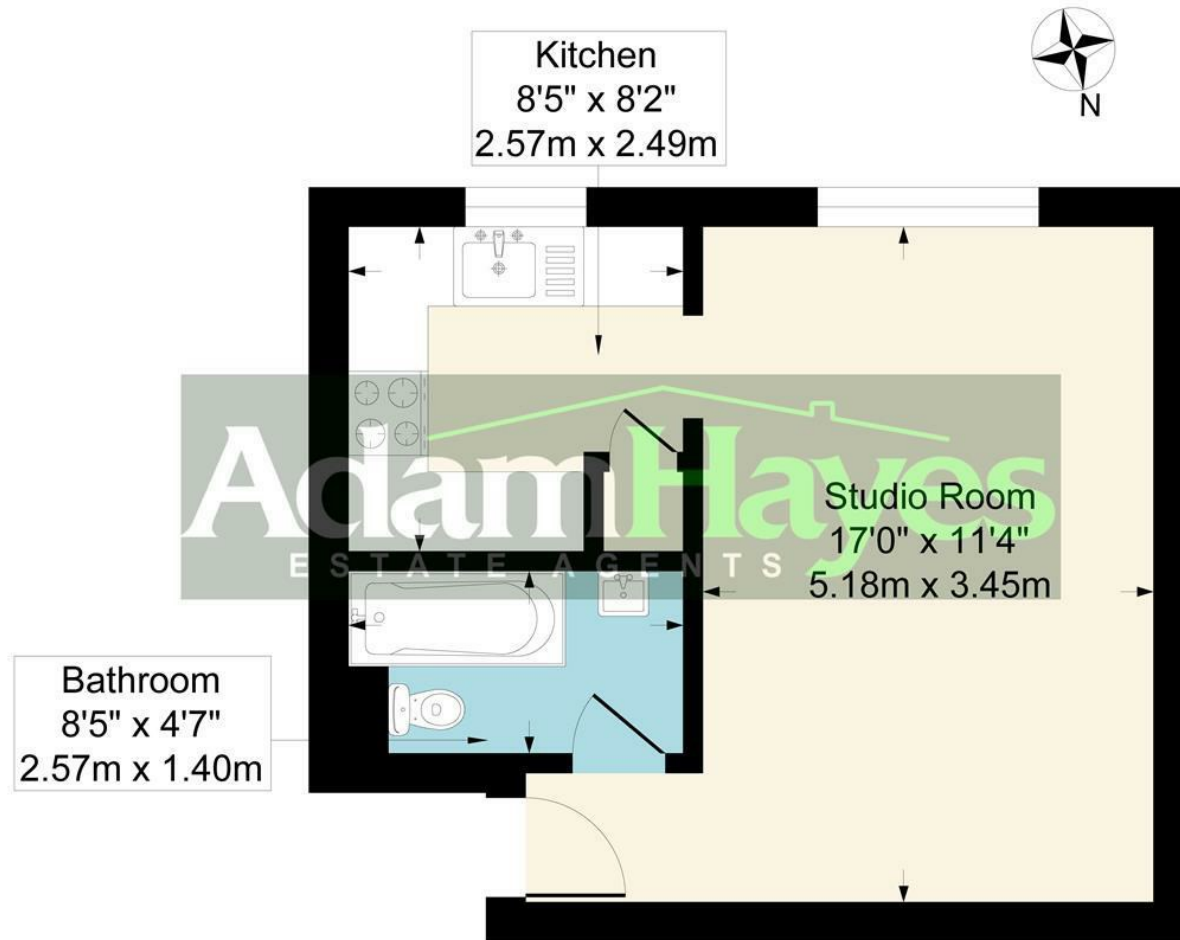

Ground Floor

Although every attempt has been made to ensure accuracy, all measurements are approximate.
This floorplan is for illustrative purposes only and not to scale.
Measured in accordance with RICS Standards.

These particulars, whilst believed to be accurate, are set out as a general outline only for guidance and do not constitute any part of an offer or contract. Intending purchasers or prospective tenants should not rely on them as statements or representation of fact, but must satisfy themselves by inspection or otherwise as to their accuracy. We have not carried out a detailed survey, not tested the services, appliances and specific fittings. Room sizes should not be relied upon for carpets and furnishings. The measurements given are approximate. No person in this firm's employment has the authority to make or give any representation or warranty in respect of the property.