





Adam Hayes - North Finchley Office - Lettings 365 Ballards Lane, North Finchley, London, N12 8LL

Tel: 020 8445 4008 Email: info@adam-hayes.co.uk Web: www.adam-hayes.co.uk

Friern Park, London, N12 9DL

£1,800 PCM

 2 Bedrooms  1 Bathrooms  1 Receptions

Key Features

- Ground Floor Flat
- Approx. 14ft Lounge
- Wooden Flooring
- Seperate Kitchen
- Great Location

Other Information

Council Tax Band: C
Length of Tenancy: Long Let
Deposit: £2,075

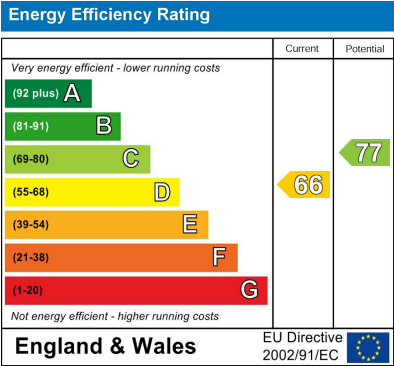

Nearest Stations

-
-
-

Property Description

Situated in a popular development off Friern Park and within easy access to an array of local schools, amenities and transport links including North Finchley High Road and Woodside Park Tube Station (Northern Line) is this well presented two bedroom ground floor apartment. The property benefits from an approx. 14ft reception room with natural light flooding throughout, a separate fitted kitchen, wooden flooring, a three piece bathroom suite and a use of communal gardens and off street parking. An internal viewing is highly recommended.

Approximate Gross Internal Area
542 sq ft - 50 sq m

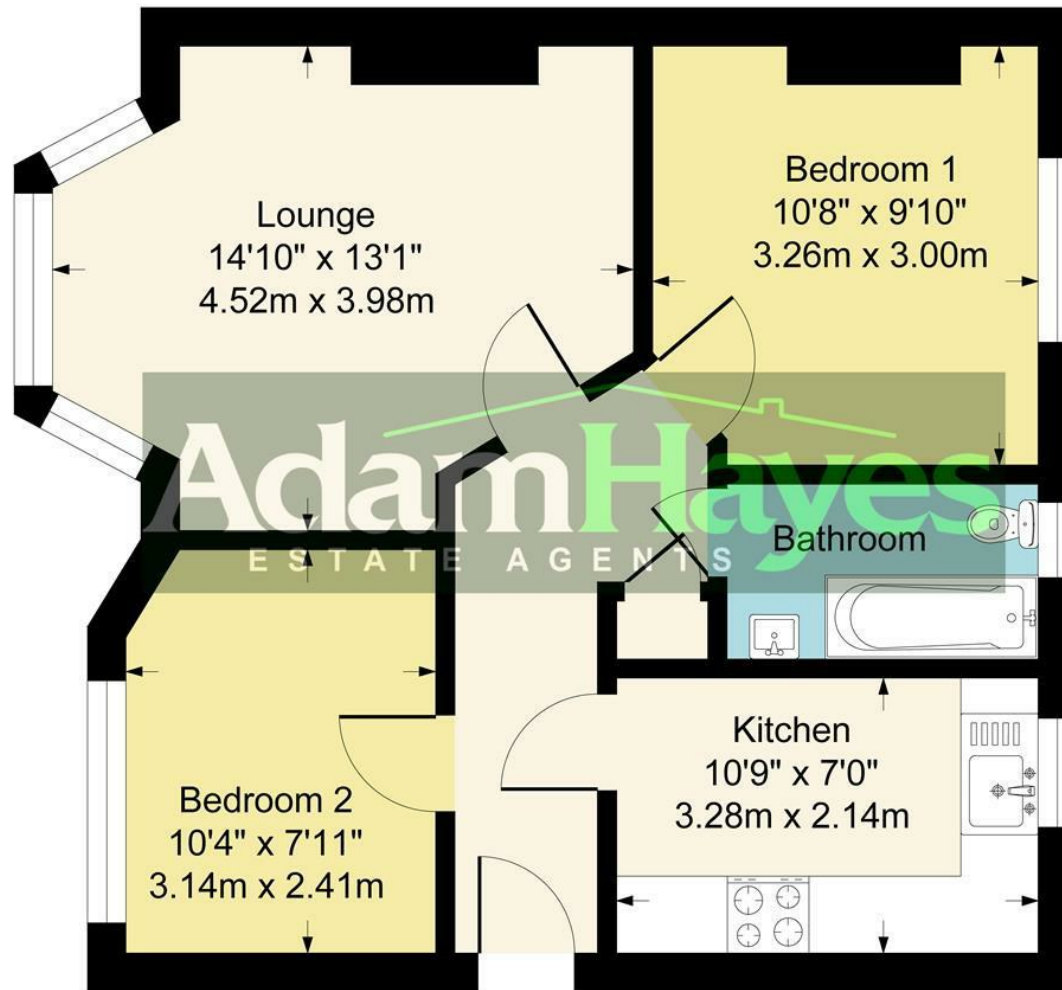

Although every attempt has been made to ensure accuracy, all measurements are approximate.
This floorplan is for illustrative purposes only and not to scale.
Measured in accordance with RICS Standards.

These particulars, whilst believed to be accurate, are set out as a general outline only for guidance and do not constitute any part of an offer or contract. Intending purchasers or prospective tenants should not rely on them as statements or representation of fact, but must satisfy themselves by inspection or otherwise as to their accuracy. We have not carried out a detailed survey, not tested the services, appliances and specific fittings. Room sizes should not be relied upon for carpets and furnishings. The measurements given are approximate. No person in this firm's employment has the authority to make or give any representation or warranty in respect of the property.