





Adam Hayes - North Finchley Office - Lettings 365 Ballards Lane, North Finchley, London, N12 8LL

Tel: 020 8445 4008 Email: info@adam-hayes.co.uk Web: www.adam-hayes.co.uk

Okehampton Close, London, N12 9TX

£1,725 Per Week

 2 Bedrooms  1 Bathrooms  1 Receptions

Key Features

- Good Size Reception
- Communal Off Street Parking
- Great Location
- Modern Fitted Kitchen
- Approx 11ft Lounge
- Modern Bathroom

Other Information

Council Tax Band: D
Length of Tenancy: Long Let
Deposit: £1,990

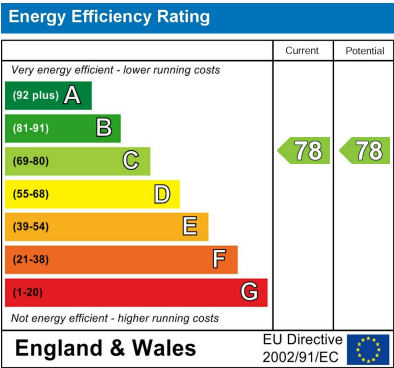

Nearest Stations

- Woodside Park

Property Description

A beautifully presented two double bedroom ground floor purpose built apartment, ideally located within this sought after development, just a short distance from North Finchley High Road and Woodside Park Tube Station. The property features an approximately 11ft lounge, a separate modern fitted kitchen, double glazing, and gas central heating. Okehampton Close is accessed via two private roads off Friern Park and enjoys close proximity to the wide variety of shops, cafés, restaurants, and excellent transport links available on North Finchley High Road. Friary Park, with its open green spaces, is also nearby. Early viewing is highly recommended to fully appreciate all this property has to offer.

Adam Hayes - North Finchley Office - Lettings 365 Ballards Lane, North Finchley, London, N12 8LL
Tel: 020 8445 4008 Email: info@adam-hayes.co.uk Web: www.adam-hayes.co.uk

Approximate Gross Internal Area
581 sq ft - 54 sq m

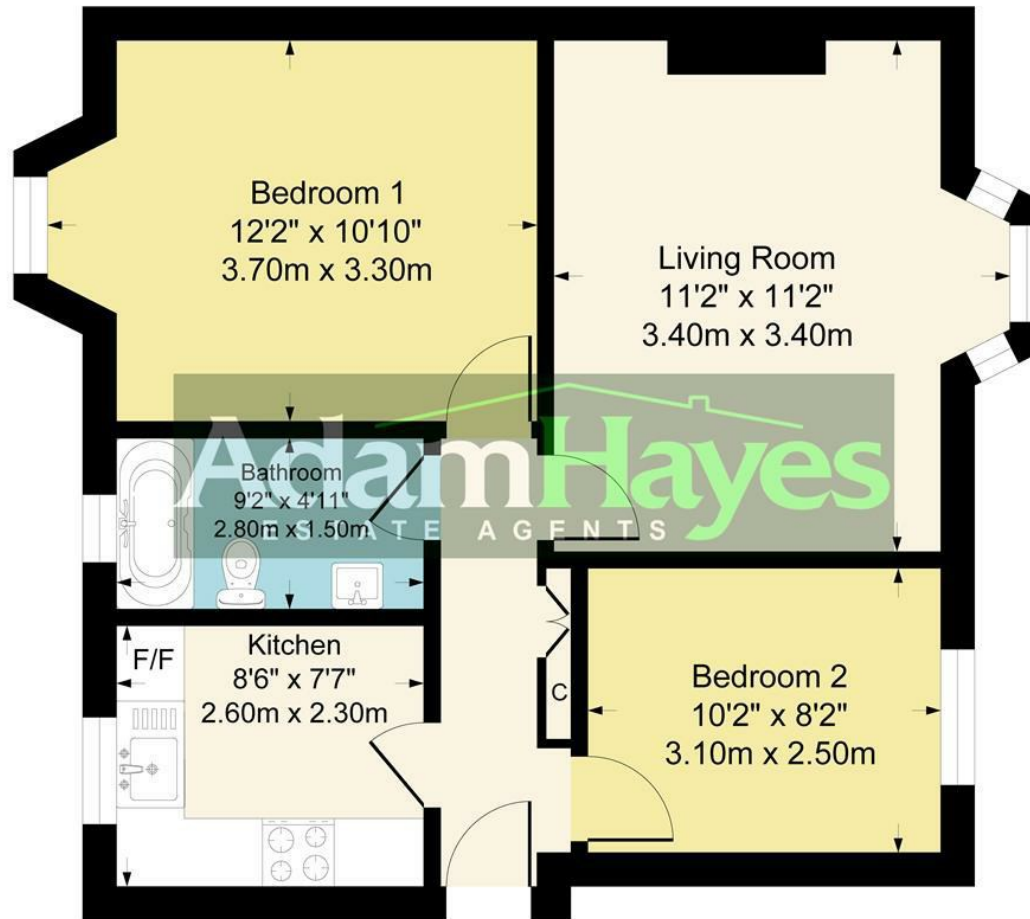

Although every attempt has been made to ensure accuracy, all measurements are approximate.
This floorplan is for illustrative purposes only and not to scale.
Measured in accordance with RICS Standards.

These particulars, whilst believed to be accurate, are set out as a general outline only for guidance and do not constitute any part of an offer or contract. Intending purchasers or prospective tenants should not rely on them as statements or representation of fact, but must satisfy themselves by inspection or otherwise as to their accuracy. We have not carried out a detailed survey, not tested the services, appliances and specific fittings. Room sizes should not be relied upon for carpets and furnishings. The measurements given are approximate. No person in this firm's employment has the authority to make or give any representation or warranty in respect of the property.