





Adam Hayes - North Finchley Office - Lettings 365 Ballards Lane, North Finchley, London, N12 8LL

Tel: 020 8445 4008 Email: info@adam-hayes.co.uk Web: www.adam-hayes.co.uk

Ballard's Lane, North Finchley, N12

£2,520 PCM

3 Bedrooms 2 Bathrooms 1 Receptions

Key Features

- Three Bedroom Purpose Built Flat
- Two Bathrooms
- Modern Open Plan Kitchen
- 26ft Lounge
- Wooden Flooring
- Close to Tally Ho
- Close to West Finchley Tube

Nearest Stations

- West Finchley - 0.8 Miles
- Woodside Park 0.7 Miles

Property Description

A well-presented and generously proportioned three double bedroom, two bathroom apartment (including an en-suite shower room), set within a modern purpose-built development just off Ballards Lane. Ideally located within easy reach of both West Finchley and Woodside Park Tube Stations (Northern Line), this stylish home offers excellent access to local amenities including Waitrose, Sainsbury's, and an array of cafes and restaurants. The property features an impressive 26ft reception room with high ceilings and a contemporary open-plan kitchen, a fully tiled family bathroom, and a sleek en-suite shower room. Additional benefits include lift access and elegant wooden flooring throughout. An ideal opportunity for those seeking space, convenience, and modern living. Early viewings are highly recommended.

Other Information

Council Tax Band: E
Length of Tenancy: Long Let
Deposit: £2,905

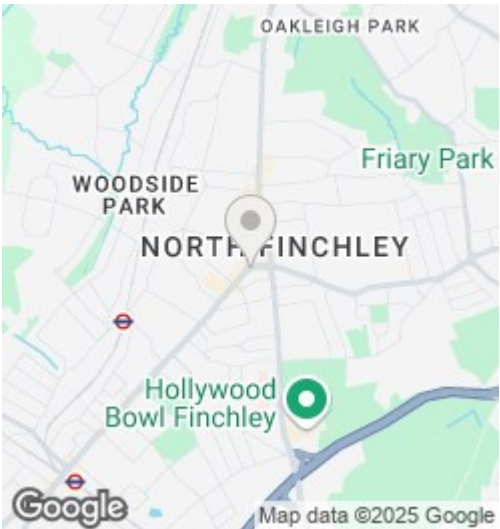

Energy Efficiency Rating		
	Current	Potential
Very energy efficient - lower running costs		
(92 plus) A		
(81-91) B	82	82
(69-80) C		
(55-68) D		
(39-54) E		
(21-38) F		
(1-20) G		
Not energy efficient - higher running costs		
England & Wales	EU Directive 2002/91/EC	

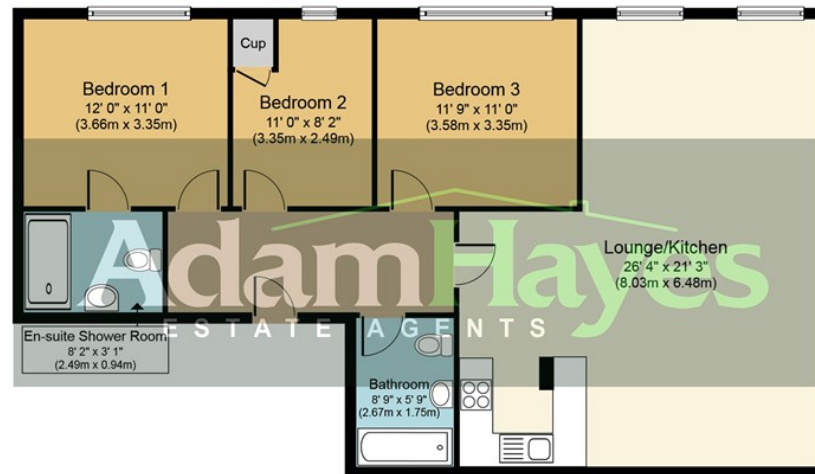

Approximate Floor Area
1,057 sq. ft.
(98.2 sq. m.)

Approx.Gross Internal Floor Area 1,057 sq. ft. (98.2 sq. m.)

Whilst every attempt has been made to ensure the accuracy of the floor plan contained here, measurements of doors, windows, rooms and any other items are approximate and no responsibility is taken for any error, omission, or mis-statement. This plan is for illustrative purposes only and should be used as such by any prospective purchaser or tenant. The services, systems and appliances shown have not been tested and no guarantee as to their operability or efficiency can be given.
 Copyright V360 Ltd 2017 | www.houseviz.com

These particulars, whilst believed to be accurate, are set out as a general outline only for guidance and do not constitute any part of an offer or contract. Intending purchasers or prospective tenants should not rely on them as statements or representation of fact, but must satisfy themselves by inspection or otherwise as to their accuracy. We have not carried out a detailed survey, not tested the services, appliances and specific fittings. Room sizes should not be relied upon for carpets and furnishings. The measurements given are approximate. No person in this firm's employment has the authority to make or give any representation or warranty in respect of the property.