





Adam Hayes - North Finchley Office - Lettings 365 Ballards Lane, North Finchley, London, N12 8LL

Tel: 020 8445 4008 Email: info@adam-hayes.co.uk Web: www.adam-hayes.co.uk

Regents Park Road, Finchley Central, N3 1DE

£1,600 PCM

 2 Bedrooms  1 Bathrooms  1 Receptions

Key Features

- Two Bedroom Conversion
- Modern Bathroom
- Wooden Flooring
- Open Plan Kitchen
- Fantastic Location
- Close To Tube

Nearest Stations

- Finchley Central Tube

Property Description

A well-presented modern two-bedroom second-floor apartment, positioned above commercial premises in a prime location just moments from Finchley Central Underground Station (Northern Line). The property is ideally placed for a wide selection of local shops, cafés, supermarkets, restaurants and everyday amenities. Internally, the flat offers a bright 15ft reception room with a contemporary open-plan kitchen, a stylish modern bathroom, wooden flooring throughout, double glazing and gas central heating. Victoria Park and excellent bus connections are also within easy reach. Early viewing is highly recommended.

Other Information

Council Tax Band: C

Length of Tenancy: Long Let

Deposit: £1,846

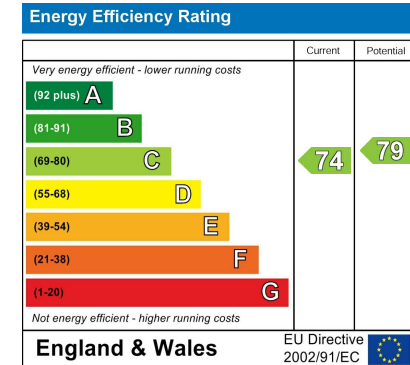

Adam Hayes - North Finchley Office - Lettings 365 Ballards Lane, North Finchley, London, N12 8LL

Tel: 020 8445 4008 Email: info@adam-hayes.co.uk Web: www.adam-hayes.co.uk

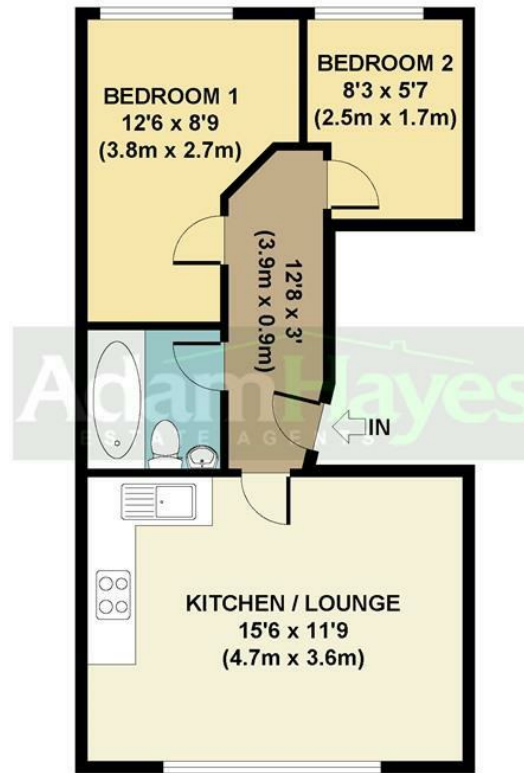

**GROSS INTERNAL
FLOOR AREA 412 SQ FT**

APPROX. GROSS INTERNAL FLOOR AREA 412 SQ FT / 38 SQ M
Floorplans are for identification and guideline purposes only, not to scale.
Compliant with RICS code of measuring practice.
Floorplans supplied by www.draftingfloorplan.com

These particulars, whilst believed to be accurate, are set out as a general outline only for guidance and do not constitute any part of an offer or contract. Intending purchasers or prospective tenants should not rely on them as statements or representation of fact, but must satisfy themselves by inspection or otherwise as to their accuracy. We have not carried out a detailed survey, not tested the services, appliances and specific fittings. Room sizes should not be relied upon for carpets and furnishings. The measurements given are approximate. No person in this firm's employment has the authority to make or give any representation or warranty in respect of the property.