





Adam Hayes - North Finchley Office - Lettings 365 Ballards Lane, North Finchley, London, N12 8LL

Tel: 020 8445 4008 Email: info@adam-hayes.co.uk Web: www.adam-hayes.co.uk

Woodside Avenue, Woodside Park, N12 8LS

£1,350 PCM

0 Bedrooms 1 Bathrooms 1 Receptions

Key Features

- Newly refurbished studio
- Popular development
- Good size living area
- Video entry phone system
- Gas central heating
- Allocated parking
- Close to Tube

Nearest Stations

- Woodside Park

Property Description

A newly refurbished ground floor, purpose-built studio apartment set within this highly sought-after development, conveniently located within easy reach of Woodside Park Underground Station (Northern Line) and a wide range of local amenities. The property offers a bright and well-proportioned living space of approximately 15ft, complemented by a newly fitted modern kitchen and a contemporary bathroom suite. Further benefits include new carpets throughout, double glazing, gas central heating, a video entry phone system and allocated parking for one vehicle. Offered unfurnished and available immediately. Ideally positioned close to the various shops, cafés and transport links along North Finchley High Road, as well as nearby parks and pleasant walking trails. Early viewings are strongly recommended.

Other Information

Council Tax Band: D
Length of Tenancy: Long Let
Deposit: £1,557



Energy Efficiency Rating		
	Current	Potential
Very energy efficient - lower running costs		
(92 plus) A		
(81-91) B		
(69-80) C	70	74
(55-68) D		
(39-54) E		
(21-38) F		
(1-20) G		
Not energy efficient - higher running costs		
England & Wales	EU Directive 2002/91/EC	

Adam Hayes - North Finchley Office - Lettings 365 Ballards Lane, North Finchley, London, N12 8LL

Tel: 020 8445 4008 Email: info@adam-hayes.co.uk Web: www.adam-hayes.co.uk

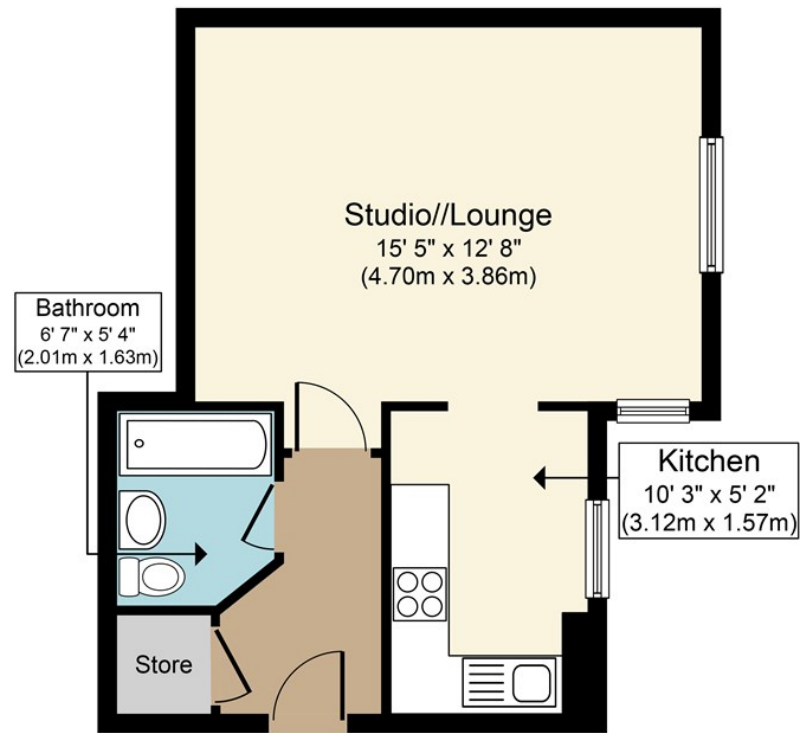

Approx. Gross Internal Floor Area 385 sq. ft. / 35.8 sq. m.

Whilst every attempt has been made to ensure the accuracy of the floor plan contained here, measurements of doors, windows, rooms and any other items are approximate and no responsibility is taken for any error, omission, or mis-statement. This plan is for illustrative purposes only and should be used as such by any prospective purchaser or tenant. The services, systems and appliances shown have not been tested and no guarantee as to their operability or efficiency can be given.
Copyright V360 Ltd 2018 | www.houseviz.com

These particulars, whilst believed to be accurate, are set out as a general outline only for guidance and do not constitute any part of an offer or contract. Intending purchasers or prospective tenants should not rely on them as statements or representation of fact, but must satisfy themselves by inspection or otherwise as to their accuracy. We have not carried out a detailed survey, not tested the services, appliances and specific fittings. Room sizes should not be relied upon for carpets and furnishings. The measurements given are approximate. No person in this firm's employment has the authority to make or give any representation or warranty in respect of the property.