

Adam Hayes - North Finchley Office - Lettings 365 Ballards Lane, North Finchley, London, N12 8LL

Tel: 020 8445 4008 Email: info@adam-hayes.co.uk Web: www.adam-hayes.co.uk

Hemingford Close, London, N12 9HF

£1,550 PCM

 1 Bedrooms  1 Bathrooms  1 Receptions

Key Features

- One Bedroom House
- Popular Location
- Allocated Parking
- Garden
- Fitted Wardrobes
- Ample Storage

Other Information

Council Tax Band: D
Length of Tenancy: Long Let
Deposit: £1,788

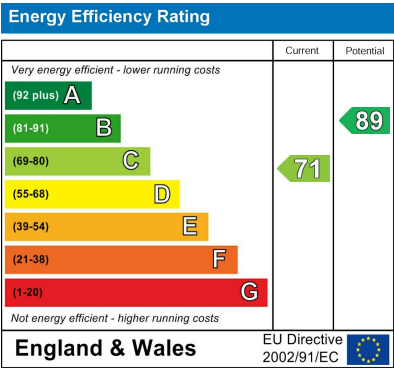

Nearest Stations

- West Finchley
- Woodside Park

Property Description

A rarely available one bedroom house with garden conveniently located within this popular residential turning off Fenstanton Avenue within easy access to local amenities and transport links. The property benefits from an approx. 14ft reception which leads onto a fitted kitchen, laminated wooden flooring on the ground floor, wooden double glazed windows, fitted wardrobes, gas central heating, allocated parking for one car and a lovely private garden. Internal viewings are highly recommended via the landlords sole agent Adam Hayes Estate Agents.

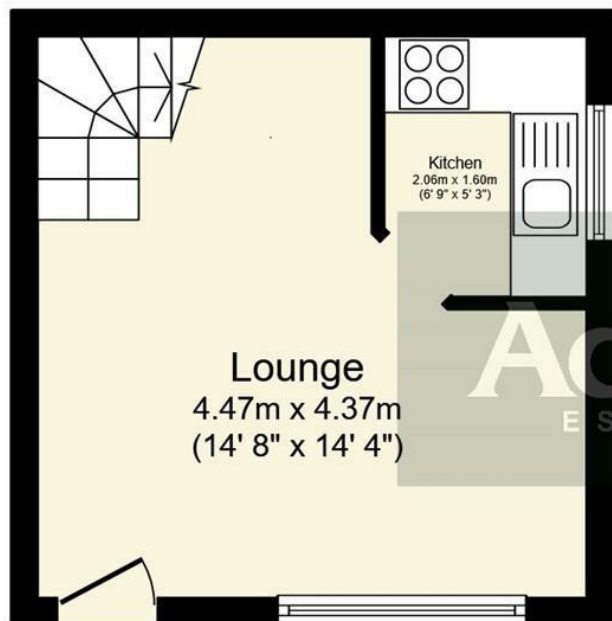

Ground Floor

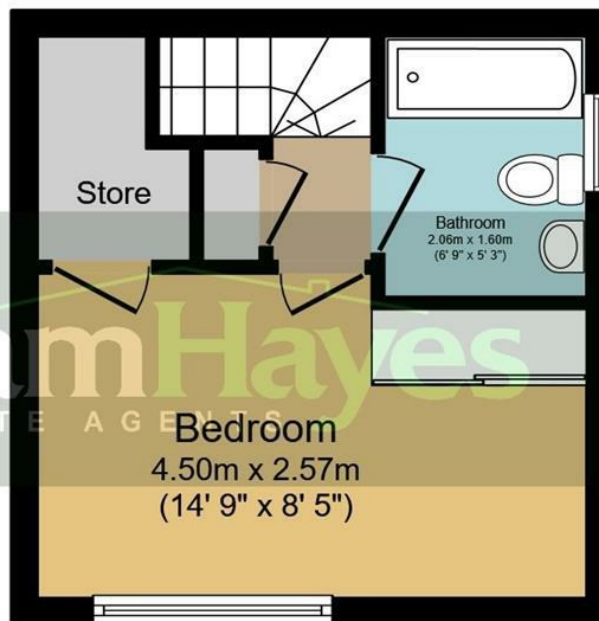

First Floor

Total floor area 38.6 sq.m. (415 sq.ft.) approx

This plan is for illustration purposes only and may not be representative of the property. Plan not to scale.

These particulars, whilst believed to be accurate, are set out as a general outline only for guidance and do not constitute any part of an offer or contract. Intending purchasers or prospective tenants should not rely on them as statements or representation of fact, but must satisfy themselves by inspection or otherwise as to their accuracy. We have not carried out a detailed survey, not tested the services, appliances and specific fittings. Room sizes should not be relied upon for carpets and furnishings. The measurements given are approximate. No person in this firm's employment has the authority to make or give any representation or warranty in respect of the property.