

Adam Hayes - North Finchley Office - Lettings 365 Ballards Lane, North Finchley, London, N12 8LL

Tel: 020 8445 4008 Email: info@adam-hayes.co.uk Web: www.adam-hayes.co.uk

Nether Street, North Finchley, N12 7NL

£1,050 PCM

1 Bedrooms 1 Bathrooms 1 Receptions

Key Features

- First Floor One Bedroom Conversion
- Good Size Lounge / Open Plan Kitchen
- Close to Shops and Tube
- Fantastic Location
- Double Glazing
- Inclusive of Water

Other Information

Council Tax Band: B
Length of Tenancy: Long Let
Deposit: £1,210

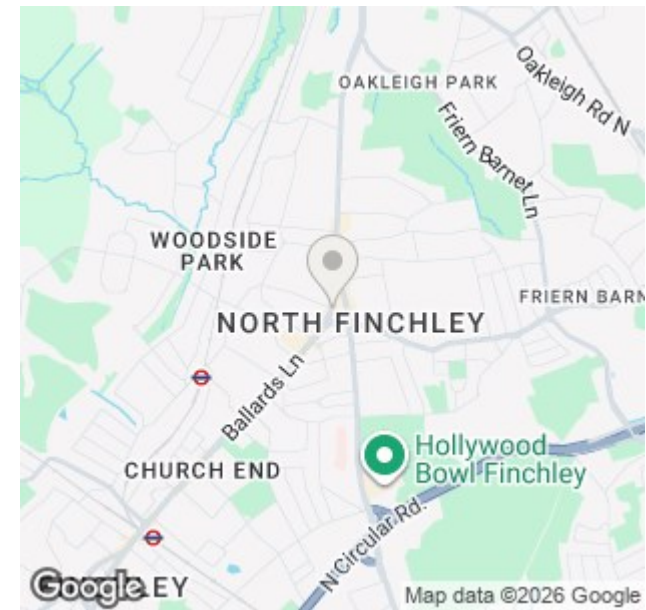

Nearest Stations

- West Finchley
- Woodside Park

Property Description

A well presented first floor one bedroom conversion situated in this excellent location within close proximity to an array of shopping facilities and West Finchley Tube Station (Northern Line). The property benefits from a good size living area with an open plan fitted kitchen, a separate bedroom, double glazing and gas central heating. Various restaurants, cafes, and supermarkets are also located within walking distance. Water rates are included. Early viewings are highly recommended!

Energy Efficiency Rating		
	Current	Potential
<i>Very energy efficient - lower running costs</i>		
(92 plus) A		
(81-91) B		
(69-80) C		
(55-68) D	60	67
(39-54) E		
(21-38) F		
(1-20) G		
<i>Not energy efficient - higher running costs</i>		
England & Wales	EU Directive 2002/91/EC	

Adam Hayes - North Finchley Office - Lettings 365 Ballards Lane, North Finchley, London, N12 8LL

Tel: 020 8445 4008 Email: info@adam-hayes.co.uk Web: www.adam-hayes.co.uk

**Approximate Gross Internal Area
329 sq ft - 30.5 sq m**

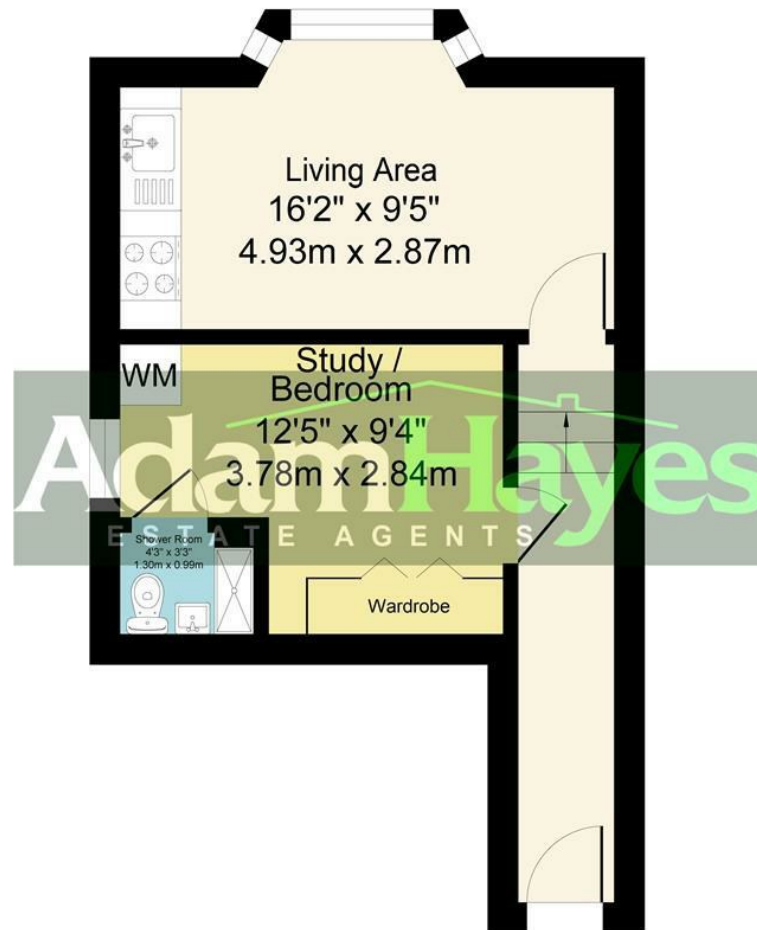

Although every attempt has been made to ensure accuracy, all measurements are approximate.
This floorplan is for illustrative purposes only and not to scale.
Measured in accordance with RICS Standards.

These particulars, whilst believed to be accurate, are set out as a general outline only for guidance and do not constitute any part of an offer or contract. Intending purchasers or prospective tenants should not rely on them as statements or representation of fact, but must satisfy themselves by inspection or otherwise as to their accuracy. We have not carried out a detailed survey, not tested the services, appliances and specific fittings. Room sizes should not be relied upon for carpets and furnishings. The measurements given are approximate. No person in this firm's employment has the authority to make or give any representation or warranty in respect of the property.