





Adam Hayes - Finchley Central Office - Lettings 348 Regents Park Road, Finchley Central, London, N3 2LJ

Tel: 0208 189 6333 Email: [info@adam-hayes.co.uk](mailto:info@adam-hayes.co.uk) Web: [www.adam-hayes.co.uk](http://www.adam-hayes.co.uk)

Regents Park Road, London, N3 1DE

£1,600 PCM

 2 Bedrooms  1 Bathrooms  1 Receptions

## Key Features

- Two Bedroom Flat
- Modern Kitchen
- Excellent Location
- Close To Local Transport and Shops
- Double Glazing
- Gas Central Heating

## Nearest Stations

- Finchley Central

## Property Description

A well-presented two bedroom flat ideally located on Regents Park Road above a commercial premises, within close proximity to Finchley Central Tube Station (Northern Line) and a variety of local shops and amenities. This modern home features an impressive 15ft reception room with a contemporary open-plan kitchen, a stylish tiled bathroom, laminated wood flooring, double glazing, and gas central heating. Early viewings are highly recommended through Adam Hayes Estate Agents.

## Other Information

Council Tax Band: B

Length of Tenancy: Long Let

Deposit: £1,845

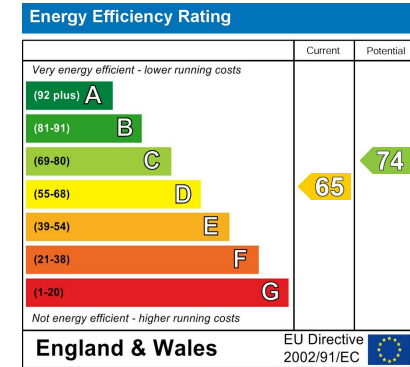

Adam Hayes - Finchley Central Office - Lettings 348 Regents Park Road, Finchley Central, London, N3 2LJ

Tel: 0208 189 6333 Email: [info@adam-hayes.co.uk](mailto:info@adam-hayes.co.uk) Web: [www.adam-hayes.co.uk](http://www.adam-hayes.co.uk)

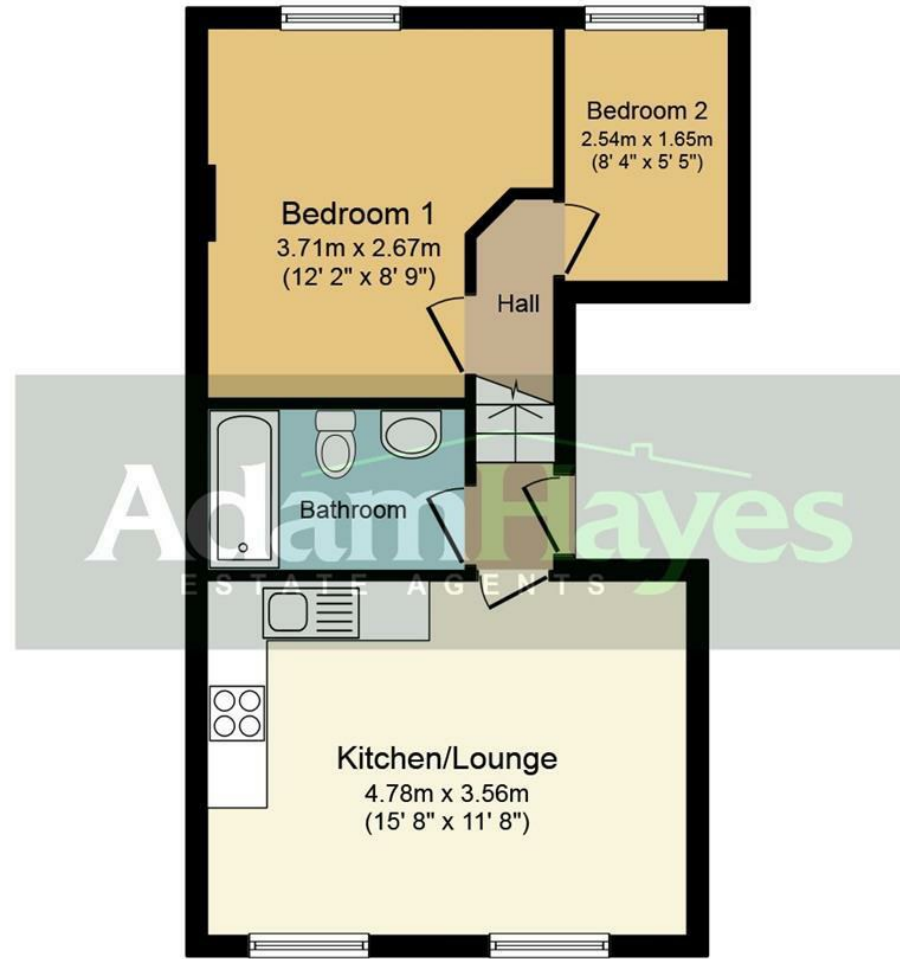

## Floor Plan

Total floor area 40.8 sq. m. (439 sq. ft.) approx

This plan is for illustration purposes only and may not be representative of the property. Plan not to scale.

These particulars, whilst believed to be accurate, are set out as a general outline only for guidance and do not constitute any part of an offer or contract. Intending purchasers or prospective tenants should not rely on them as statements or representation of fact, but must satisfy themselves by inspection or otherwise as to their accuracy. We have not carried out a detailed survey, not tested the services, appliances and specific fittings. Room sizes should not be relied upon for carpets and furnishings. The measurements given are approximate. No person in this firm's employment has the authority to make or give any representation or warranty in respect of the property.