



Squires Lane, Finchley Central, N3

£1,650 PCM

 1 Bedroom  1 Bathroom  1 Reception





Adam Hayes - Finchley Central Office - Lettings 348 Regents Park Road, Finchley Central, London, N3 2LJ  
Tel: 0208 189 6333 Email: [info@adam-hayes.co.uk](mailto:info@adam-hayes.co.uk) Web: [www.adam-hayes.co.uk](http://www.adam-hayes.co.uk)



# Squires Lane, Finchley Central, N3

£1,650 PCM

1 Bedrooms 1 Bathrooms 1 Receptions

## Key Features

- One Bedroom Ground Floor Flat
- Eat in Size Kitchen
- Modern Bathroom
- 13ft Lounge
- Private Garden

## Nearest Stations

Finchley Central Station	0.4 miles
West Finchley Station	0.8 miles
East Finchley Station	1.2 miles

## Property Description

This charming one-bedroom ground-floor conversion is located within easy reach of Finchley Central Tube Station and local amenities, offering a delightful living experience. The property features a spacious reception room measuring approximately 13ft, a modern eat-in kitchen perfect for casual dining, and a stylish bathroom. Additional benefits include double-glazed windows, gas central heating, and laminated wooden flooring throughout, adding a sleek touch to the interiors. The home also boasts its own section of the garden, ideal for relaxing or entertaining. Viewings are highly recommended. Contact Adam Hayes, the landlord's main agent, on 0208 445 4008 to arrange a visit.

## Other Information

Council Tax Band: C  
Length of Tenancy: Long Let  
Deposit: £1,900

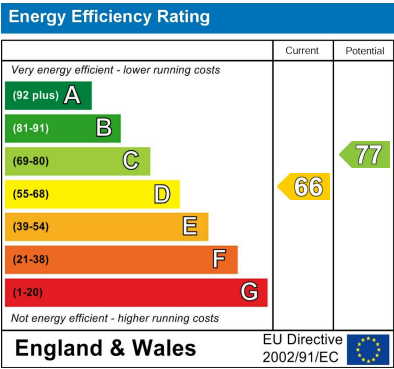
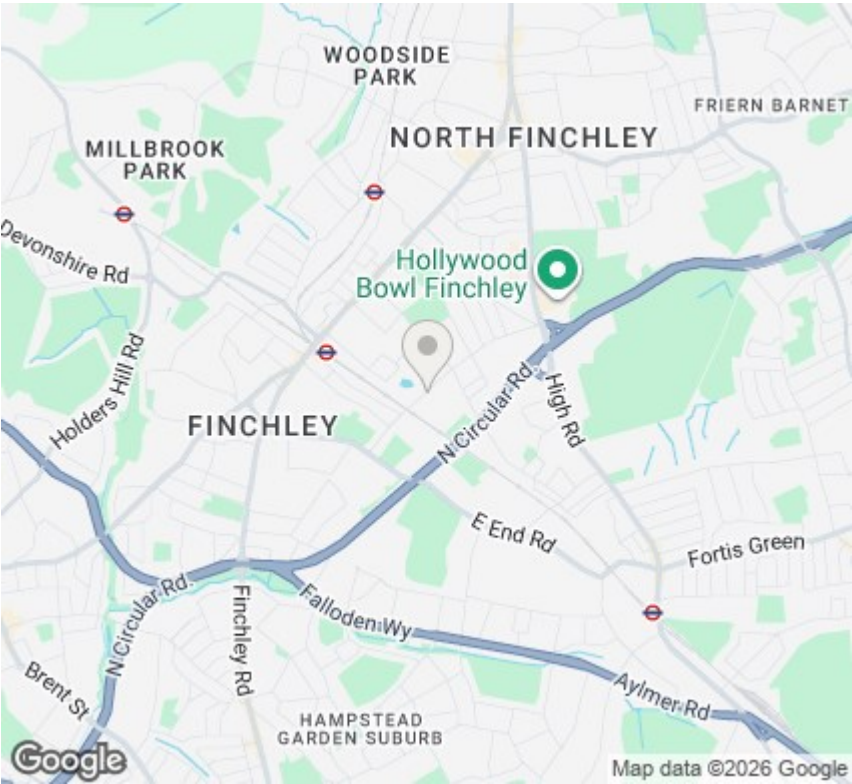

Adam Hayes - Finchley Central Office - Lettings 348 Regents Park Road, Finchley Central, London, N3 2LJ

Tel: 0208 189 6333 Email: info@adam-hayes.co.uk Web: www.adam-hayes.co.uk

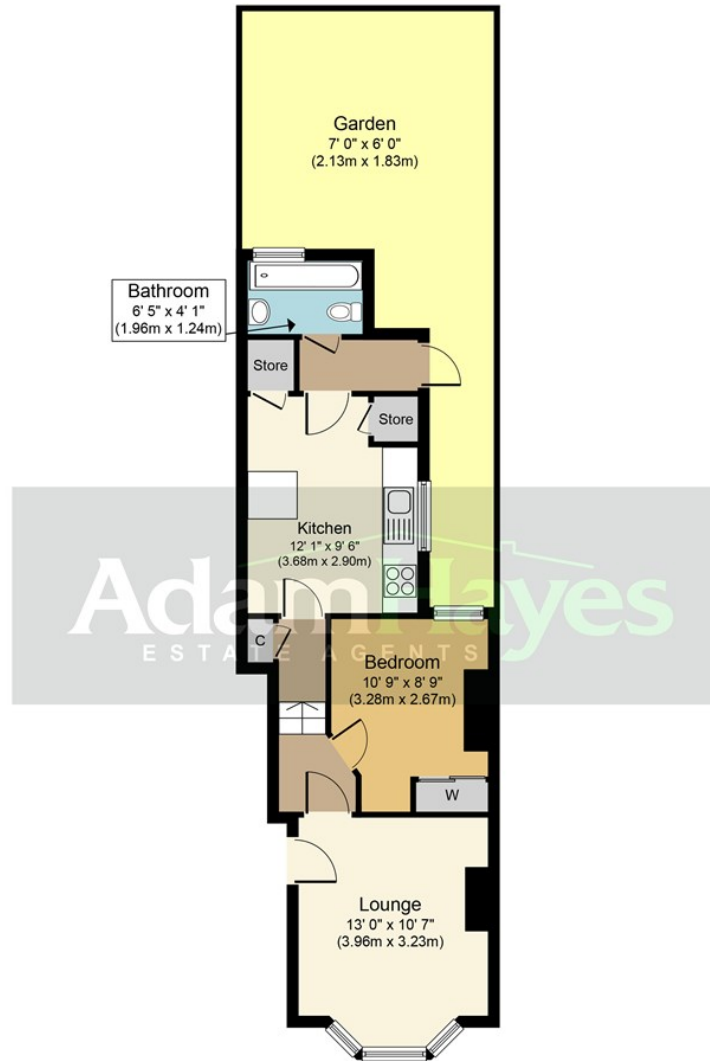

**Approx. Gross Internal Floor Area 441 sq. ft. (41.0 sq. m.)**

Whilst every attempt has been made to ensure the accuracy of the floor plan contained here, measurements of doors, windows, rooms and any other items are approximate and no responsibility is taken for any error, omission, or mis-statement. This plan is for illustrative purposes only and should be used as such by any prospective purchaser or tenant. The services, systems and appliances shown have not been tested and no guarantee as to their operability or efficiency can be given.

Copyright V360 Ltd 2017 | [www.houseviz.com](http://www.houseviz.com)

These particulars, whilst believed to be accurate, are set out as a general outline only for guidance and do not constitute any part of an offer or contract. Intending purchasers or prospective tenants should not rely on them as statements or representation of fact, but must satisfy themselves by inspection or otherwise as to their accuracy. We have not carried out a detailed survey, not tested the services, appliances and specific fittings. Room sizes should not be relied upon for carpets and furnishings. The measurements given are approximate. No person in this firm's employment has the authority to make or give any representation or warranty in respect of the property.