





Adam Hayes - North Finchley Office - Sales 365 Ballards Lane, North Finchley, London, N12 8LL
 Tel: 020 8445 4008 Email: info@adam-hayes.co.uk Web: www.adam-hayes.co.uk

High Road, Whetstone, N20

OIEO £400,000

 2 Bedrooms  1 Bathrooms  1 Receptions

Key Features

- Two Double Bedrooms
- First Floor Apartment
- Balcony
- Fitted Kitchen
- Close to Amenities
- Within 0.3 miles of Totteridge & Whetstone Station

Other Information

Tenure: Leasehold
Length of Lease: 990 Years
Ground Rent: £50.00 P/a
Service Charge: £2,100.00 P/a
Council Tax Band: C



Nearest Stations

Totteridge & Whetstone Station	0.3 miles
Oakleigh Park Overground Station	0.6 miles
Woodside Park Station	1.0 miles

Property Description

Set back off Whetstone High Road and conveniently located within 0.3 miles from Totteridge & Whetstone Station (Northern Line) is this well presented two double bedroom first-floor apartment. The property is offered chain free and benefits from an approx. 17ft reception room leading to a private balcony, a four-piece bathroom suite, use of communal gardens and is within walking distance to a variety of shops including coffee houses and local amenities. To fully appreciate the location, potential and size of this property, an internal viewing is highly recommended through the vendor’s sole agents, Adam Hayes Estate Agents.

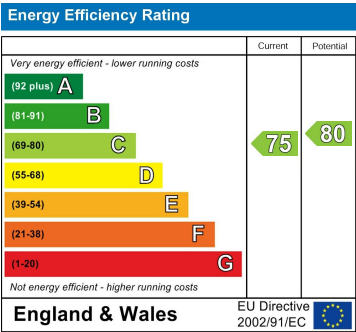

Approximate Gross Internal Area
722 sq ft - 67 sq m

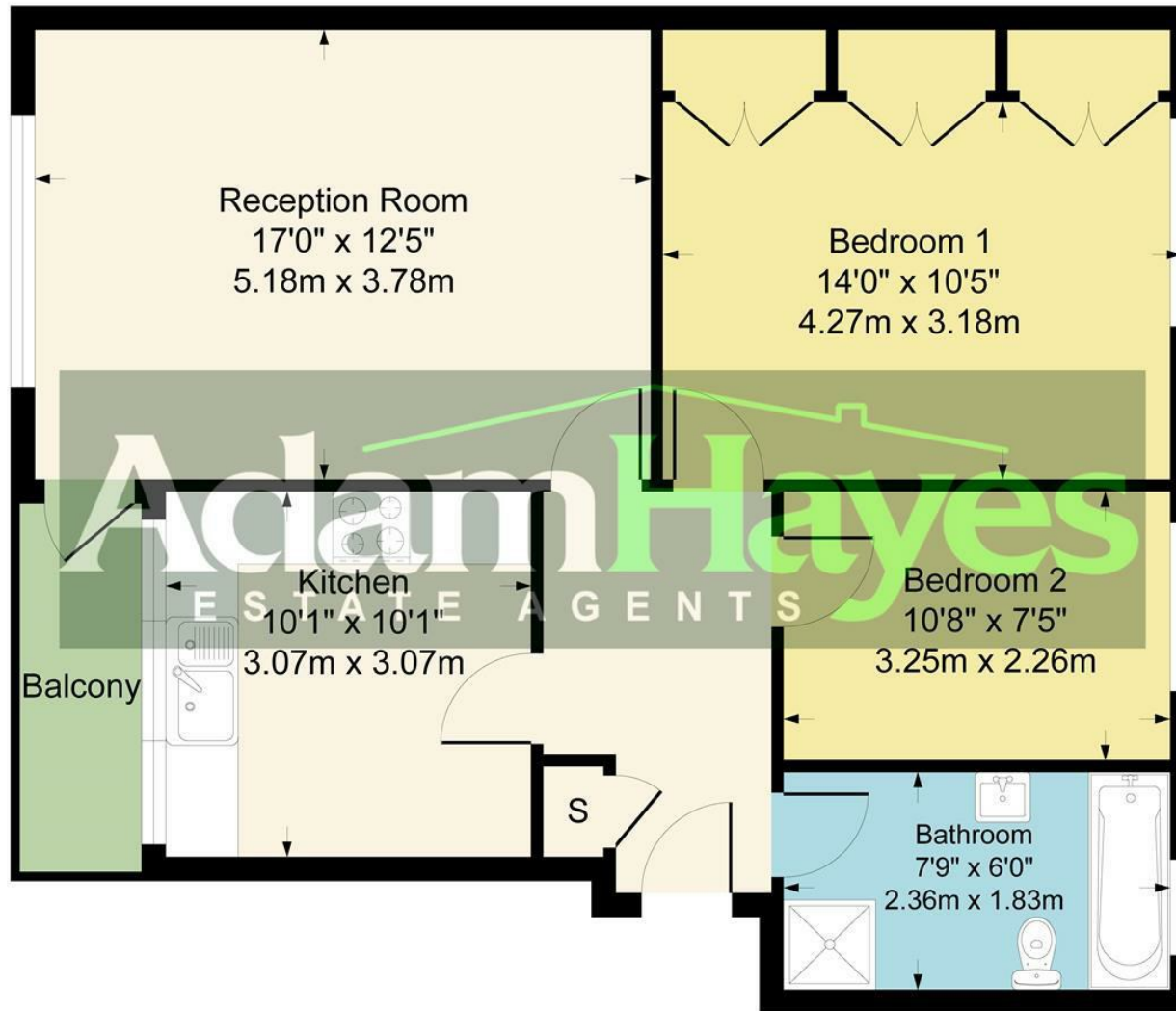

Although every attempt has been made to ensure accuracy, all measurements are approximate.
This floorplan is for illustrative purposes only and not to scale.
Measured in accordance with RICS Standards.

These particulars, whilst believed to be accurate, are set out as a general outline only for guidance and do not constitute any part of an offer or contract. Intending purchasers or prospective tenants should not rely on them as statements or representation of fact, but must satisfy themselves by inspection or otherwise as to their accuracy. We have not carried out a detailed survey, not tested the services, appliances and specific fittings. Room sizes should not be relied upon for carpets and furnishings. The measurements given are approximate. No person in this firm's employment has the authority to make or give any representation or warranty in respect of the property.