









Adam Hayes - East Finchley Office - Lettings 158 High Road, East Finchley, London, N2 9AS

Tel: 0208 883 2621 Email: [info@adam-hayes.co.uk](mailto:info@adam-hayes.co.uk) Web: [www.adam-hayes.co.uk](http://www.adam-hayes.co.uk)

Lucas Gardens, London, N2 8HJ

£1,400 PCM

 1 Bedrooms  1 Bathrooms  1 Receptions

Key Features

- One Bedroom Flat
- Ground Floor
- 14ft Living Room
- Communal Parking
- Use of Communal Gardens

Other Information

Council Tax Band: C  
Length of Tenancy: Long Let  
Deposit: £1,615

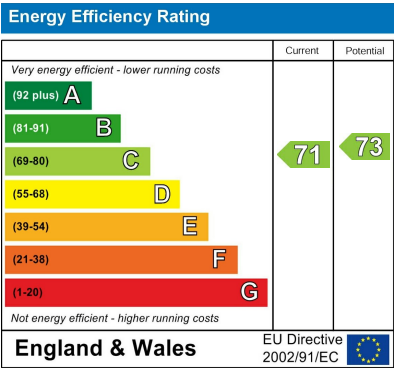

Nearest Stations

- East Finchley
- Finchley Central

Property Description

Nestled in a sought-after residential enclave just off Long Lane, this well presented one-bedroom ground floor apartment offers both comfort and convenience. The property features a 14ft reception, a contemporary kitchen, double-glazed windows, laminate flooring and a secure entry phone system. Residents also enjoy access to communal gardens and parking. Located in a scenic, set back modern development, this apartment is a must-see. We highly recommend an internal viewing through Adam Hayes Estate Agents, the landlord's sole agents.

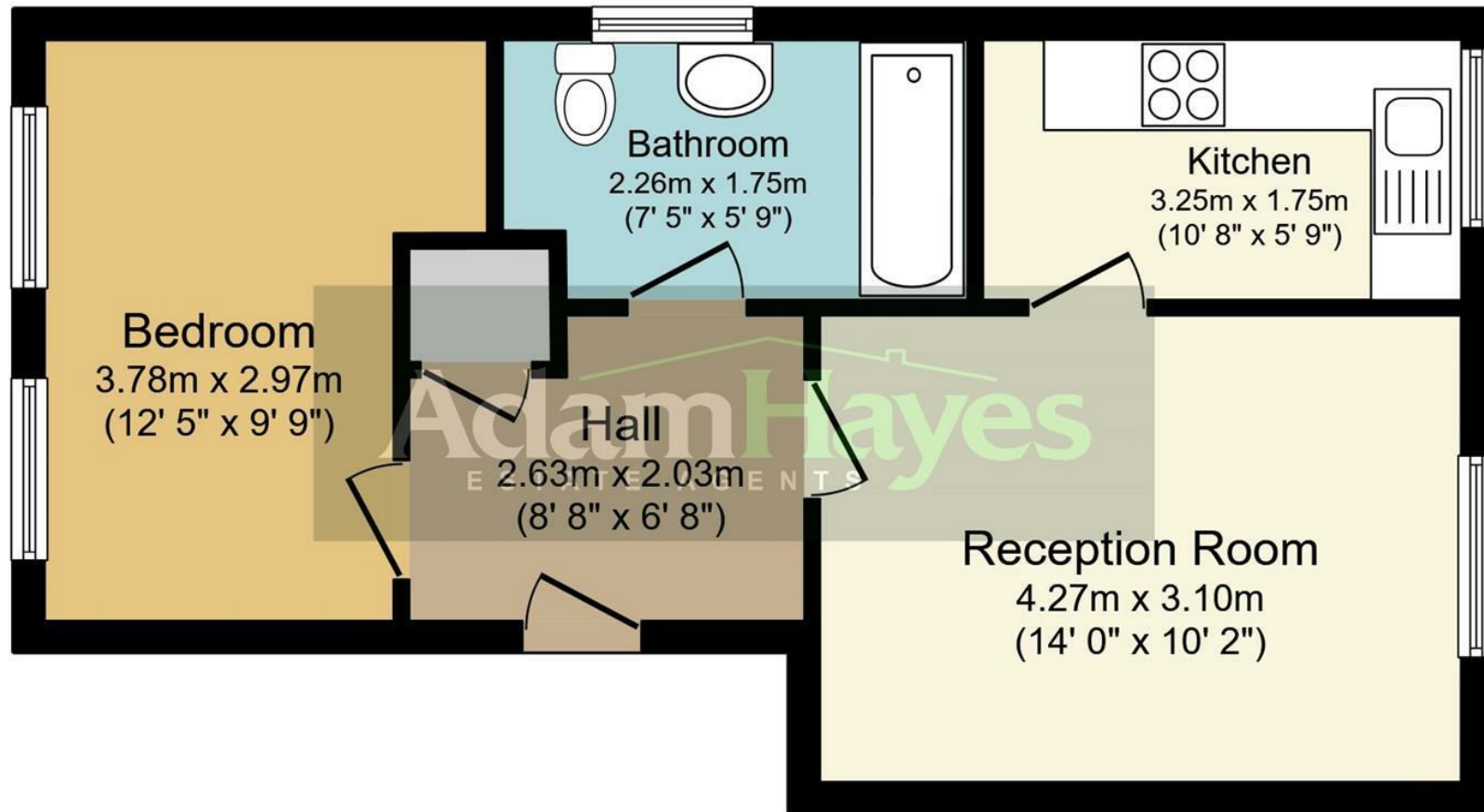

## Floor Plan

Total floor area 41.0 sq.m. (441 sq.ft.) approx

This plan is for illustration purposes only and may not be representative of the property. Plan not to scale.

These particulars, whilst believed to be accurate, are set out as a general outline only for guidance and do not constitute any part of an offer or contract. Intending purchasers or prospective tenants should not rely on them as statements or representation of fact, but must satisfy themselves by inspection or otherwise as to their accuracy. We have not carried out a detailed survey, not tested the services, appliances and specific fittings. Room sizes should not be relied upon for carpets and furnishings. The measurements given are approximate. No person in this firm's employment has the authority to make or give any representation or warranty in respect of the property.