

Adam Hayes - East Finchley Office - Lettings 158 High Road, East Finchley, London, N2 9AS

Tel: 0208 883 2621 Email: info@adam-hayes.co.uk Web: www.adam-hayes.co.uk

Midholm Close, London, NW11 6EB

£2,167 PCM

 1 Bedrooms  null Bathrooms  null Receptions

Key Features

- One Bedroom Maisonnete
- Large Garden
- 14ft Reception
- Modern Kitchen
- Wooden Flooring
- Great Condition

Other Information

Council Tax Band: D
Length of Tenancy: Long Let
Deposit: £2,500

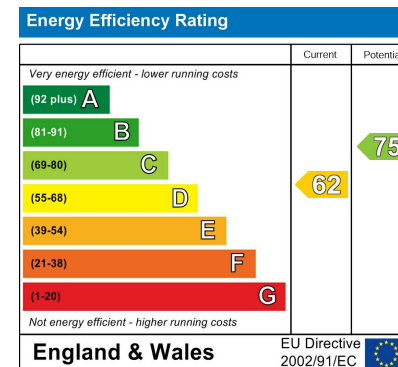

Nearest Stations

- Finchley Central
- East Finchley

Property Description

A beautifully presented one bedroom ground floor purpose-built maisonette, ideally located in the heart of Hampstead Garden Suburb with easy access to East Finchley Tube Station (Northern Line) and the local amenities of Market Place. The property benefits from its own private entrance and a generous private rear garden. Internally, the apartment features a bright 13ft reception room with bay window, a modern fitted kitchen, a well-proportioned principal bedroom, and a stylish porcelain tiled shower room. Additional features include laminated wooden flooring and modern fixtures and fittings throughout. Early viewing is highly recommended.

Adam Hayes - East Finchley Office - Lettings 158 High Road, East Finchley, London, N2 9AS

Tel: 0208 883 2621 Email: info@adam-hayes.co.uk Web: www.adam-hayes.co.uk

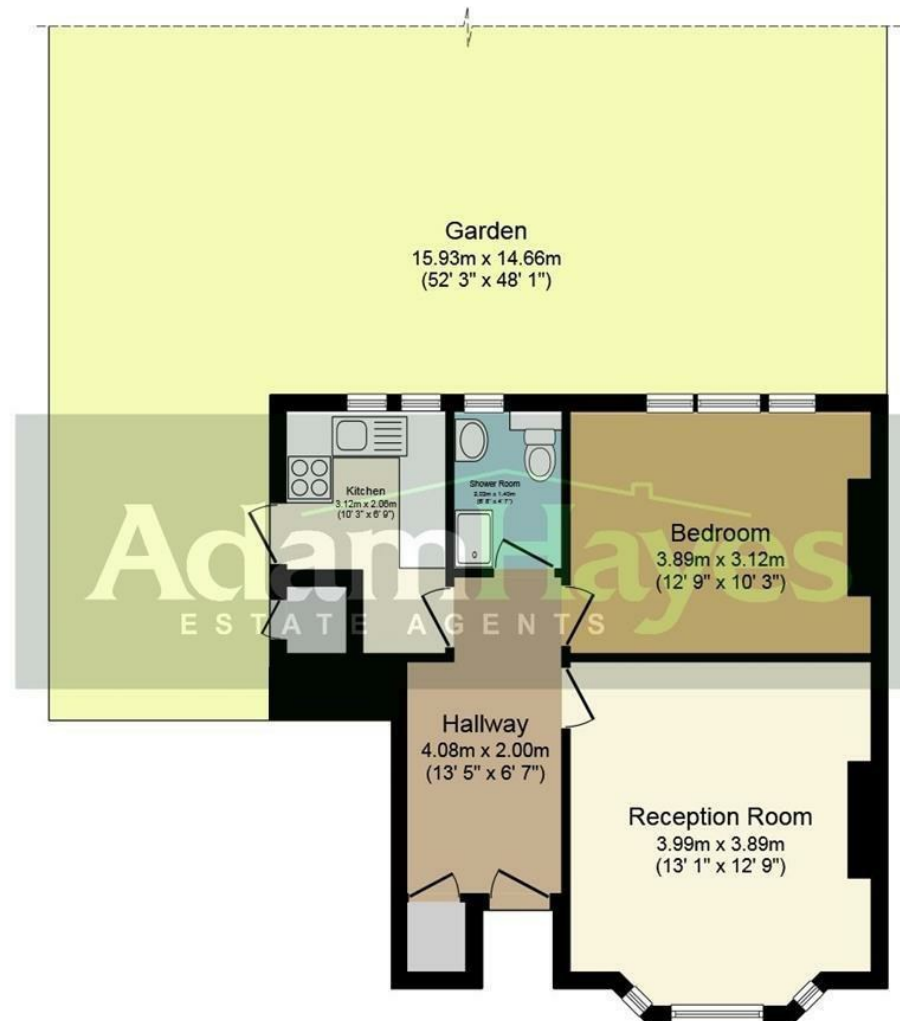

Ground Floor

Total floor area 44.5 sq.m. (480 sq.ft.) approx

This plan is for illustration purposes only and may not be representative of the property. Plan not to scale.

These particulars, whilst believed to be accurate, are set out as a general outline only for guidance and do not constitute any part of an offer or contract. Intending purchasers or prospective tenants should not rely on them as statements or representation of fact, but must satisfy themselves by inspection or otherwise as to their accuracy. We have not carried out a detailed survey, not tested the services, appliances and specific fittings. Room sizes should not be relied upon for carpets and furnishings. The measurements given are approximate. No person in this firm's employment has the authority to make or give any representation or warranty in respect of the property.