





Adam Hayes - East Finchley Office - Lettings 158 High Road, East Finchley, London, N2 9AS

Tel: 0208 883 2621 Email: info@adam-hayes.co.uk Web: www.adam-hayes.co.uk

Finchley Road, London, NW11 7ES

£1,750 PCM

 2 Bedrooms  1 Bathrooms  1 Receptions

Key Features

- Two Bedroom Conversion
- Prime Location
- Modern Open Plan Kitchen
- Modern Bathroom
- Close To Tube and Shops
- Double Glazing
- Gas Central Heating

Nearest Stations

- Golders Green Station
- Brent Cross Station

Property Description

Beautifully presented, this two-bedroom top floor conversion features a well-proportioned lounge with an open-plan fitted kitchen. Ideally located in the heart of Temple Fortune, the property offers convenient access to Golders Green Tube (Northern Line), as well as an excellent selection of local shops, restaurants, and cafés. The surrounding area also provides easy access to local parks and places of worship. Additional benefits include gas central heating, a contemporary bathroom, and part laminate flooring. Early viewings are highly recommended.

Other Information

Council Tax Band: New Build
Length of Tenancy: Long Let
Deposit: £2,019

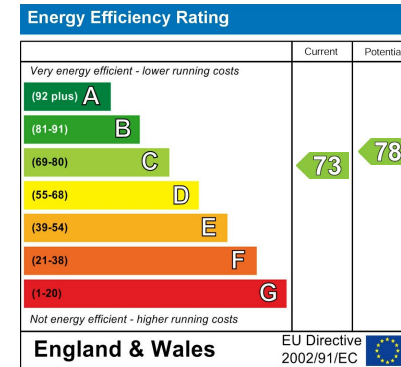
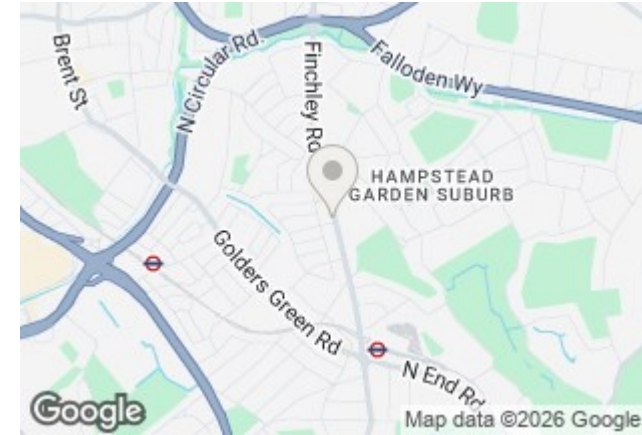

Adam Hayes - East Finchley Office - Lettings 158 High Road, East Finchley, London, N2 9AS

Tel: 0208 883 2621 Email: info@adam-hayes.co.uk Web: www.adam-hayes.co.uk

**Approximate Gross Internal Area
459 sq ft - 43 sq m**

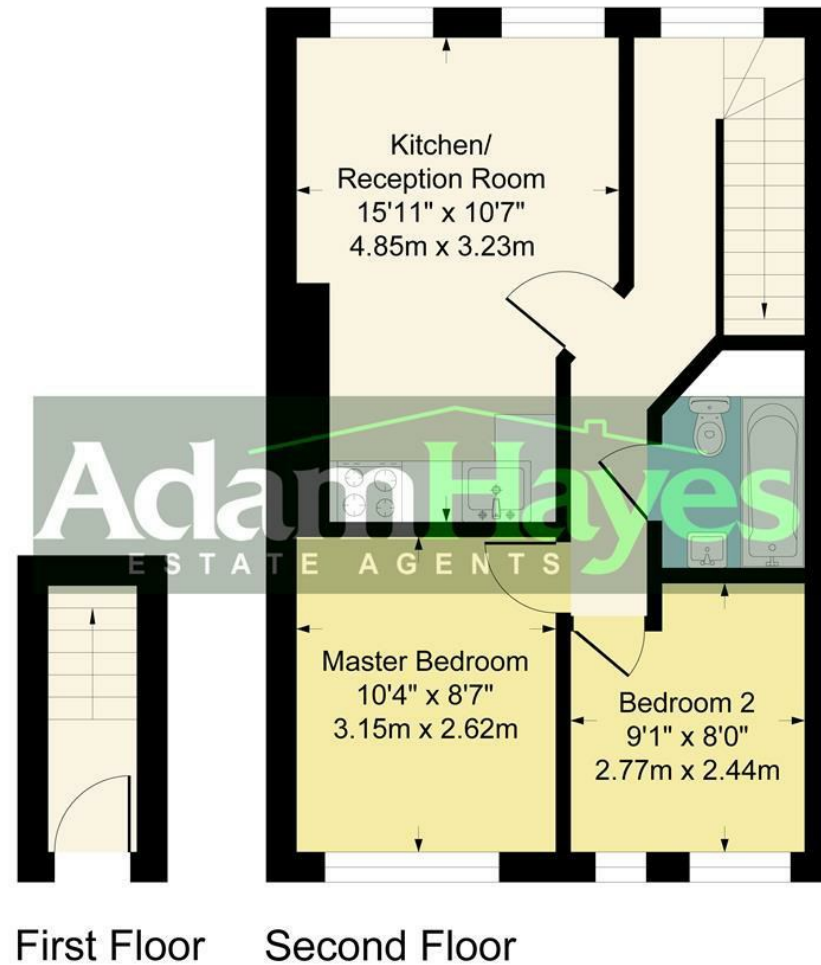

Although every attempt has been made to ensure accuracy, all measurements are approximate.
This floorplan is for illustrative purposes only and not to scale.
Measured in accordance with RICS Standards.

These particulars, whilst believed to be accurate, are set out as a general outline only for guidance and do not constitute any part of an offer or contract. Intending purchasers or prospective tenants should not rely on them as statements or representation of fact, but must satisfy themselves by inspection or otherwise as to their accuracy. We have not carried out a detailed survey, not tested the services, appliances and specific fittings. Room sizes should not be relied upon for carpets and furnishings. The measurements given are approximate. No person in this firm's employment has the authority to make or give any representation or warranty in respect of the property.